



## INSTALLATION INSTRUCTIONS

# Nissan® Titan® Sport Bar Kit



#### PRODUCT INCLUDES:

- (4) NISMO by RIGID 6" 360-Series Lights
- (4) NISMO by RIGID 6" 360-Series Light Covers
- (1) Titan Sport Rack Wiring Harness
- (1) Dash Switch and Controller
- Mounting Brackets and Hardware

\*Required Item Not Included - Nissan  
Accessory Service Connector Part Number  
#T99F6-4RA0A

**Part Number #999F4-AXTTN**  
**Titan Sport Bar Light Kit**

### IMPORTANT

**THANK YOU FOR PURCHASING NISMO® PRODUCTS FOR YOUR VEHICLE.** Please read through all of these Instructions and tips before proceeding with the installation. We do our best to provide a simple installation process for all applications however a professional installation is always recommended.

This lighting kit is designed for off-road use only and operation on public streets or highways may violate the law.

**Always disconnect any power sources connected to your vehicle, including negative battery terminal before servicing fuses or electrical systems.**

# WIRING OVERVIEW PICTURES

Top view of harness routing:

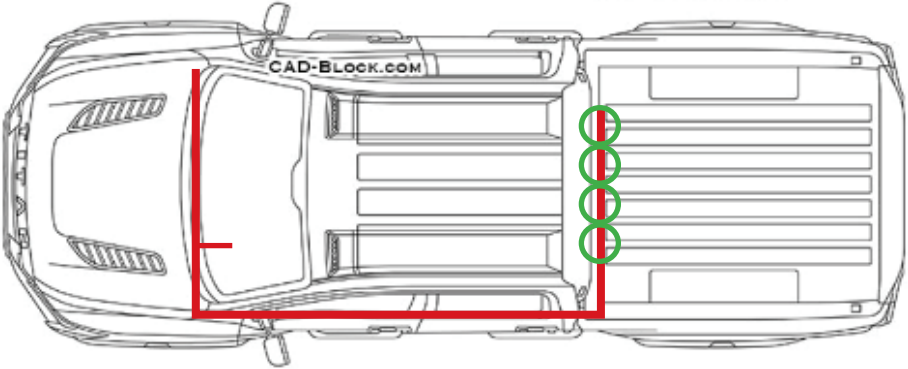

Side view of harness routing:

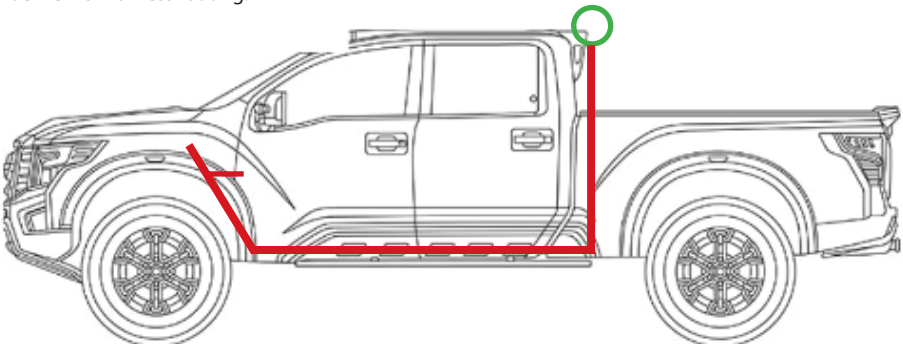

Rear view of harness routing:

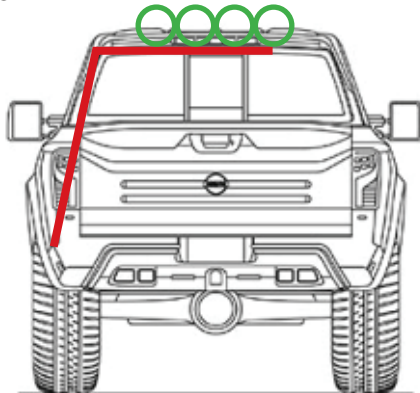

# WIRE HARNESS

## STEP 1

Under the hood of the truck secure the relay on the driver's side near the brake fluid reservoir.

See Figure 1

FIGURE 1



## STEP 2

Run the battery terminal end of the harness across the engine bay above the split tubing. Zip tie in place.

See Figure 2

FIGURE 2



## STEP 3

Place the battery terminal ends near the battery. **Caution: Do not connect to the battery until installation is complete.**

## STEP 4

Feed the longest harness section from the relay straight down through the engine bay to the driver's side frame of the vehicle.

See Figure 4

FIGURE 4

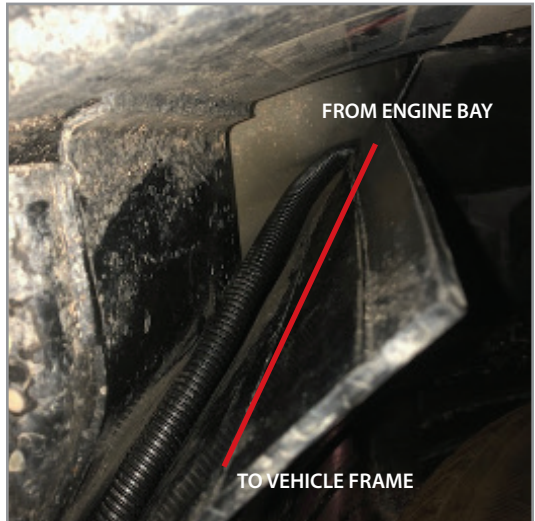

## STEP 5

Run the harness along the top of the driver's side frame following along the existing vehicle wiring harness where possible. Secure the harness every 200mm with zip ties. See Figure 5

Fish the harness up the interior of the truck bed and into the sport rack.

FIGURE 5



## STEP 6

Pull the leads of the wire harness through the corresponding openings of the sport rack.

See Figure 6

FIGURE 6



## SWITCH INSTALL

### STEP 7

Lean the knee bolster forward for easy access to the switch panels.

Pop out the blank switch in your desired location

See Figures 7.1 and 7.2

FIGURE 7.1

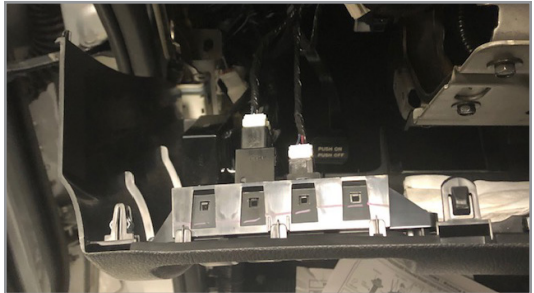

FIGURE 7.2



## SWITCH WIRING

**Note, the Accessory Service Connector is not included in this kit. If it is not included in the vehicle, refer to Nissan Part No. T99F6-4RA0A.**

### STEP 8

From the engine bay, feed the switch terminal end of the harness through the wire seal into the truck cab. Route the wire harness through the cable cover underneath the dash on the driver side.

### STEP 9

Use the provided red butt splice connectors to wire the switch. Connect the switch connector to the light harness by connecting the following: red to red, black to black, and green to blue.

Locate the driver side accessory service connector plug. Connect the following: blue switch connector wire to the purple accessory service connector wire.

Connect the white light harness wire to the orange accessory service wire (**Connecting the white wire to the accessory service connector will power on the 360-Series backlight with ignition of the vehicle**)

Switch Connector	Accessory Service Connector	Light Bar Harness
Red		Red
Black		Black
Green		Blue
	Orange	White
Blue	Purple	

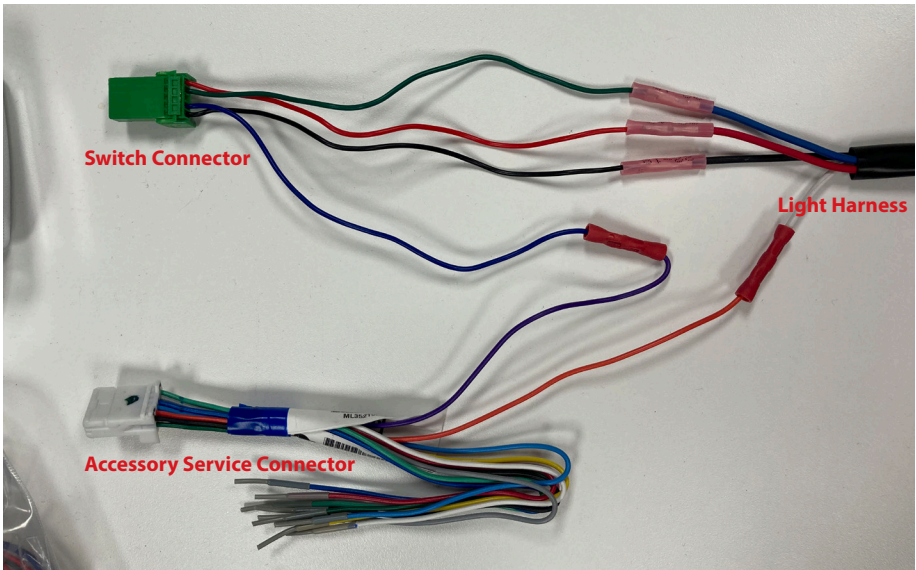

### STEP 10

Press the switch connector into the switch. Press the switch into the blank switch location from the rear of the knee bolster until it snaps into place. Plug Accessory Service Connector into driver side accessory connector plug, then secure wiring harness with zip-ties and reinstall knee bolster.

# Mounting Lights

## STEP 11

Attach the 360-Series lights to the included mounts.

Mount the 360-Series lights to the sport rack in the desired position

Feed the light cables through the pre-drilled holes and connect to the wire harness. Tie black-black, red-red, and white-white with the included blue butt splice connectors.

Snap the NISMO by RIGID covers in place on the lights.

**Note - for street legal compliance, the light covers must remain on while driving.**

## 6" 360-SERIES ASSEMBLY DIAGRAM

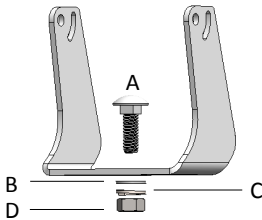
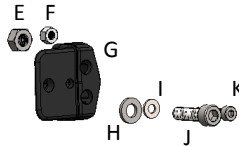

A	M8x25mm Carriage Bolt	Place through bracket
B	M8 Flat Washer	Place on carriage bolt
C	M8 Lock Washer	Place on carriage bolt
D	M8 Nut	Tighten light to bracket
E	M6 Ny Lock Nut	Place in Heatsink
F	M4 Ny Lock Nut	Place into mounting bushing
G	Mounting Bushing	Slide into Heatsink
H	M6 Flat Washer	Place on J prior to install
I	M4 Flat Washer	Place on K prior to install
J	M6x22mm Socket Head	Tighten bracket to the light (Torque 32in-lbs)
K	M4x22mm Socket Head	Tighten the bracket to the light (Torque 9in-lbs)

**Your installation is now complete.**

## WARRANTY INFORMATION

For warranty information, visit [www.rigidindustries.com/about/warranty](http://www.rigidindustries.com/about/warranty)

779 N Colorado St, Gilbert, AZ 85233 • 855-760-5337

[www.rigidindustries.com](http://www.rigidindustries.com)

RIGID and Rigid Industries are registered and/or common law marks owned by JST Performance, LLC, a Delaware limited liability company d/b/a Rigid Industries.

11-13741-A