

## **Z1 Motorsports Akebono 14" BBK Wheel Template - D40 Front**

Use this template to measure fitment of the Z1 Motorsports Akebono BBK in your wheels.

1. Print this PDF in a 100% scale. Use a ruler or set of calipers to check the 1:1 rule square on the right to ensure fitment. Scale your print properties if needed.
2. Cut as indicated along the solid line tracing the profile. Tracing and then cutting along a cardstock or cardboard is recommended.
3. Remove the wheel to be tested. Using the included annotations, insert the hub centric portion of the template into the corresponding center of the wheel and spin a sweep about the inside of the wheel. The template should NOT contact the wheel at any point, and it is recommended that a two millimeter clearance be considered to ensure proper fitment.

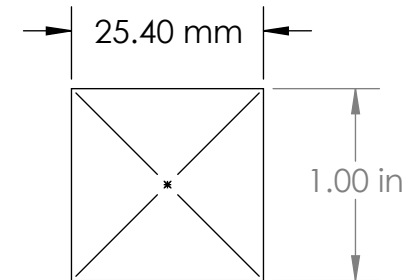

**PROPRIETARY AND  
CONFIDENTIAL**

THE INFORMATION CONTAINED  
IN THIS DRAWING MAY NOT, IN  
WHOLE OR IN PART, BE  
REPRODUCED OR USED FOR  
MANUFACTURE WITHOUT THE  
WRITTEN PERMISSION OF  
**Z1 MOTORSPORTS**.

**TOLERANCES**

UNLESS OTHERWISE SPECIFIED

$\pm 1.00\text{mm}$  HOLE  $\pm 0.254\text{mm}$   
 $.0 \pm 0.508\text{mm}$  ANGLE  $\pm 1^\circ$   
 $.00 \pm 0.254\text{mm}$   
 $.000 \pm 0.127\text{mm}$

DIMENSIONS IN  
MILLIMETERS

TITLE:

D40 AKEBONO WHEEL  
TEMPLATE, 6X14.3  
LUG PATTERN

NOT TO SCALE

SHEET 1 OF 1



2877 Carrollton Villa Rica Hwy, Carrollton, GA 30116  
 Ph. 770-838-7777 Fax: 770-832-9253  
[www.z1motorsports.com](http://www.z1motorsports.com)

DWG. # 20021-A-TEMP

REV **C**