

Z1 Motorsports Akebono 14" BBK Wheel Template - D40 Front

Use this template to measure fitment of the Z1 Motorsports Akebono BBK in your wheels.

1. Print this PDF in a 100% scale. Use a ruler or set of calipers to check the 1:1 rule square on the right to ensure fitment. Scale your print properties if needed.
2. Cut as indicated along the solid line tracing the profile. Tracing and then cutting along a cardstock or cardboard is recommended.
3. Remove the wheel to be tested. Using the included annotations, insert the hub centric portion of the template into the corresponding center of the wheel and spin a sweep about the inside of the wheel. The template should NOT contact the wheel at any point, and it is recommended that a two millimeter clearance be considered to ensure proper fitment.

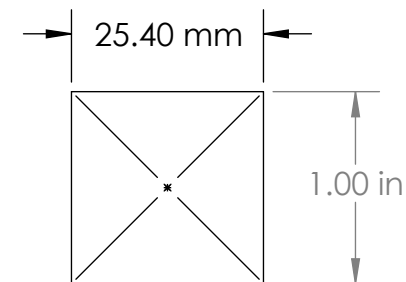

<p>PROPRIETARY AND CONFIDENTIAL</p> <p>THE INFORMATION CONTAINED IN THIS DRAWING MAY NOT, IN WHOLE OR IN PART, BE REPRODUCED OR USED FOR MANUFACTURE WITHOUT THE WRITTEN PERMISSION OF Z1 MOTORSPORTS.</p>	<p>TOLERANCES UNLESS OTHERWISE SPECIFIED</p> <p>± 1.00mm HOLE ± 0.254mm .0 ± 0.508mm ANGLE ± 1° .00 ± 0.254mm .000 ± 0.127mm</p>	<p>TITLE: D40 AKEBONO WHEEL TEMPLATE, 6X139 LUG PATTERN</p>		<p>Z1</p> <p>2877 Carrollton Villa Rica Hwy, Carrollton, GA 30116 Ph. 770-838-7777 Fax: 770-832-9253 www.z1motorsports.com</p>	
	<p>DIMENSIONS IN MILLIMETERS</p>	<p>NOT TO SCALE</p>	<p>SHEET 1 OF 1</p>		