



2877 Carrollton Villa Rica Hwy  
Carrollton, GA 30116

770.838.7777  
z1motorsports.com

# Z1 350Z / G35 (HR) AIR INTAKE UPGRADE KIT INSTALLATION MANUAL



This Installation Manual is intended for the following models:

2007-2008	Nissan 350Z
2007-2008	Infiniti G35 Sedan

## PROLOGUE:

Study these instructions completely before proceeding to assembly. The installer must have a thorough knowledge of automotive systems operation. If unfamiliar with any of the concepts outlined in this instruction, we recommend the installation be completed by a qualified professional.

## WARNING!

Extreme caution should be taken when performing maintenance or performance upgrades to your vehicle. Please observe and abide by any Warning or Caution labels placed on the various components and tools used when servicing your vehicle. If you have any questions regarding installation or the various components included with the Z1 Motorsports 350Z / G35 (HR) Air Intake Upgrade Kit, consult with a Professional Mechanic or contact Z1 Motorsports for more information.

**PRODUCT OPTIONS:**

**SILICONE COUPLERS:**

Black  
Red  
Blue



Item	Description	Quantity
1	Pop Charger Filter Element with Clamp	2
2	Velocity Stack with Hardware	2
3	3.0" Velocity Stack Upgrade Adaptor	2
<b>Z1 Upgrade Kit</b>		
Item	Description	Quantity
4	Hose Clamp, 3"	2
5	Hose Clamp, 2.5"	2
6	Silicone Reducer, 3"	2
<b>Stillen Upgrade Kit</b>		
Item	Description	Quantity
4	Hose Clamp, 3"	4
5	Silicone Coupler, 3"	2

## **TOOLS REQUIRED:**

- Hydraulic Jack
- (2) 2-Ton (or greater) Jack Stands
- Wheel Chock
- Flat-head Screwdriver
- Gloves
- Silicone Spray
- Ratchet
- Ratchet Extension(s)
- 10mm Socket
- 14mm Socket
- 8mm Nut Driver

## **SAFETY REQUIREMENTS:**

- Always wear safety glasses and any necessary protective garments. If using any fluids, chemicals, or solvents, a respirator is recommended.
- Always use properly rated jack stands when working under your vehicle.
- Always keep limbs and parts away from moving drivetrain parts.
- Only operate drivetrain in safe space and well-ventilated areas.

## **BEFORE YOU BEGIN:**

Remove contents from the Z1 Motorsports 350Z / G35 (HR) Air Intake Upgrade Kit and verify that ALL necessary hardware is present.

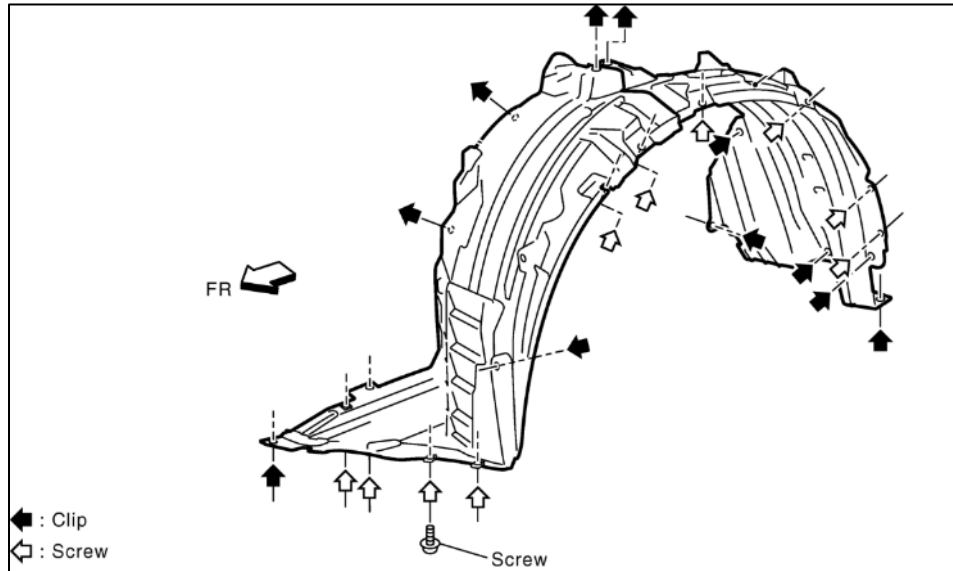
## **PROCEDURE:**

1. Place the transmission in Park position (or in Reverse gear if equipped with a manual transmission). Apply the parking brake.
2. Loosen but do not remove the lug nuts on the front wheels.
3. Locate proper jacking points on the vehicle's chassis (refer to vehicle's Owner Manual). Raise and support vehicle using jack and jack stands.
4. Remove the front wheels.
5. Raise and support the hood of the vehicle.
6. Remove the Undershroud from the vehicle if applicable and set aside. *Figure 1.*



*Figure 1*

7. Remove plastic clips and remove the Front Fender/Fender Liners to reveal a mounting screw on each side of the vehicle which mounts the corner of the Bumper Fascia to the vehicle. Remove each Mounting Screw.  
*Figure 2.*

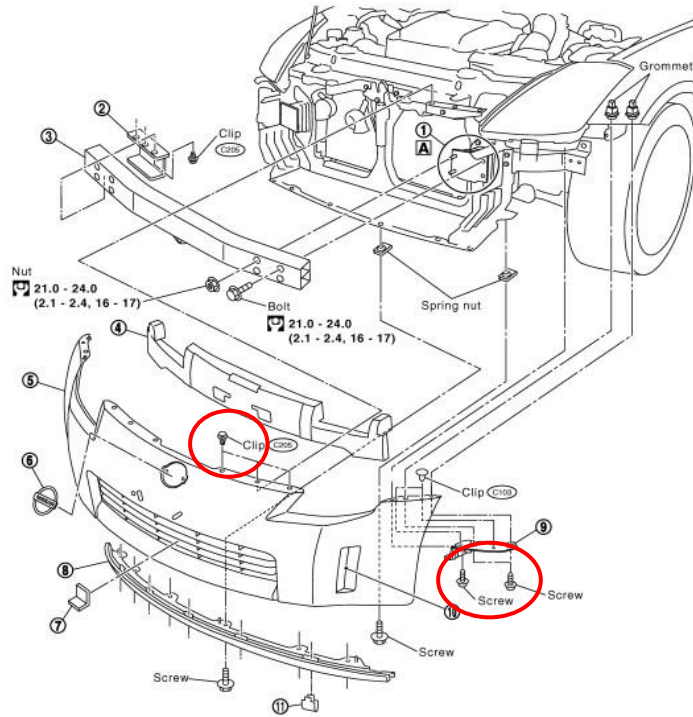


*Figure 2*

8. **G35 MODELS:** Disconnect the Front Bumper Side Marker Harnesses.

**NOTE:** Refer to *Figure 3* below for locations of Bumper mounting hardware and Core Support Clips for applicable models.

350Z



G35 Coupe

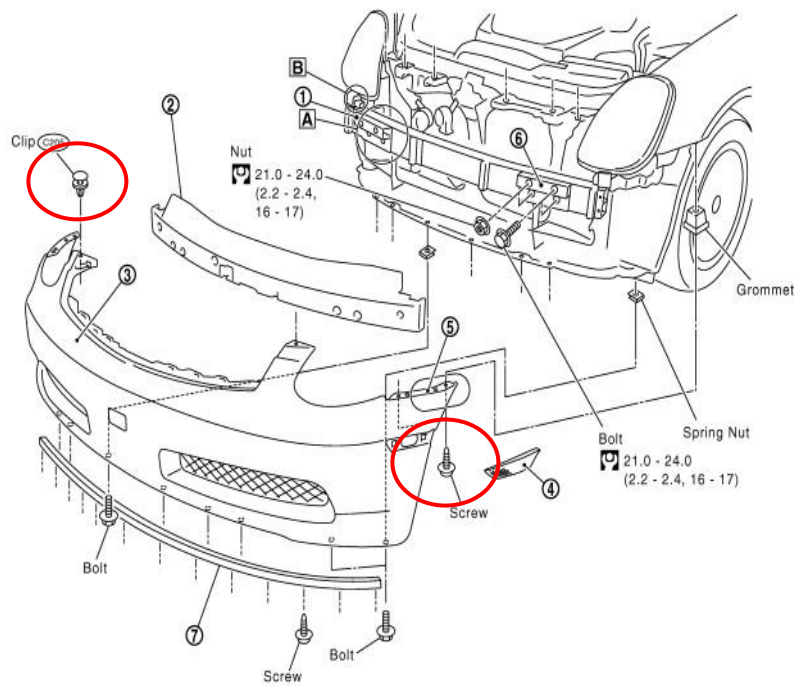


Figure 3

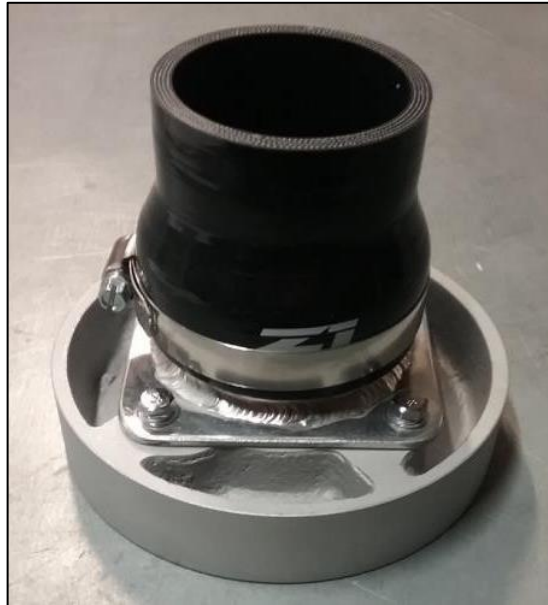
9. Remove plastic pop clips securing the upper Bumper Fascia to the vehicle at the Radiator Core Support. *Figure 3.*
  10. With a light pull motion, carefully disengage the Bumper Fascia from the clips on the vehicle just below the headlight. Remove Bumper Fascia and set aside.
  11. Remove the Air Filters from your existing Intake Kit.
  12. Remove the Foam Impact Absorber in front of the Crash Bar. *Figure 3.*
  13. Remove the (4) four bolts and (4) four hex nuts securing the Front Crash Bar to the chassis, retain the hardware as it will be reused. Remove Crash Bar. *Figure 3.*
  14. Install the modified Crash Bar onto the vehicle using the OE Hardware removed in *Step 13*. Optionally you can replace your OE Crash Bar with a [Z1 Bash Bar](#).
- NOTE:** See images provided at the end of the manual for specifications on how to modify the OEM Front Crash Bar. Z1 also offers a modification service with a 10-day lead time. **DO NOT** drive your vehicle without a front crash bar.
15. Locate the Z1 Air Intake Upgrade Kit components. Place the Z1 Velocity Stack onto the 3" Coupler Adapter. Install (4) four 10mm bolts through the Adaptor and thread them into the Velocity Stack. *Figure 4.*



*Figure 4*

16. Slide the Silicone Coupler/Reducer and a Hose Clamp over the Velocity Stack Adaptor and tighten the Clamp. *Figure 5.*

**NOTE:** Use of Silicone Spray can help installation of all Silicone Components.



*Figure 5*

17. Slide the Z1 Air Filter with a Large Hose Clamp over the Velocity Stack and tighten the Hose Clamp. *Figure 6.*



*Figure 6*

18. Slide coupler/reducer and clamp of the velocity stack assembly over the existing air intake kit opening.

19. Repeat Steps 15-18 for the opposite side Air Filter Assembly.



Completed assembly of Z1 350Z / G35 Air Intake Upgrade Kit should look as shown:

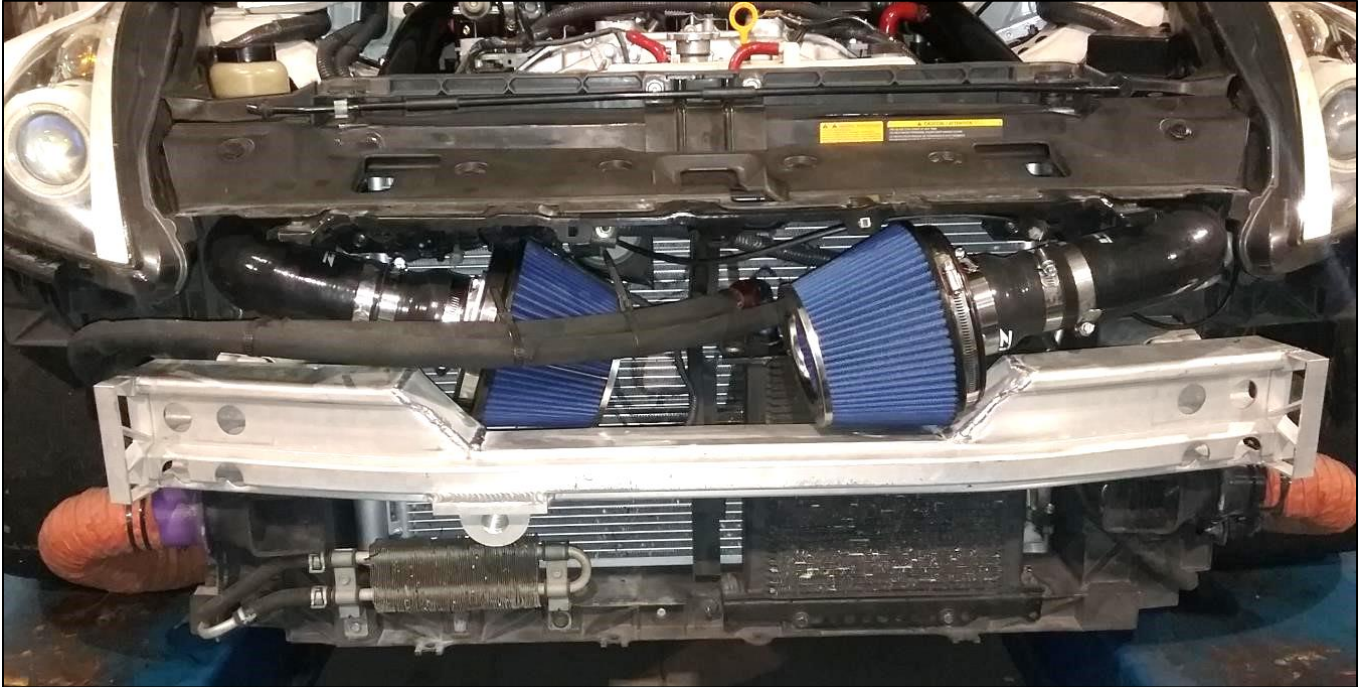


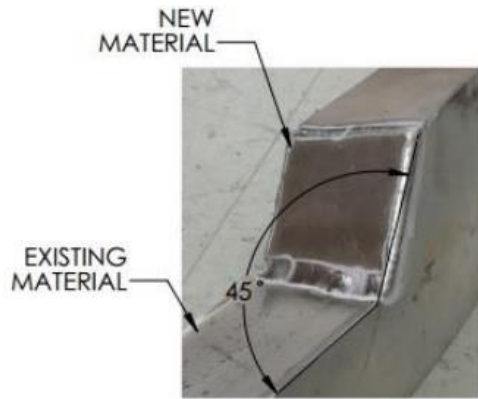
Figure 7

20. Start the vehicle. While at idle, check for leaks or faulty operation of the Air Intake Kit.
21. Follow *Steps 6-10* in reverse order to reinstall the Front Bumper.
22. Locate the C.A.R.B. Exemption Sticker. The sticker must be readily visible under the hood in order for an Emissions Inspector to easily see it when the vehicle is required to be tested for emissions. It is **NOT** recommended to affix the label to any equipment that is easily removable from the vehicle. Select a suitable location (Strut Tower, underside of hood, Radiator Shroud, Core Support, etc.). Clean the area to remove all debris and dust and apply the sticker to vehicle. *Figure 8*

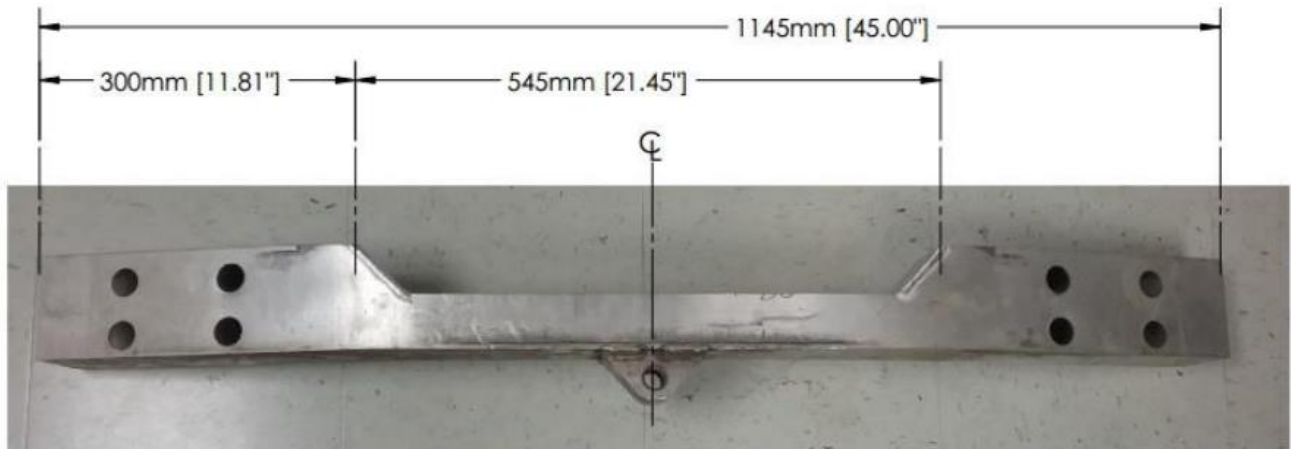


Figure 8

## 350Z Crash Bar Modification Specifications



WELDING DETAIL



**END**

**Additional Technical Support:**  
Contact Z1 Motorsports at [info@Z1motorsports.com](mailto:info@Z1motorsports.com)  
Or call 770-838-7777 between 9am and 6pm ET