

Z1 M-SPEC 350Z COLD AIR INTAKE KIT - RACE INSTALLATION MANUAL



This Installation Manual is intended for the following models:

2003-2006

Nissan 350Z

PROLOGUE:

Study these instructions completely before proceeding to assembly. The installer must have a thorough knowledge of automotive systems operation. If unfamiliar with any of the concepts outlined in this instruction, we recommend the installation be completed by a qualified professional.

WARNING!

Extreme caution should be taken when performing maintenance or performance upgrades to your vehicle. Please observe and abide by any Warning or Caution labels placed on the various components and tools used when servicing your vehicle. If you have any questions regarding installation or the various components included with the Z1 Motorsports M-Spec 350Z Cold Air Intake Kit - Race, consult with a Professional Mechanic or contact Z1 Motorsports for more information.

PARTS INCLUDED:

Item	Quantity	Description
1	1	3" Angled Air Intake Pipe
2	1	3" Curved Air Intake Pipe
3	1	45° 3" Silicone Coupler
4	1	Straight 3" Silicone Coupler
5	1	M6-1.0 x 15mm Flanged Hex Bolt
6	4	3" Hose Clamp
7	1	K&N Reusable Air Filter with Clamp

TOOLS REQUIRED:

- Hydraulic Jack
- (2) 2-Ton (or greater) Jack Stands
- Wheel Chock
- Flat-head Screwdriver
- Phillips-head Screwdriver
- Ratchet
- Ratchet Extension(s)
- 8mm Socket
- 10mm Socket
- 14mm Deep-well Socket
- M4 Allen-head Bit
- T20 Anti-tamper Torx Bit
- Pliers

SAFETY REQUIREMENTS:

- Always wear safety glasses and any necessary protective garments. If using any fluids, chemicals, or solvents, a respirator is recommended.
- Always use properly rated jack stands when working under your vehicle.
- Always keep limbs and parts away from moving drivetrain parts.
- Only operate drivetrain in safe space and well-ventilated areas.

BEFORE YOU BEGIN:

Remove contents from the Z1 Motorsports M-Spec 350Z Cold Air Intake Kit – Race and verify that ALL necessary hardware is present.

Installation Note: Due to an enlarged MAF Sensor cross-section, this Air Intake Kit requires an ECU Tune. Do NOT operate your vehicle without performing an ECU tune immediately after installation.

PROCEDURE:

1. Assure the car's ignition is in the OFF position and the NEGATIVE (-) battery terminal is disconnected.
2. Place the transmission in Park position (or in Reverse gear if equipped with a manual transmission). Apply the parking brake and place wheel chock on backside of rear tire.
3. Locate proper jacking points on vehicle's chassis (refer to vehicle's Owner Manual). Raise and support vehicle using jack & jack stands.
4. Unlatch and raise vehicle's hood. Apply hood prop.

Use the diagram below as reference for the following steps:

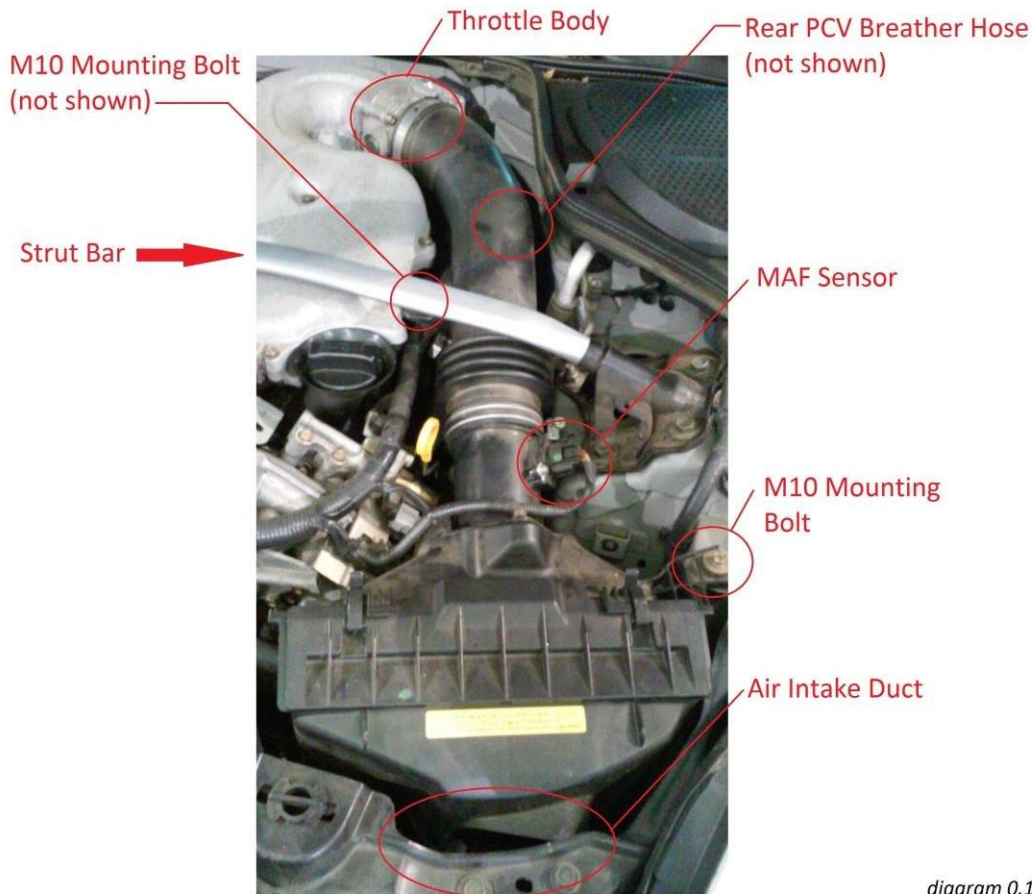

diagram 0.1

5. Locate and unplug MAF harness and plastic harness clips.
6. Remove (6) bolts and (2) hex nuts which attach strut bar to vehicle.
Note: Loosen vehicle's electrical harness clips at each side.
7. Loosen OEM throttle body clamp.
8. Remove bolt which mounts factory air intake box to engine plenum.
9. Remove bolt which mounts the factory air intake box to vehicle.
Note: Retain this bolt, as it will be reinstalled.
10. Using pliers, pinch open & slide OEM hose clamp from nipple of factory air intake box. Disconnect rear PCV breather hose.
11. Using a flat-head screwdriver, remove plastic clips from air intake duct and pull out from factory air intake box.
12. Using a light pull motion, remove factory air intake box as an assembly from vehicle.
13. Remove (2) bolts which mount MAF sensor to factory air intake assembly. Transfer sensor and bolts to MAF sensor mounting boss of 3" angled air intake pipe.

Note: Due to various Nissan year model changes, you may need an Allen-head or anti-tamper Torx bit to remove bolts.

Note: Be sure to install MAF sensor onto angled air intake pipe facing the same direction removed from factory air intake box.

14. Place 45° silicone coupler onto throttle body.

Note: Notice that one end of coupler has a larger inside diameter. This end goes onto the throttle body side.

15. Slide (2) hose clamps onto coupler. Tighten (1) clamp to throttle body and the other loosely on the coupler. Orient the coupler so that open end is facing the front of vehicle.

16. Locate 3" angled air intake pipe. Slide rear PCV breather hose onto nipple of pipe. Using pliers, pinch open and slide OEM hose clamp over nipple. Release pliers, clamping the hose onto nipple.

17. Insert 3" angled air intake pipe into 45° silicone coupler.

18. Orient angled air intake pipe so its mounting bracket is aligned with the OEM mounting hole on vehicle body.

19. Insert OEM bolt through angled air intake pipe mounting bracket and into the vehicle body, but do not tighten.

20. Slide loose hose clamp located on the 45° silicone coupler over angled air intake pipe.

21. Relieve stress from coupler, pipe, and mounting bracket. Tighten hose clamp at angled pipe. Tighten bolt at vehicle body.

22. Plug harness onto MAF sensor.

Use the diagram below as reference for the following steps:

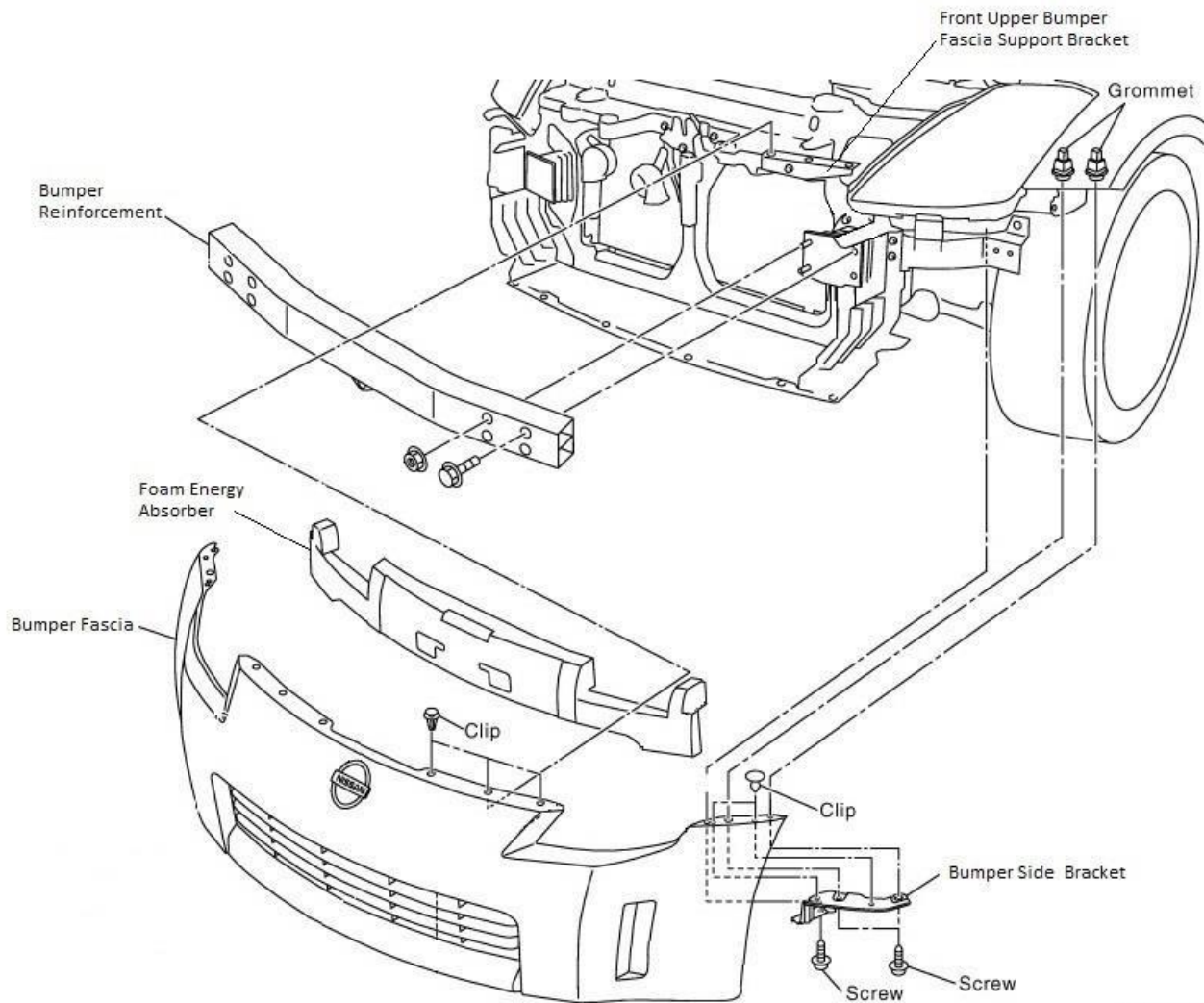

diagram 0.2

23. Remove (6) body clips from front bumper fascia.

24. Peel back front wheel liner with flat-head screwdriver and remove (2) screws which mount front bumper fascia to the vehicle's bumper side bracket.

Note: Turn wheels of vehicle to the inside of the side you are working on for increased accessibility.

25. Repeat step #24 to opposite side of vehicle.

26. Remove (6) 10mm bolts and (4) clips which mount front bumper fascia with vehicle undertray.

27. Carefully pull front bumper fascia off from vehicle.



28. Remove driver side front upper bumper fascia support bracket from vehicle, as it will interfere with the installation of 3" curved air intake pipe.
29. Place straight silicone coupler through the front radiator core support and onto the 3" angled air intake pipe. Slide (2) hose clamps onto coupler. Tighten (1) clamp to angled pipe, and the other loosely on the coupler.
30. Slide curved air intake pipe into straight silicone coupler. Slide loose clamp over coupler.
31. Route K&N reusable air filter from under the front bumper reinforcement and onto the open end of the curved air intake pipe. Tighten clamp supplied with air filter.
32. Align curved air intake pipe mounting bracket with vehicle threads on front radiator core support. Insert m6-1.0 x 15mm flanged hex bolt, through curved air intake pipe mounting bracket and into vehicle mounting threads, but do not tighten.
33. Relieve stress from coupler, pipe, and mounting bracket. Tighten curved air intake pipe mounting bracket bolt. Tighten clamp to curved air intake pipe.
34. Follow steps #23 through 28 in reverse order to reinstall front bumper fascia.
35. Under step #6 to reinstall strut bar.
36. Properly lower vehicle from jack stands.
37. Inspect vehicle for loose tools/items
38. Start vehicle. While at idle, check for leaks or faulty operation of air intake kit.
39. Lower hood of vehicle.
40. Perform an ECU tune immediately after installation.
41. Perform a final test drive of vehicle.

Completed assembly of Z1 M-Spec 350Z Cold Air Intake Kit – Race should look as shown:



END

Additional Technical Support:

Contact Z1 Motorsports at info@z1motorsports.com
Or call 770-838-7777 between 9am and 6pm ET