



2877 Carrollton Villa Rica Hwy
Carrollton, GA 30116

770.838.7777
z1motorsports.com

Z1 M-SPEC 350Z AIR INTAKE KIT - STREET INSTALLATION MANUAL



This Installation Manual is intended for the following models:

2003-2006

Nissan 350Z

PROLOGUE:

Study these instructions completely before proceeding to assembly. The installer must have a thorough knowledge of automotive systems operation. If unfamiliar with any of the concepts outlined in this instruction, we recommend the installation be completed by a qualified professional.

WARNING!

Extreme caution should be taken when performing maintenance or performance upgrades to your vehicle. Please observe and abide by any Warning or Caution labels placed on the various components and tools used when servicing your vehicle. If you have any questions regarding installation or the various components included with the Z1 Motorsports M-Spec 350Z Air Intake Kit - Street, consult with a Professional Mechanic, or contact Z1 Motorsports for more information.

PRODUCT OPTIONS:

INTAKE OPTIONS:



Polished
Black

SILICONE COUPLER OPTIONS:



Black
Red
Blue

PARTS INCLUDED:

Item	Quantity	Description
1	1	3" Angled Air Intake Pipe
2	1	3" Curved Air Intake Pipe
3	1	45° 3" Silicone Coupler
4	1	Straight 3" Silicone Coupler
5	1	M6 x 1.0 Flanged Hex Head Bolt, 15mm
6	4	3" Hose Clamp
7	1	Reusable Air Filter with Clamp

TOOLS REQUIRED:

- Hydraulic Jack
- (2) 2-Ton (or greater) Jack Stands
- Ratchet
- Ratchet Extension(s)
- Assorted Metric Wrenches
- Assorted Metric Sockets
- Torque Wrench
- Pliers
- Allen/Hex Keys
- Torx Bits

SAFETY REQUIREMENTS:

- Always wear safety glasses and any necessary protective garments. If using any fluids, chemicals, or solvents, a respirator is recommended.
- Always turn the ignition to the OFF position and disconnect the NEGATIVE battery terminal.
- Always use properly rated jack stands when working under your vehicle.
- Always keep limbs and parts away from moving drivetrain parts.
- Only operate drivetrain in safe space and well-ventilated areas.

BEFORE YOU BEGIN:

Remove contents from the Z1 Motorsports M-Spec 350Z Air Intake Kit - Street and verify that ALL necessary hardware is present.

PROCEDURE:

1. Place the transmission in Park position (or in Reverse gear if equipped with a manual transmission). Apply the parking brake.
2. Loosen but do not remove the lug nuts on the front wheels.
3. Locate proper jacking points on the vehicle's chassis (refer to vehicle's Owner Manual). Raise and support vehicle using jack and jack stands.
4. Remove the front wheels.
5. Raise and support the hood of the vehicle.
6. Remove the Undershroud from the vehicle if applicable and set aside. *Figure 1.*



Figure 1

7. Remove plastic clips and remove the Front Fender/Fender Liners to reveal a mounting screw on each side of the vehicle which mounts the corner of the Bumper Fascia to the vehicle. Remove each Mounting Screw. *Figure 2.*

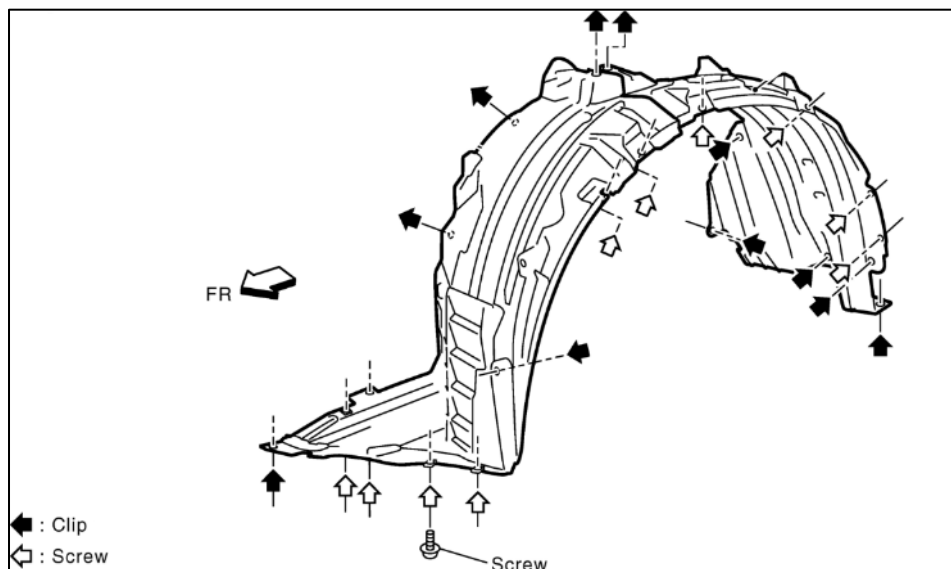

Figure 2

NOTE: Refer to *Figure 3* below for locations of Bumper mounting hardware and Core Support.

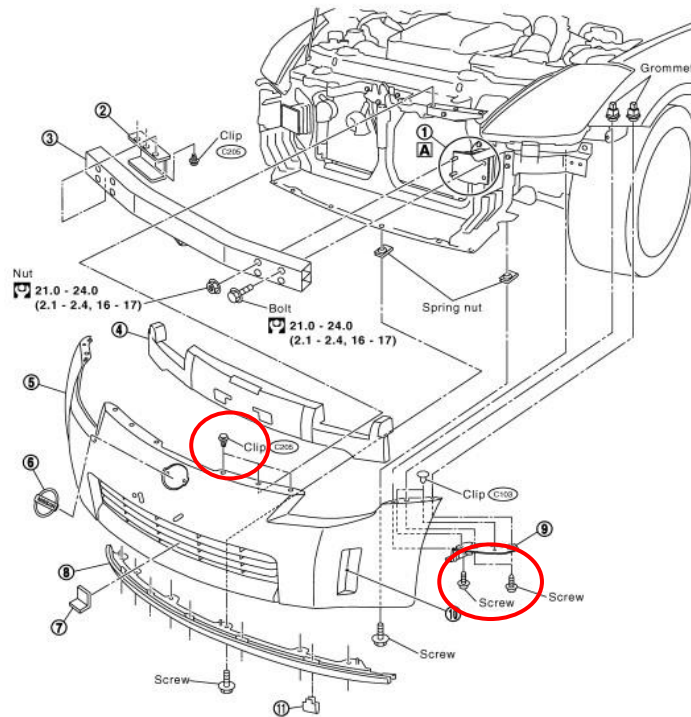

Figure 3

8. Remove plastic pop clips securing the upper Bumper Fascia to the vehicle at the Radiator Core Support.
Figure 3.
9. With a light pull motion, carefully disengage the Bumper Fascia from the clips on the vehicle just below the headlight. Remove Bumper Fascia and set aside.

NOTE: Use *Figure 4* below as a reference for Steps 10-16.

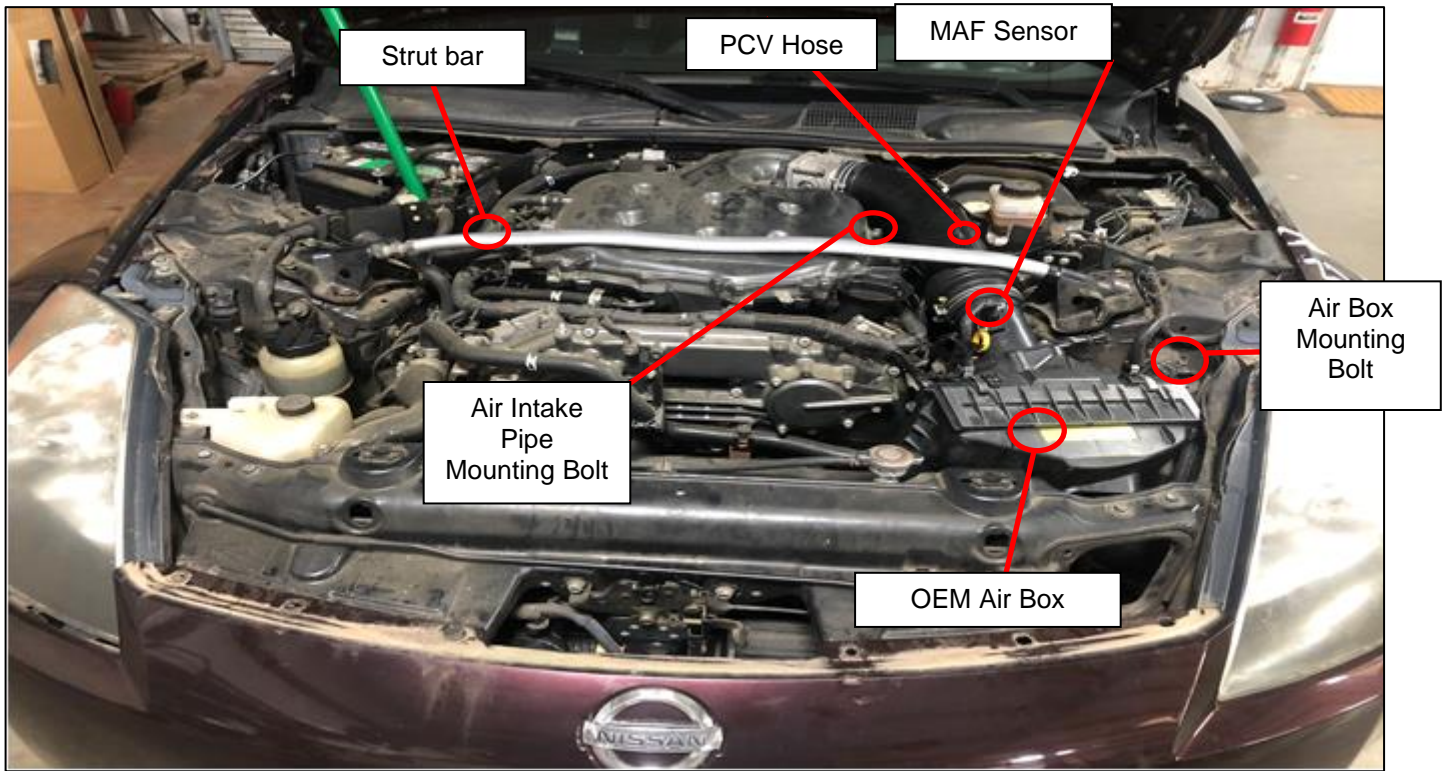

Figure 4

10. Remove the (6) six bolts and (2) two hex nuts which secure the Strut Bar to the chassis. Remove the Strut Bar and set it aside.
11. Unplug the MAF Sensor Connector and loosen the vehicle's electrical harness clips on the passenger side.
Figure 5.

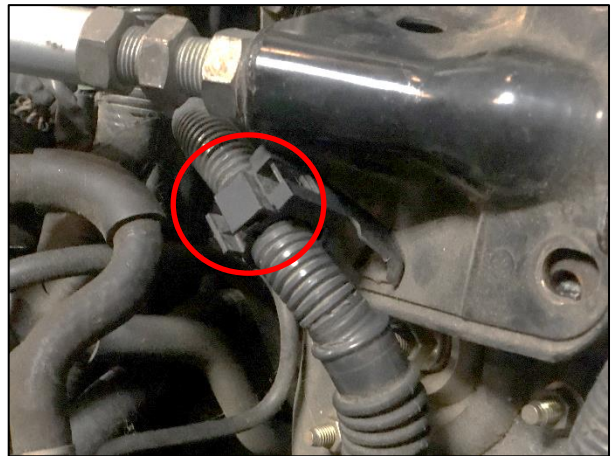

Figure 5

12. Remove the Air Box Mounting Bolt. *Figure 4*
13. Remove the Air Intake Mounting Bolt. Retain this bolt. *Figure 4.*
14. Loosen the Hose Clamp at the Throttle Body.
15. Loosen the Hose Clamp and remove the PCV Hose from the Air Intake Piping.
16. Using a light pull motion, remove the Air Box, MAF Housing, and Air Intake Piping from vehicle as one unit. *Figure 5.*



Figure 6

17. Loosen the Hose Clamp connecting the Air Intake Piping to the MAF Housing.
18. Remove the Air Intake Piping from the Air Box and MAF Housing.
19. Remove the (4) four 10mm bolts connecting the MAF Housing to the Air Box and remove the MAF Housing.

NOTE: Due to various Nissan year model changes, you may need an Allen-Head or Torx Bit to remove the bolts.

20. Transfer the MAF Sensor and bolts to the MAF Sensor Mounting Boss of the 3" Angled Air Intake Pipe.

NOTE: Make sure the MAF Sensor is installed into the Angled Air Intake Pipe facing the same direction removed from Factory Air Intake Box. There is an arrow on the MAF indicating the correct direction of Airflow.

21. Place the 45° Silicone Coupler onto the Throttle Body. The larger end of the Silicone Coupler will be on the Throttle Body Side. Orient the Coupler so the open end is facing the front of the vehicle.
22. Slide (2) two Hose Clamps onto the 45° Silicone Coupler. Loosely tighten the Hose Clamp securing the Coupler to the Throttle Body and leave the other Hose Clamp loose.
23. Locate the 3" Angled Air Intake Pipe. Slide the rear PCV Breather Hose onto the nipple of the Pipe and secure with the OE Hose Clamp.

24. Install the 3" Angled Air Intake Pipe into the 45° Silicone Coupler and loosely secure with the Hose Clamp installed in *Step 22*
25. Orient the Angled Air Intake Pipe so its Mounting Bracket is aligned with the OEM Mounting Hole on the Body of the vehicle.
26. Insert the OEM Removed in *Step 13* through the Angled Air Intake Pipe Mounting Bracket and into the vehicle body, but do not tighten yet.
27. Adjust the Angled Air Intake Pipe and 45° Silicone Coupler as necessary to relieve any stress from the Coupler, Pipe, and Mounting Bracket. Once adjusted, tighten both Hose Clamps and the OE Bolt on the Intake Mounting Bracket.
28. Plug the OE harness into the MAF sensor.
29. Place the Straight Silicone Coupler through the front of the Core Support and onto the 3" Angled Air Intake Pipe. Slide (2) two Hose Clamps onto the Coupler and loosely tighten them.
30. Install the Curved Air Intake Pipe into the Straight Silicone Coupler and loosely secure with the other Hose Clamp installed in *Step 29*.
31. Route the Reusable Air Filter from under the front bumper reinforcement and onto the open end of the Curved Air Intake Pipe. Once positioned, secure the Air Filter with the included Hose Clamp.
32. Align the Curved Air Intake Pipe Mounting Bracket with vehicle threads on the front of the Core Support. Insert M6 x 1.0 Flanged Hex Head Bolt , 15mm, through the Curved Air Intake Pipe Mounting Bracket and into vehicle mounting threads, but do not tighten yet.
33. Adjust the Curved Air Intake Pipe, Coupler, and Air Filter to relieve stress from the Coupler, Pipe, and Mounting Bracket. Once adjusted, tighten the M6 Bolt and all Hose Clamps.
34. Locate the C.A.R.B. Exemption Sticker. The sticker must be readily visible under the hood in order for an Emissions Inspector to easily see it when the vehicle is required to be tested for emissions. It is NOT recommended to affix the label to any equipment that is easily removable from the vehicle. *Figure 7*.



Figure 7

35. Select a suitable location (Strut Tower, underside of Hood, Radiator Shroud, Core Support, etc.). Clean the area to remove all debris and dust, and apply the sticker to the vehicle.
36. Start the vehicle. While at idle, check for leaks or faulty operation of the Air Intake Kit.
37. Follow *Steps* 6-9 in reverse to reinstall the Front Bumper.
38. Properly lower the vehicle from jack stands.

Completed assembly of Z1 M-Spec 350Z Cold Air Intake Kit – Street should look as shown, *Figure 8*:



Figure 8

END

Additional Technical Support:

Contact Z1 Motorsports at info@z1motorsports.com

Or call 770-838-7777 between 9am and 6pm ET