

Z1 OFF-ROAD A60 CATCH CAN KIT INSTALLATION MANUAL



This Installation Manual is intended for the following models:	
2005-2015	Nissan Titan

PROLOGUE:

Study these instructions completely before proceeding to assembly. The installer must have a thorough knowledge of automotive systems operation. If unfamiliar with any of the concepts outlined in this instruction, we recommend the installation be completed by a qualified professional.

WARNING!

Extreme caution should be taken when performing maintenance or performance upgrades to your vehicle. Please observe and abide by any Warning or Caution labels placed on the various components and tools used when servicing your vehicle. If you have any questions regarding installation or the various components included with the Z1 Off-Road A60 Catch Can Kit, consult with a Professional Mechanic or contact Z1 Off-Road for more information.

PARTS INCLUDED:

Item	Quantity	Description
1	1	Assembled Z1 Catch Can
2	1	Catch Can Bracket
3	1	Catch Can Hose Kit – 6 Lines, 2 Tee Junctions
4	2	15mm Billet Spacer
5	2	25mm Billet Spacer
6	2	M6 Countersunk Washer
7	2	M6 x 40mm Screw
8	2	Banjo Fitting Barb
9	2	Banjo Fitting Bolt
10	4	Crush Washer
11	3	M4 x 8mm Screw
12	6	Hose Clamp
13	1	Z1 2.5mm Ball-End Screwdriver

TOOLS REQUIRED:

- Ratchet
- Ratchet Extension(s)
- 10mm Socket/Wrench
- 8mm Allen/Hex Key
- 5mm Allen/Hex Key
- Pliers

SAFETY REQUIREMENTS:

- Always wear safety glasses and any necessary protective garments. If using any fluids, chemicals, or solvents, a respirator is recommended.
- Always use properly rated jack stands when working under your vehicle.
- Always keep limbs and parts away from moving drivetrain parts.
- Always turn the ignition to the OFF position and disconnect the NEGATIVE battery terminal.
- Only operate drivetrain in safe space and well-ventilated areas.

BEFORE YOU BEGIN:

Remove contents from the Z1 Off-Road A60 Catch Can Kit and verify that ALL necessary hardware is present.

PROCEDURE:

1. Place the transmission in Park position (or in Reverse gear if equipped with a manual transmission). Apply the parking brake.
2. Open hood and remove engine cover.

- Remove the (2) OEM PCV hoses going from each valve cover to the intake plenum. Hoses are highlighted in the diagrams below.

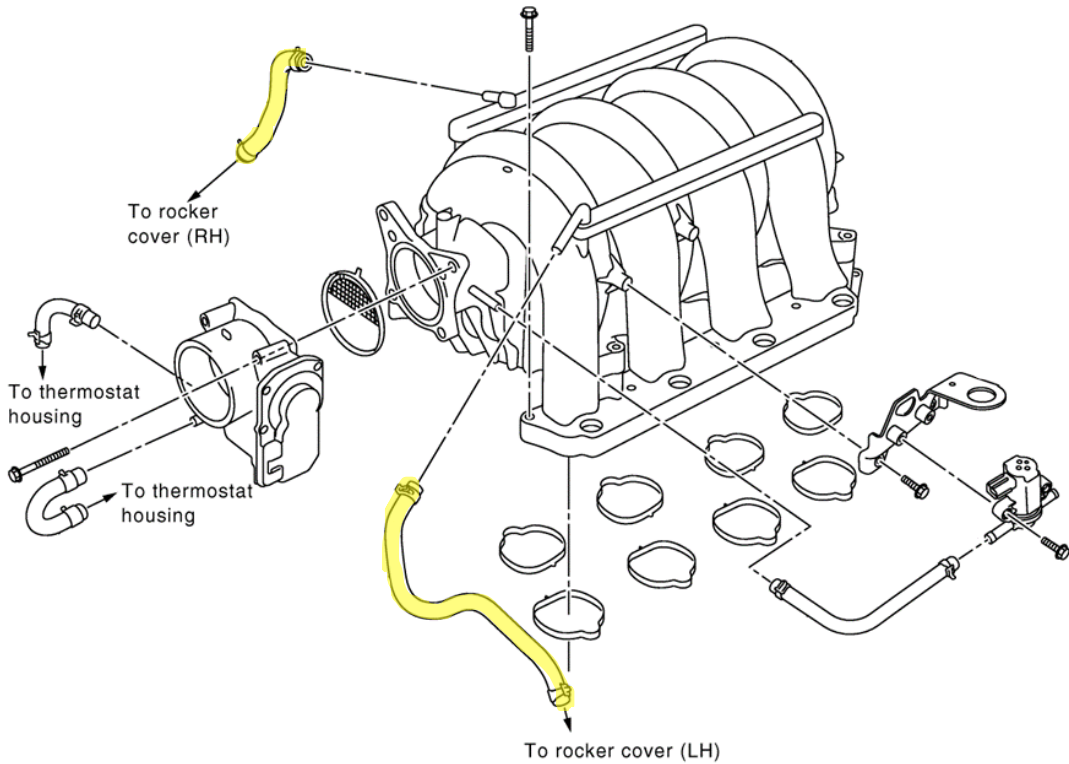

- Locate all (6) silicone hoses and (2) silicone tees.
- Assemble the hoses and tees according to the diagram below, and install them onto the same ports the OEM hoses were removed from in step # 3. The hoses routing from the bottom of the tee's will be attached to the catch can at a later step.

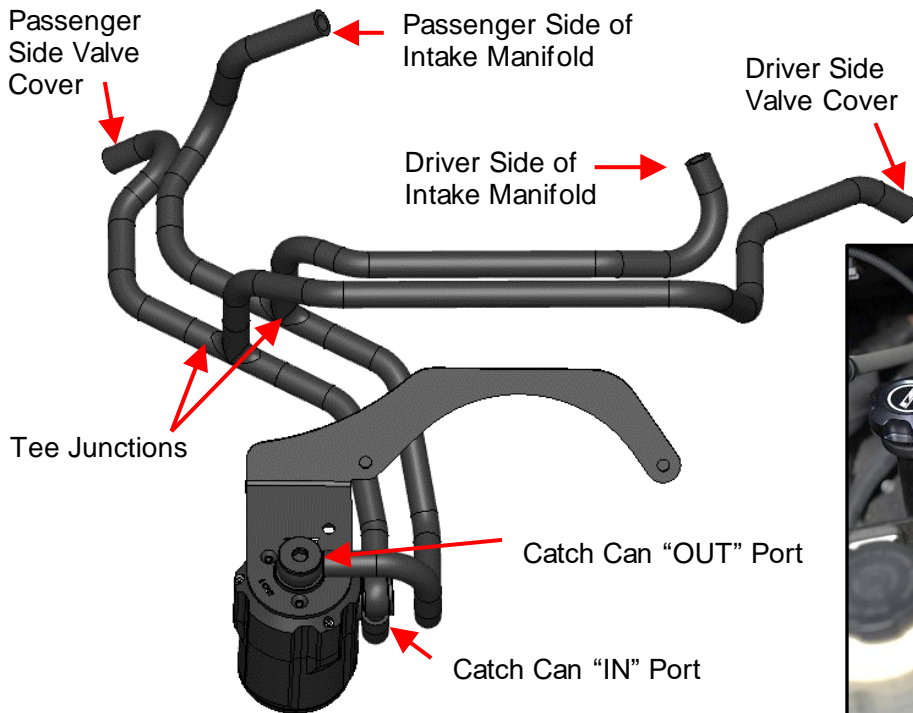

- If equipped, reinstall engine cover.

7. Locate Z1 assembled catch can, catch can bracket, (3) M4 x 8mm screws, (2) banjo fitting barbs, and (2) banjo fitting bolts.
8. Attach the catch can to the bracket with (3) M4 screws, making sure the "IN" port of the catch can is facing the right (as shown below).

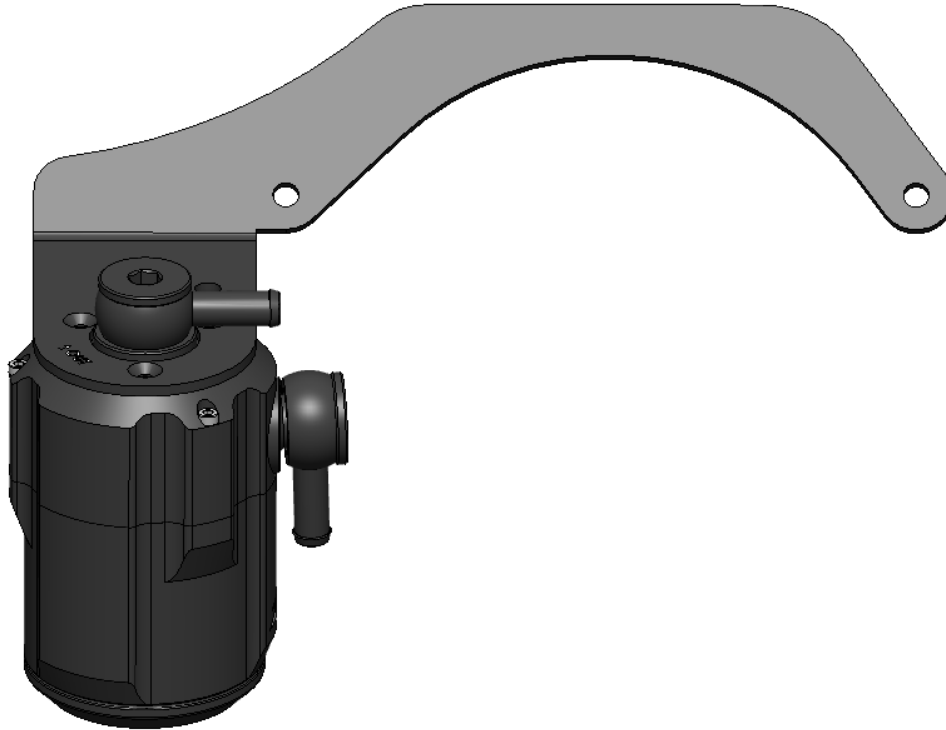

9. Insert a banjo fitting bolt through each banjo barb with a crush washer on both sides. Secure banjo fittings to catch can but do not fully tighten them (as shown above).



10. This kit comes with (2) different size billet spacers. The shorter 15mm spacer should be used if you have an engine cover and plan to reinstall it after the catch can is installed. The longer 25mm spacers should be used if you do have an engine cover. Locate whichever spacers are right for you.

11. Locate (2) M6 x 40mm screws and (2) countersunk washers.

12. Install a washer onto one of the screws and install it into the catch can bracket. Then place a billet spacer on the end of the screw. If you are using an engine cover use the shorter spacer/standoff, if not us the longer.

13. Install the bracket onto the engine cover bracket.

14. Install the other countersunk washer, screw, and billet spacer onto the other side of the bracket.



15. With a clamp on each end, attach hoses coming out of the tee's to the catch can (as shown below).



16. Using an 8mm Allen/hex key, tighten both banjo fitting bolts.
17. Assure all bolts and clamps are securely tightened. Inspect vehicle for loose components or issues.
18. Close hood of vehicle.
19. Perform a final test drive of vehicle.



Drain Instructions

1. While supporting the bottom of the catch can, use the supplied 2.5mm ball-end hex screwdriver to unscrew the 3 outer bolts on the top of the Z1 Oil Catch Can.

Note: **DO NOT** unscrew the (3) bolts securing the top of the catch can to the bracket. The back screw should be accessible through the access hole on the top of the bracket. You may need to loosen the top banjo bolt and rotate the banjo barb out of the way to access the hole.

2. Remove the bottom of the Z1 Oil Catch Can. Properly dispose of oil.
3. Reattach bottom of catch can.

END

Additional Technical Support:
Contact Z1 Off-Road at info@z1offroad.com
Or call 678-839-8019 between 9am and 6pm ET