

# Z1 FAIRLEAD FRONT LICENSE PLATE MOUNT INSTALLATION MANUAL



## PROLOGUE:

Study these instructions completely before proceeding to assembly. The installer must have a thorough knowledge of automotive systems operation. If unfamiliar with any of the concepts outlined in this instruction, we recommend the installation be completed by a qualified professional.

## WARNING!

Extreme caution should be taken when performing maintenance or performance upgrades to your vehicle. Please observe and abide by any Warning or Caution labels placed on the various components and tools used when servicing your vehicle. If you have any questions regarding installation or the various components included with the Z1 Off-Road Fairlead Front License Plate Mount, consult with a Professional Mechanic, or contact Z1 Off-Road for more information.

## **PARTS INCLUDED:**

Item	Quantity	Description
1	1	Bumper Bracket
2	1	License Plate Bracket
3	6	M6 x 1.0 Flanged Button Head Screw, 20mm
4	2	M6 Nylon Plastic Washer
5	2	M6 x 1.0 Locknut
Optional:		
6	2	3/8" Button Head Screw
7	2	3/8" Washer
8	2	3/8" Hex Nut
9	4	M6 x 1.0 Flanged Button Head Screw

## **TOOLS REQUIRED:**

- Ratchet
- Ratchet Extension(s)
- Assorted Metric Sockets

## **SAFETY REQUIREMENTS:**

- Always wear safety glasses and any necessary protective garments. If using any fluids, chemicals, or solvents, a respirator is recommended.
- Always use properly rated jack stands when working under your vehicle.
- Always keep limbs and parts away from moving drivetrain parts.
- Always turn the ignition to the OFF position and disconnect the NEGATIVE battery terminal.
- Only operate drivetrain in safe space and well-ventilated areas.

## **BEFORE YOU BEGIN:**

Remove contents from the Z1 Off-Road Fairlead Front License Plate Mount and verify that ALL necessary hardware is present.

This Product is intended for users with a standard Fairlead installed on their bumper.

## **PROCEDURE:**

1. Place the transmission in Park position (or in Reverse gear if equipped with a manual transmission). Apply the parking brake.
2. Locate the License Plate Bracket, Bumper Bracket, (2) two M6 x 1.0 Flanged Button Head Screws, (2) two Nylon Plastic Washers, and (2) two M6 Locknuts. Place a Washer on each Screw and install it through the License Plate Bracket and Bumper Bracket. Secure with a Locknut on each Screw. *Figure 1.*

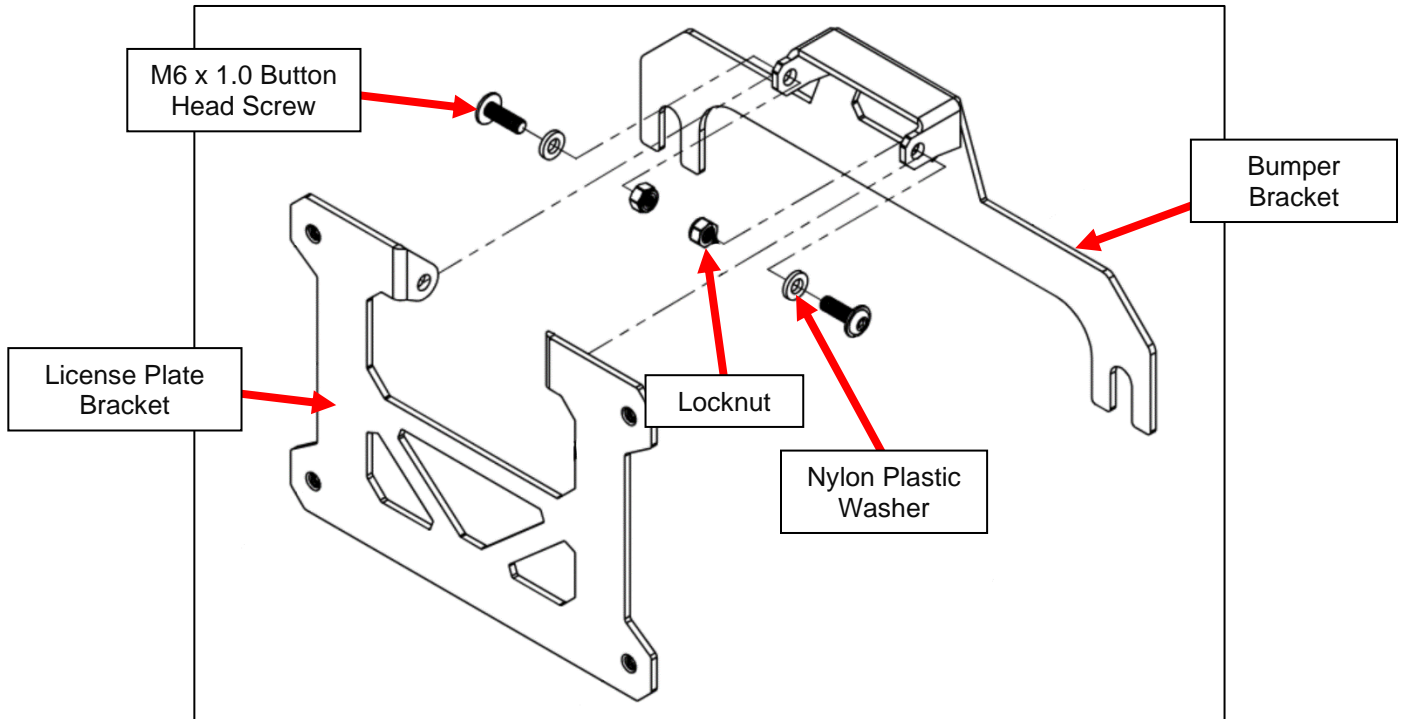

*Figure 1*

3. Attach a License Plate to the License Plate Bracket with the optional (4) four M6 x 1.0 Flanged Button Head screws. *Figure 2.*

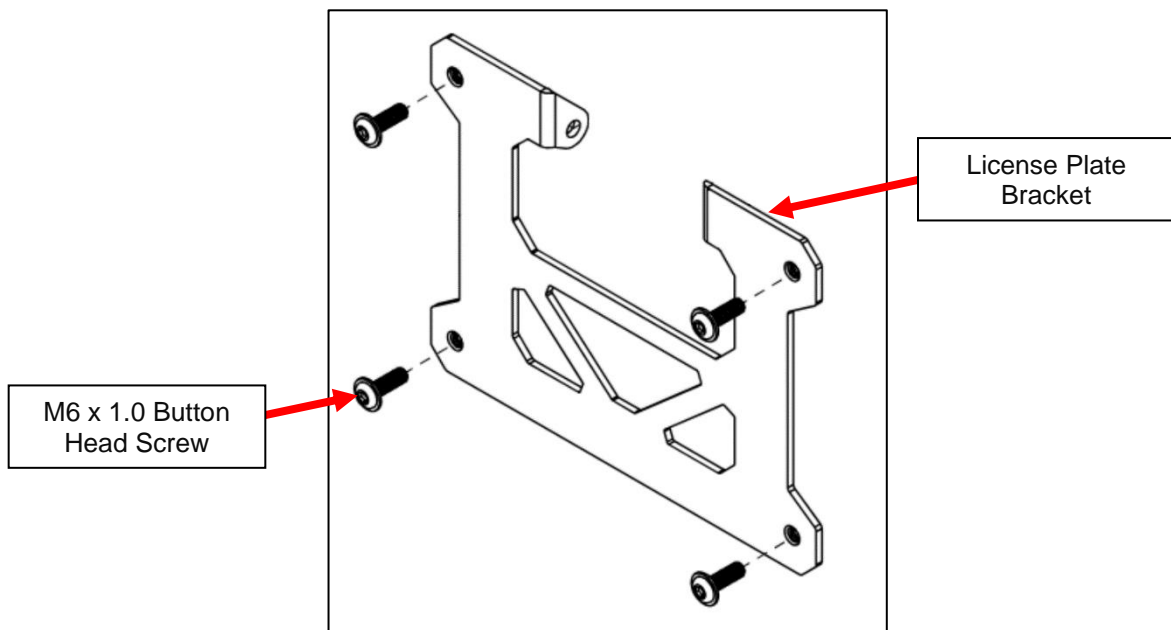

*Figure 2*

4. If using an already installed Fairlead, loosen the (2) two bolts securing the Fairlead to the vehicle. Slide the open end of the Bumper Bracket behind the Fairlead and over the bolts. Retighten the Fairlead Bolts to secure the Bumper Bracket to the vehicle. *Figure 3.*

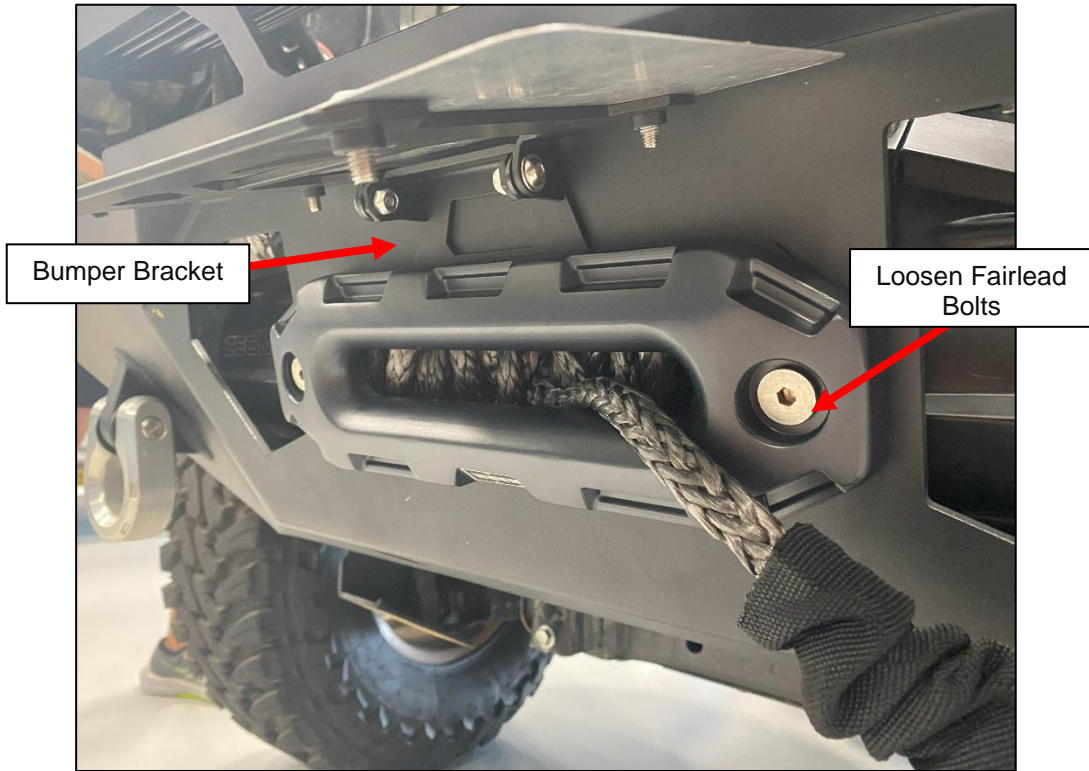

*Figure 3*

5. If you do not have a Fairlead installed, locate the (2) two 3/8" Button Head Hex Screws, 3/8" Washers, and 3/8" Hex Nuts. Place a Washer on the Hex Screw, and install it into the front of the Bumper, sandwiching the Bumper Bracket to the Bumper. Secure with a Hex Nut on the back side of the Bumper. *Figure 4.*



*Figure 4*

**END**

**Additional Technical Support:**  
Contact Z1 Off-Road at [info@z1offroad.com](mailto:info@z1offroad.com)  
Or call 678-839-8019 between 9am and 6pm ET