

Z1 SOLID SHIFTER SUPPORT BUSHINGS INSTALLATION MANUAL



This Installation Manual is intended for the following models:	
2005-2008	Nissan 350Z
2005-2008	Infiniti G35
2009-2020	Nissan 370Z
2008-2013	Infiniti G37
2014-2015	Infiniti Q60
2023+	Nissan Z

PROLOGUE:

Study these instructions completely before proceeding to assembly. The installer must have a thorough knowledge of automotive systems operation. If unfamiliar with any of the concepts outlined in this instruction, we recommend the installation be completed by a qualified professional.

WARNING!

Extreme caution should be taken when performing maintenance or performance upgrades to your vehicle. Please observe and abide by any Warning or Caution labels placed on the various components and tools used when servicing your vehicle. If you have any questions regarding installation or the various components included with the Z1 Motorsports Solid Shifter Support Bushings, consult with a Professional Mechanic or contact Z1 Motorsports for more information.

PARTS INCLUDED:

Item	Quantity	Description
1	4	Solid Bushings
2	1	Install/Removal Tool – Driver Tool
3	1	Install/Removal Tool – Receiver Tool
4	1	M8-1.25 x 60mm Bolt
5	1	M8 Flat Washer

TOOLS REQUIRED:

- Hydraulic Jack
- (2) 2-Ton (or greater) Jack Stands
- Ratchet
- Ratchet Extension(s)
- Assorted Metric Sockets
- Assorted Metric Wrenches

SAFETY REQUIREMENTS:

- Always wear safety glasses and any necessary protective garments. If using any fluids, chemicals, or solvents, a respirator is recommended.
- Always turn the ignition to the OFF position and disconnect the NEGATIVE battery terminal.
- Always use properly rated jack stands when working under your vehicle.
- Always keep limbs and parts away from moving drivetrain parts.
- Only operate drivetrain in safe space and well-ventilated areas.

BEFORE YOU BEGIN:

Remove contents from the Z1 Motorsports Solid Shifter Support Bushings and verify that ALL necessary hardware is present.

PROCEDURE:

1. Place the transmission in Park position (or in Reverse gear if equipped with a manual transmission). Apply the parking brake.
2. Remove shift knob.
3. Lift up on the rear of the console boot to disengage its plastic clips. Rotate console boot to the side to provide access to the (4) bolts on the rubber hole cover/boot. Remove the (4) bolts (shown below).

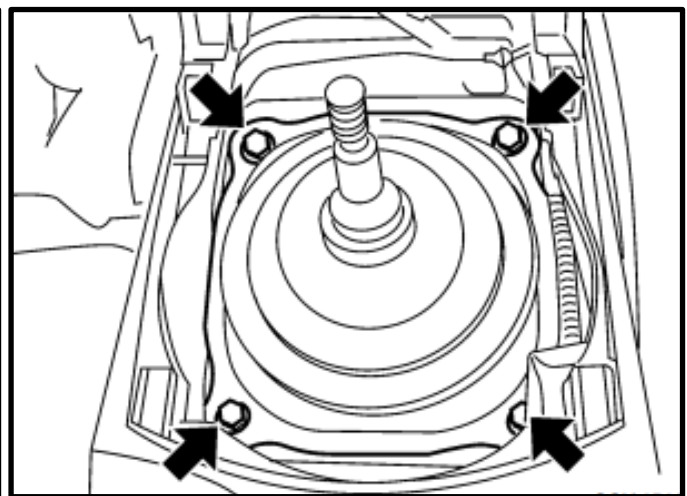
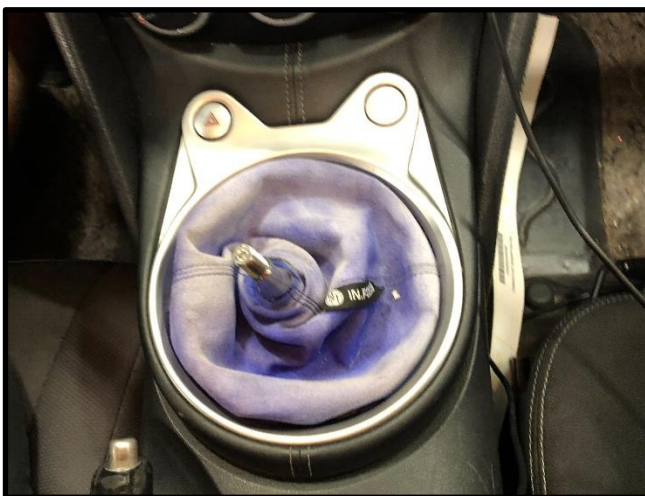

- Remove the (3) bolts securing the guide plate to the shifter support bracket (circled below).

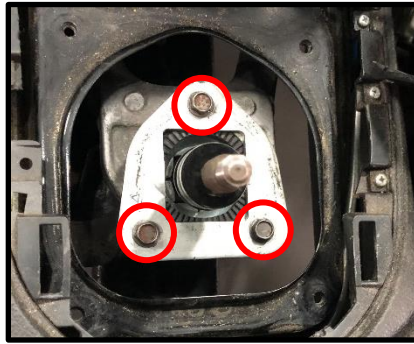

Note: Put pressure on the shifter/guide plate while removing these bolts, as the shifter spring may make the plate fly out of the shifter support bracket.

- Locate proper jacking points on vehicle's chassis (refer to vehicle's Owner Manual). Raise and support vehicle using jack & jack stands.
- If present, remove the dust boot around the shifter and fork on the shifter rod at rear of transmission.
- Remove the bolt securing the shifter to the fork on the shifter rod at rear of transmission (as shown).



- Separate shifter from fork. Remove shifter assembly and shifter spring from shifter support bracket.
- Using a jack, support the rear of the transmission.
- Remove the (4) bolts securing the transmission cross member to the chassis.
- Carefully and slowly lower the jack and transmission enough to access the top bolts of the shifter support bracket.

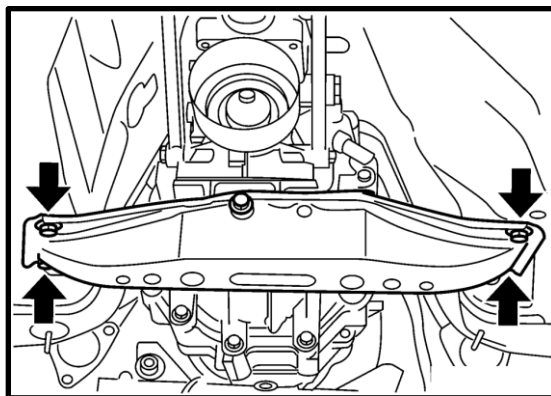

12. Remove the (4) bolts securing the shifter support bracket to the transmission (circled below).

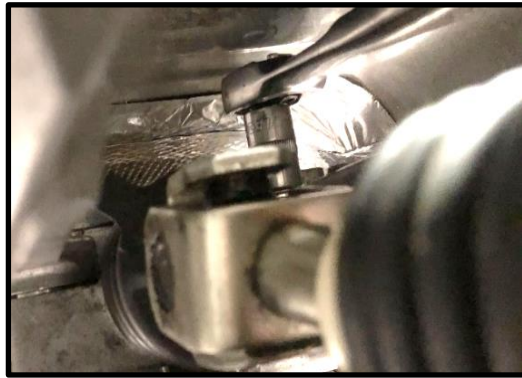
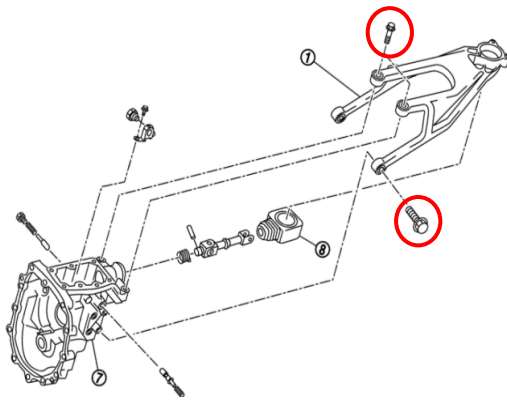

Note: The top two bolts can be tricky to reach. We found it easiest to use a skinny ratchet and a short socket after lowering the transmission a bit (as shown). A ratcheting wrench would also work.

13. Remove Y-pipe. Use penetrating fluid if exhaust bolts are hard to remove.

14. With Y-pipe removed, you should have enough room to rotate and snake shifter support bracket around driveshaft to remove it.

Steps #15-23 are for the Z1 install/removal tool. Instructions are not provided for other install/removal methods.

15. Locate Z1 Install/Removal Tool.

16. Place the larger receiver tool on one end of the OEM bushing with the recessed pocket towards the bushing and part number on bottom. It is recommended to apply silicone spray to the OEM bushings before removal.

17. Put the 60mm bolt through the driver tool and position on other side of OEM bushing so that the part number on the driver tool is facing out (as shown).

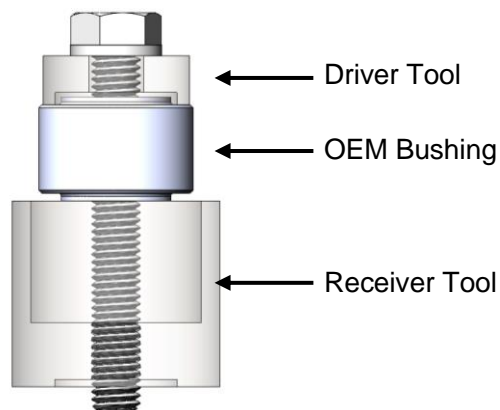

18. Thread the bolt into the receiver tool to remove the OEM bushing. Repeat on other (3) bushings.

19. Clean bores of shifter support bracket to remove any and all dirt/debris.

20. Locate new Z1 Solid Bushings.

Note: It is recommended to put the bushings in the freezer prior to installation.

21. Position (1) bushing in place on shifter support bracket.
22. Position the larger receiver tool on opposite side of bracket, with the recessed pocket facing away from the bushing. This will ensure the new Z1 Solid Bushing is pressed in the proper depth.
23. Put the 60mm bolt through the driver tool and Z1 Solid Bushing so that the bolt is sitting inside the recessed face of the driver tool (as shown).

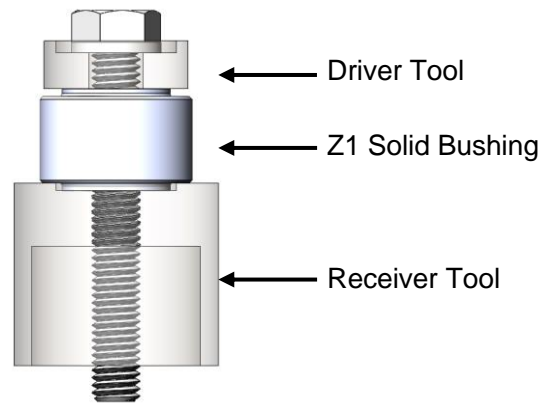
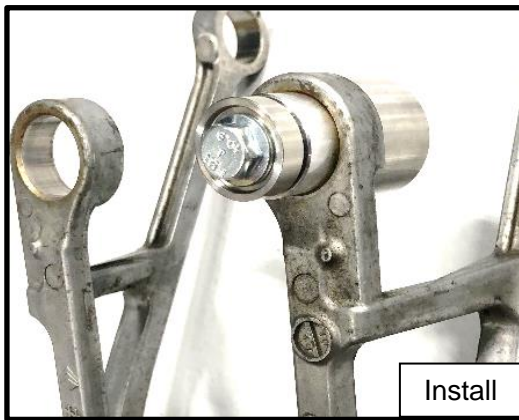

24. Thread the bolt into the receiver tool to install the Z1 Solid Bushing. Repeat on other (3) bushings.



25. Repeat steps #2-15 in reverse order to reinstall shifter support bracket and previously removed components.
26. Properly lower vehicle from jack stands.
27. Inspect vehicle for loose tools/items
28. Perform a final test drive of vehicle.

END

Additional Technical Support:
 Contact Z1 Motorsports at info@z1motorsports.com
 Or call 770-838-7777 between 9am and 6pm ET