



Z1 350Z / G35 (HR) CARBON COLD AIR INTAKE KIT INSTALLATION MANUAL



This Installation Manual is intended for the following models:

2007-2008	Nissan 350Z
2007-2008	Infiniti G35 Sedan

PROLOGUE:

Study these instructions completely before proceeding to assembly. The installer must have a thorough knowledge of automotive systems operation. If unfamiliar with any of the concepts outlined in this instruction, we recommend the installation be completed by a qualified professional.

WARNING!

Extreme caution should be taken when performing maintenance or performance upgrades to your Vehicle. Please observe and abide by any Warning or Caution labels placed on the various components and tools used when servicing your Vehicle. If you have any questions regarding installation or the various components included with the Z1 Motorsports 350Z / G35 HR Carbon Cold Air Intake Kit, consult with a Professional Mechanic or contact Z1 Motorsports for more information.

PRODUCT OPTIONS:

INTAKE PIPE FINISH OPTIONS:

Carbon



SILICONE OPTIONS:

Black Silicone
Red Silicone
Blue Silicone



PARTS INCLUDED:

Item	Quantity	Description
1	1	Z1 2.5" Intake – Driver Side
2	1	Z1 2.5" Intake – Passenger Side
3	1	Air Intake L-Hose – Driver Side
4	1	Air Intake L-Hose – Passenger Side
5	2	Silicone Straight Reducer Hose
6	1	PCV Hose 70mm 5/8" Dia. – Driver Side
7	1	PCV Hose 115mm 5/8" Dia. – Passenger Side
8	2	Z1 Air Filter
9	10	HD Hose Clamp, 2-1/3" to 3-1/4"
10	2	Air Filter Union
11	4	Constant Tension Clamp
12	1	5/8" Hose Union

TOOLS REQUIRED:

- Hydraulic Jack
- (2) 2-Ton (or greater) Jack Stands
- 8mm Nut Driver
- 10mm Socket/Wrench
- 14mm Socket/Wrench
- Ratchet
- Ratchet Extension (minimum 6")
- Silicone Spray
- Pliers
- Flat-head Screwdriver
- Philips-head Screwdriver
- Saw

SAFETY REQUIREMENTS:

- Always wear safety glasses and any necessary protective garments. If using any fluids, chemicals, or solvents, a respirator is recommended.
- Always turn the ignition to the OFF position and disconnect the NEGATIVE (-) battery terminal.
- Always use properly rated jack stands when working under your Vehicle.
- Always keep limbs and parts away from moving drivetrain parts.
- Only operate drivetrain in safe space and well-ventilated areas.

BEFORE YOU BEGIN:

Remove contents from the Z1 Motorsports 350Z / G35 HR Cold Air Intake Kit and verify that ALL necessary hardware is present.

The following kit has been developed and tested with US Model 350Zs. Repositioning, modification, and/or removal of front-end components may be required when used on a Nismo Edition Model 350Z or other models.

PROCEDURE:

1. Place the transmission in Park position (or in Reverse gear if equipped with a manual transmission). Apply the parking brake.
2. Loosen but do not remove the lug nuts on the front wheels.
3. Locate proper jacking points on the vehicle's chassis (refer to vehicle's Owner Manual). Raise and support vehicle using jack and jack stands.
4. Remove the front wheels.
5. Raise and support the hood of the vehicle.
6. Remove the Undershroud from the vehicle if applicable and set aside. *Figure 1.*



Figure 1

7. Remove plastic clips and remove the Front Fender/Fender Liners to reveal a mounting screw on each side of the vehicle which mounts the corner of the Bumper Fascia to the vehicle. Remove each Mounting Screw. *Figure 2.*

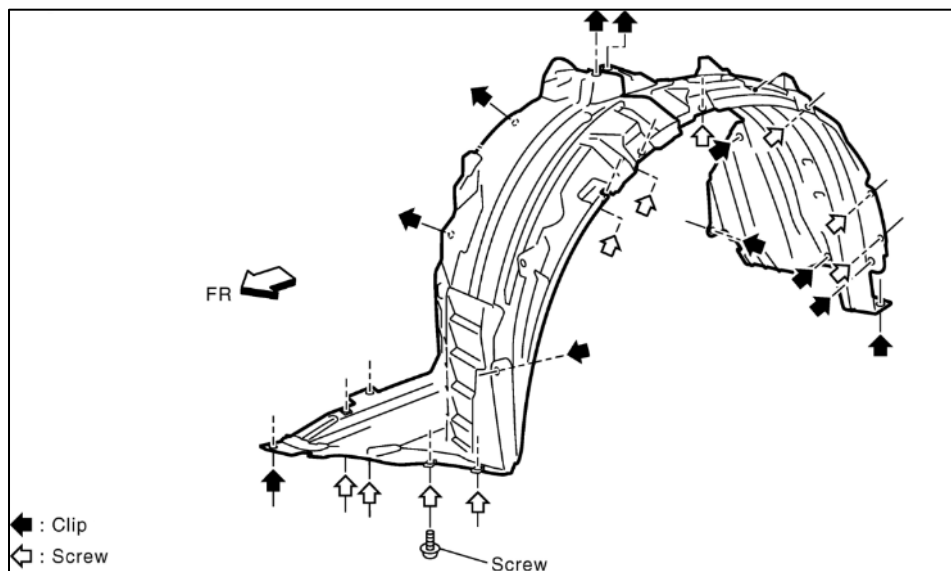
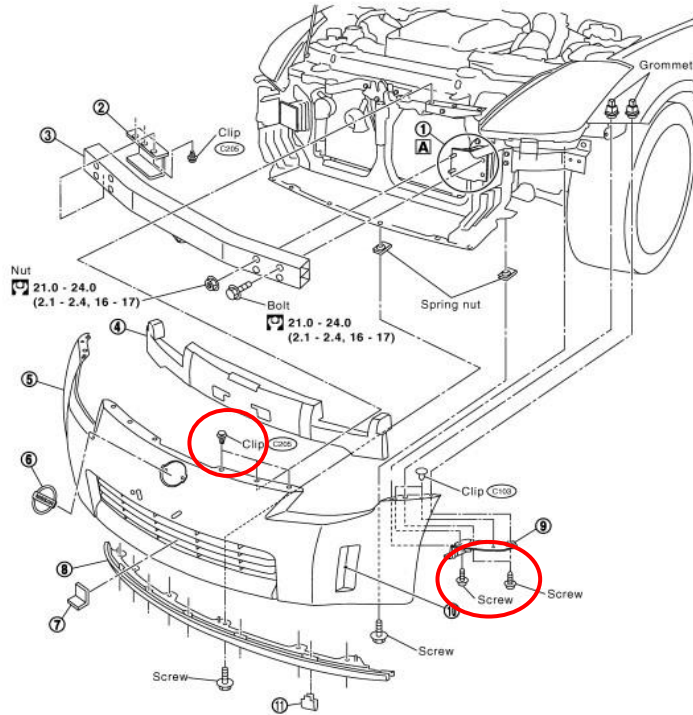

Figure 2

8. **G35 MODELS:** Disconnect the Front Bumper Side Marker Harnesses.

NOTE: Refer to *Figure 3* below for locations of Bumper mounting hardware and Core Support Clips for applicable models.

350Z



G35 Sedan

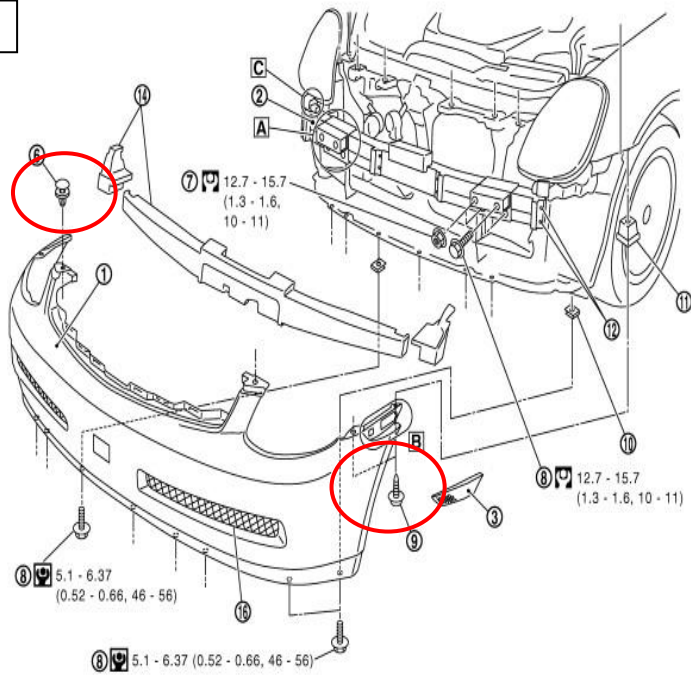

Figure 3

9. Remove plastic pop clips securing the upper Bumper Fascia to the vehicle at the Radiator Core Support. *Figure 3.*
10. With a light pull motion, carefully disengage the Bumper Fascia from the clips on the vehicle just below the headlight. Remove Bumper Fascia and set aside.
11. Remove the Foam Impact Absorber in front of the Crash Bar. *Figure 3.*
12. Remove the (4) four bolts and (4) four hex nuts securing the Front Crash Bar to the chassis, retain the hardware as it will be reused. Remove Crash Bar. *Figure 3.*
13. **G35 Owners:**
 - a. Remove the (4) four screws that secure the Headlights to the Vehicle. *Figure 4.*

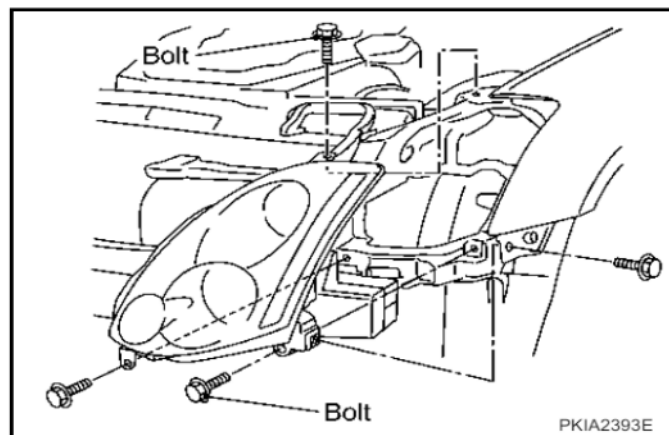
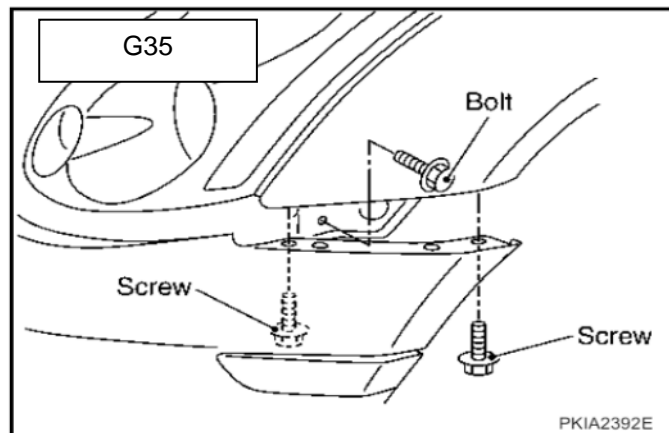

Figure 4

- b. Disconnect the wiring harness to each headlight.
- c. Once disconnected, pull headlight towards the front of the vehicle, and remove.

NOTE: Use *Figure 5* below as reference for Steps 14-16.

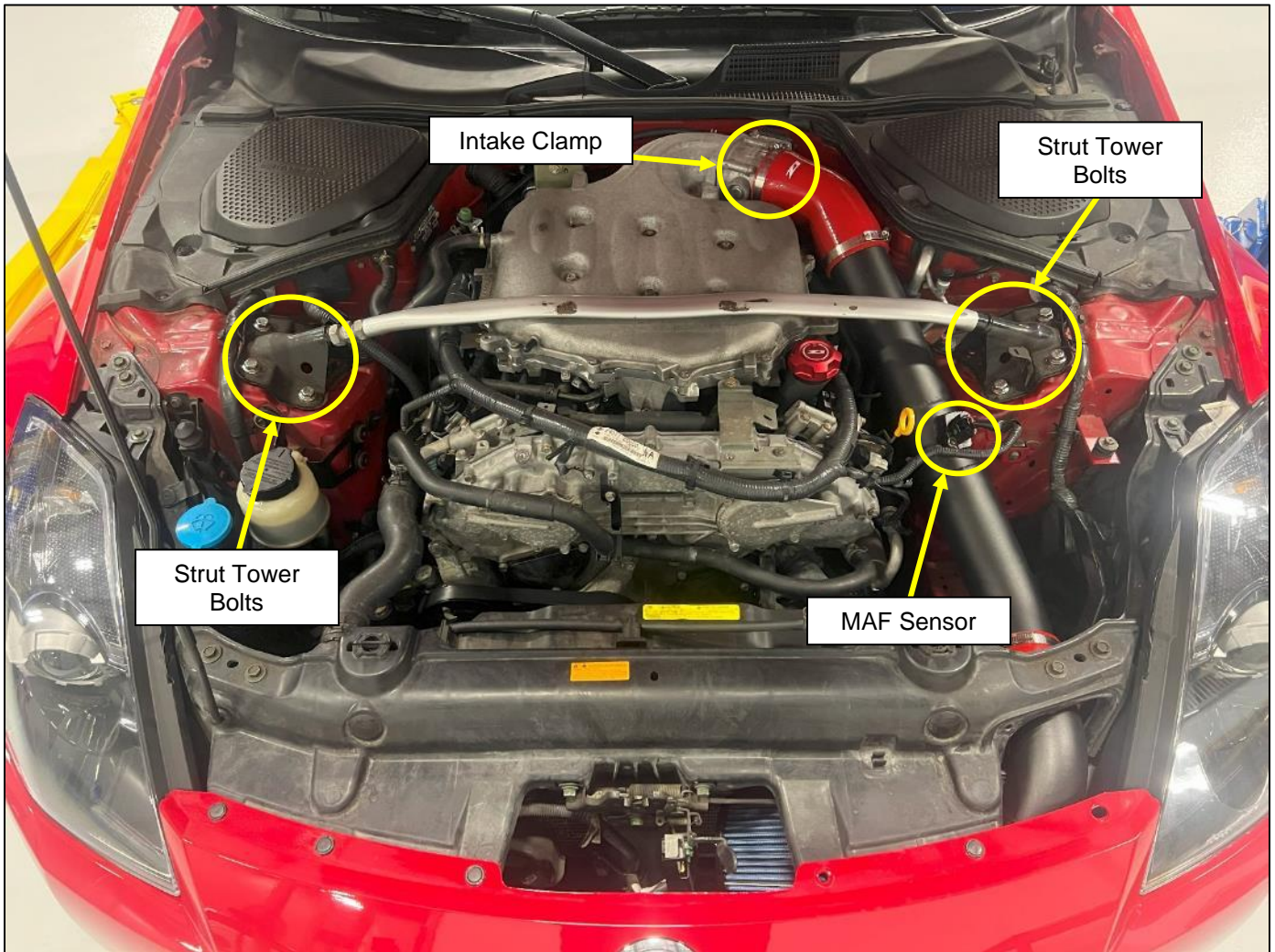

Figure 5

14. Remove the (8) eight bolts that secure the Strut Tower Brace to the chassis if your vehicle is equipped with one.
15. Loosen the Hose Clamp that secures the Air Intake to the Throttle Body.

16. Disconnect and remove the OE Air Intake from the Vehicle. 350Z and G35 Models will vary slightly. *Figure 6.*

NOTE: Disassembly of Aftermarket Intakes may vary.

- a. Remove the Clips and slide the Air Duct Inlet towards the front of the Vehicle. Disengage the clips and Air Filter Box.
- b. Disconnect the MAF Sensor Harness from the Intake Tube.
- c. Disconnect the PCV Hose from the Intake Tube.
- d. Remove the bolts securing the OE Airbox and Intake Tube from the vehicle. Circled below.

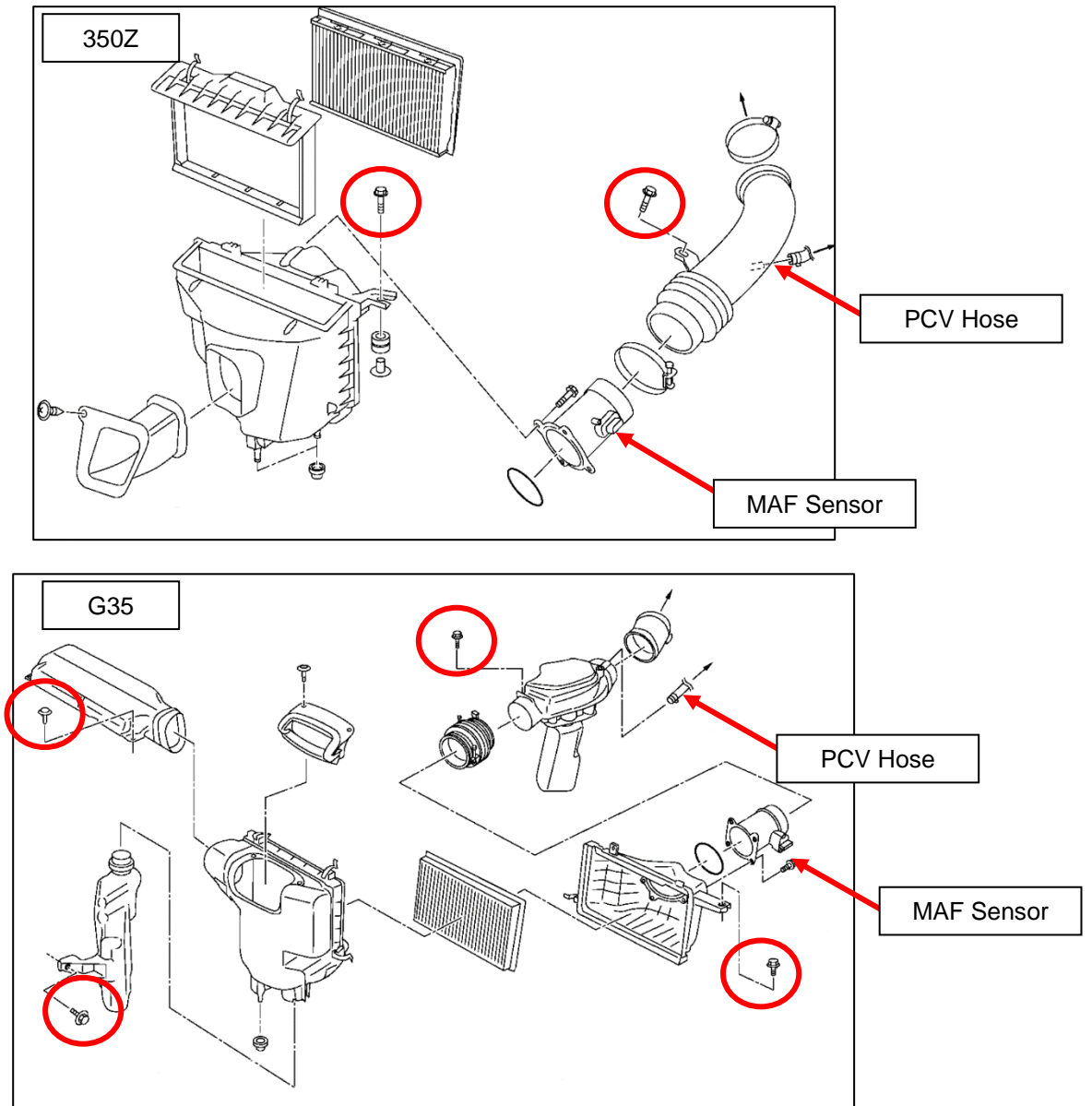

Figure 6

17. Temporarily remove and modify driver side baffle, as shown in picture below. Reinstall driver side baffle.
Figure 7.



Figure 7

18. Locate the 70mm long hose and (2) two Constant Tension Clamps. Slide the Clamps over the Hose, then install the Hose over the nipple of the driver side Baffle. Secure the Hose at the Baffle with a Clamp.

19. Locate (2) two Silicone Reducers and (2) two Hose Clamps. Position the Reducers and a loose Hose Clamp over each Throttle Body, then tighten the Hose Clamps. *Figure 8.*



Figure 8

20. Locate (2) two Air Filters, (2) two Air Filter Unions, and (2) two Hose Clamps. Insert the barbed side of the Union into each Air Filter. Position a Hose Clamp over each Air Filter and tighten. *Figure 9.*



Figure 9

21. Remove the (2) two bolts which mount each MAF Sensor to the OEM Air Intake Assembly. Transfer each Sensor and the (2) two bolts to the MAF Sensor Flange on the new Z1 Air Intake Pipes.

NOTE: Be sure to install the MAF Sensor into the Air Intake Pipe facing the same direction as removed from OE Intake Pipe. There is an arrow on each MAF Flange showing the direction of airflow.

22. Locate the Driver Side Air Intake Pipe and (1) one Hose Clamp. There is a left and right Intake Pipe. The MAF Sensor should be on the bottom side of the Air Intake Pipes, with the arrow showing the direction of airflow pointing towards the Throttle Bodies. Position the Hose Clamp over the Silicone Reducer and slide in the Driver Side Air Intake Pipe. Do not tighten the Hose Clamp at the Throttle Body yet.

NOTE: Use of silicone spray or other dissolvable lubricants is recommended for all assembly which involves silicone hoses.

23. Slide the Hose on the Driver Side Baffle onto the nipple of the Air Intake Pipe and secure with a Constant Tension Clamp.

24. Locate the Driver Side Silicone L-Hose. To differentiate the driver and passenger L-Hoses, when oriented with the Z1 logo on top, the longer side will have a slight bend towards the Throttle Bodies, the passenger side will form an “L” and the driver side will form a backwards “L”. Insert the L-Hose through the Core Support on the Driver Side.

NOTE: Silicone Hose will conform to profile of the through hole, however removing a small amount of material from the Core Support is advised for optimal performance.

25. Once through the Core Support, position a loose Hose Clamp over the Silicone Hose and fit onto the Air Intake Pipe. Do not tighten the clamp yet.

26. Place a loose Hose Clamp over the Silicone Hose exposed at the front of the vehicle.

27. Locate (1) one Air Filter Union assembly. Insert the exposed end of the Union into the Silicone Hose at the front of the vehicle. Tighten the Hose Clamp over the Hose and Union to secure them together.

28. Orient the Silicone Reducer, Air Intake Pipe, and Silicone L-Hose for best fitment and to reduce any kinks or stresses. Once adjusted, tighten all Hose Clamps on the Intake Assembly.
29. Repeat Steps 22-28 for the Passenger Side of the Vehicle.
30. Locate a 5/8" Hose Union, 115mm long hose, and (2) two Constant Tension Clamps. Slide the Union into the Intake Crossover Pipe on the passenger side as shown and secure with clamp. Slide 115mm hose over union and secure with clamp. *Figure 10.*



Figure 10

31. The Horns on the Passenger Side may interfere with the Air Filter Assembly. To resolve this issue, simply bend the Horn mounting bracket towards the Radiator until horn is clear of the Air Filter. *Figure 11.*



Figure 11

32. Plug the MAF Sensor Harnesses back into the MAF Sensors.
33. Follow *Steps 6-14* in reverse order to reinstall the Front Bumper and other Components.
34. Properly lower vehicle from jack stands.
35. Inspect vehicle for loose tools/items.
36. Start the vehicle. While at idle, check for leaks or faulty operation of the Air Intake Kit.
37. Locate the C.A.R.B. Exemption Sticker. The sticker must be readily visible under the hood for an Emissions Inspector to easily see it when the vehicle is required to be tested for emissions. It is **NOT** recommended to affix the label to any equipment that is easily removable from the vehicle.

Select a suitable location (Strut Tower, underside of hood, Radiator Shroud, Core Support, etc.). Clean the area to remove all debris and dust. Apply the sticker to vehicle. *Figure 12.*



Figure 12

38. Lower hood of vehicle.
39. Perform a final test drive of vehicle.

END

Additional Technical Support:
Contact Z1 Motorsports at info@z1motorsports.com
Or call 770 838 7777 between 9am and 6pm ET