

Z1 350Z M-SPEC EXHAUST INSTALLATION MANUAL



This Installation Manual is intended for the following models:

2003-2008

Nissan 350Z

PROLOGUE:

Study these instructions completely before proceeding to assembly. The installer must have a thorough knowledge of automotive systems operation. If unfamiliar with any of the concepts outlined in this instruction, we recommend the installation be completed by a qualified professional.

WARNING!

Extreme caution should be taken when performing maintenance or performance upgrades to your vehicle. Please observe and abide by any Warning or Caution labels placed on the various components and tools used when servicing your vehicle. If you have any questions regarding installation or the various components included with the Z1 Motorsports 350Z M-SPEC Exhaust, consult with a Professional Mechanic, or contact Z1 Motorsports for more information.

PARTS INCLUDED:

Item	Quantity	Description
Single Exit		
1	1	Muffler
2	1	Mid-Pipe
3	1	Exhaust Hanger
4	1	Exhaust Gasket
5	2	M10 Bolt
6	2	M10 Nut
7	1	Exhaust Clamp
Dual Exit		
8	2	Muffler
9	1	Front Mid-Pipe
10	1	Rear Mid-Pipe
11	1	V-Band Clamp
12	1	Exhaust Gasket
13	2	Exhaust Clamp
14	2	M10 Bolt
15	2	M10 Nut

TOOLS REQUIRED:

- Hydraulic Jack
- (2) 2-Ton (or greater) Jack Stands
- Ratchet
- Ratchet Extension(s)
- Assorted Metric Wrenches
- Assorted Metric Sockets
- Torque Wrench
- Channel Lock Pliers
- Rust Penetrant

SAFETY REQUIREMENTS:

- Always wear safety glasses and any necessary protective garments. If using any fluids, chemicals, or solvents, a respirator is recommended.
- Always turn the ignition to the OFF position and disconnect the NEGATIVE battery terminal.
- Always use properly rated jack stands when working under your vehicle.
- Always keep limbs and parts away from moving drivetrain parts.
- Only operate drivetrain in safe space and well-ventilated areas.

BEFORE YOU BEGIN:

Remove contents from the Z1 Motorsports 350Z M-SPEC Exhaust and verify that ALL necessary hardware is present.

TABLE OF CONTENTS:

SINGLE EXIT:.....4
DUAL EXIT:7

SINGLE EXIT:

1. Place the transmission in Park position (or in Reverse gear if equipped with a manual transmission). Apply the parking brake.
2. Locate the proper jacking points on the vehicle's chassis (refer to the Vehicle's Owner's Manual). Raise and support the vehicle using a jack and jack stands.
3. Remove the OE Y-Back Exhaust System but leave the Exhaust Hangers. If you are replacing the Y-Pipe, do this at this point as well. Use a Rust Penetrant on all exhaust hardware to help easily remove hardware.

Figure 1.

NOTE: Refer to the [Standard Y-Pipe](#) or [Premium Y-Pipe](#) Installation Guides for Y-Pipe removal and installation.

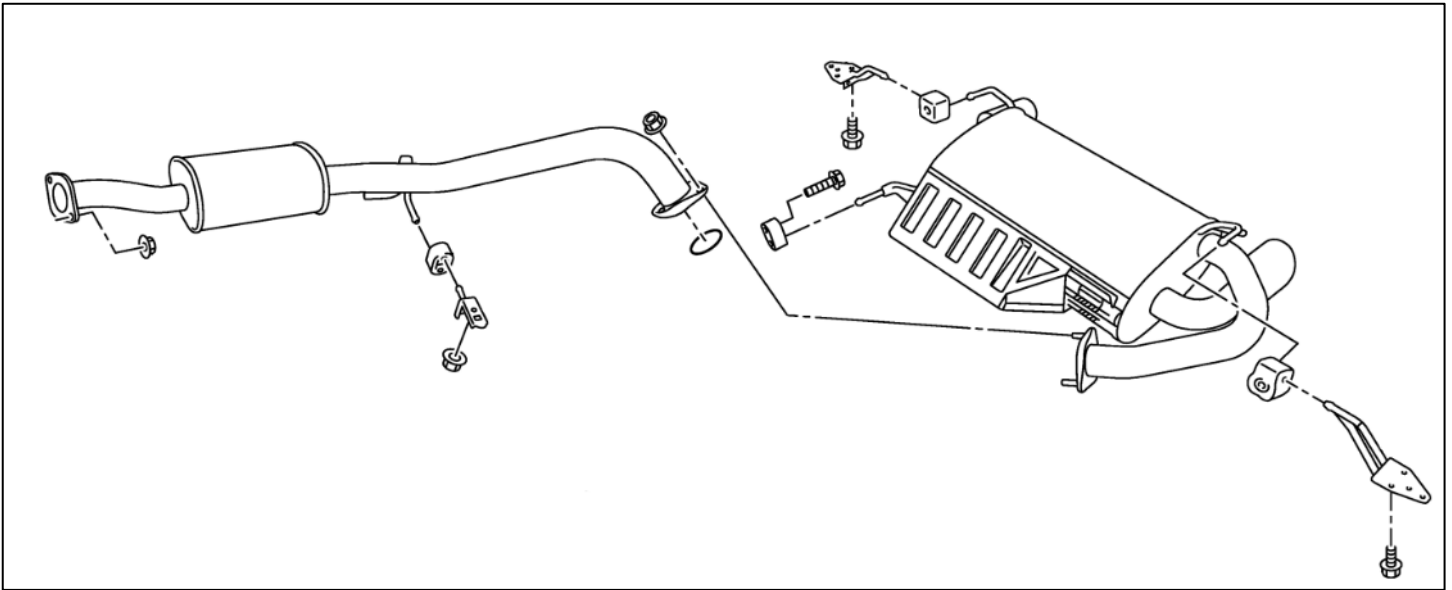

Figure 1

4. Locate the Muffler and Exhaust Hanger. Place the Exhaust Hanger on the Muffler and loosely tighten the clamp to secure it.
5. Hang the Muffler onto the rear Driver Side Exhaust Hanger. *Figure 2.*

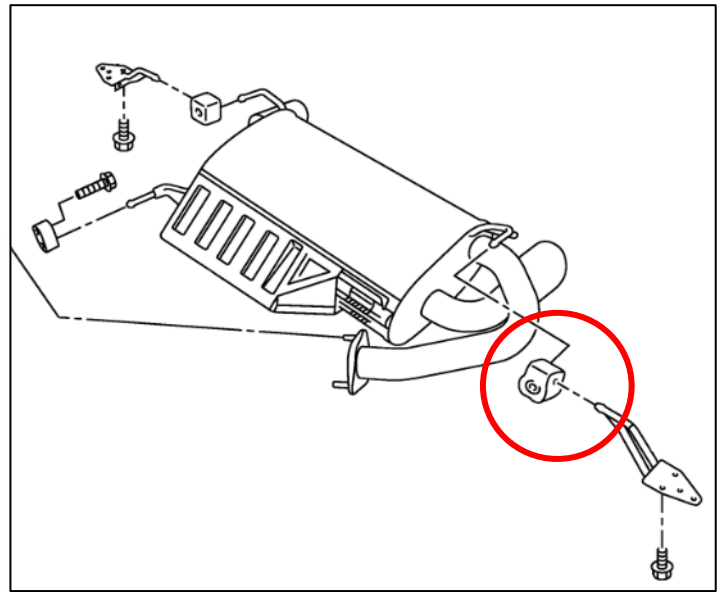
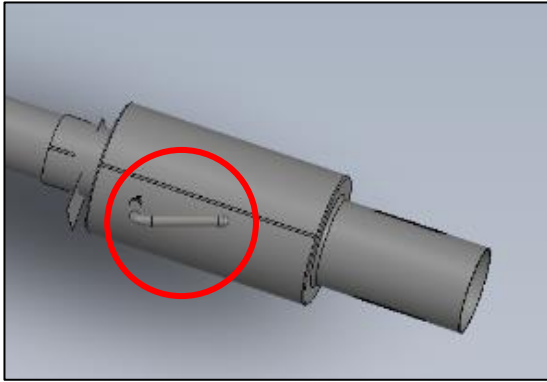
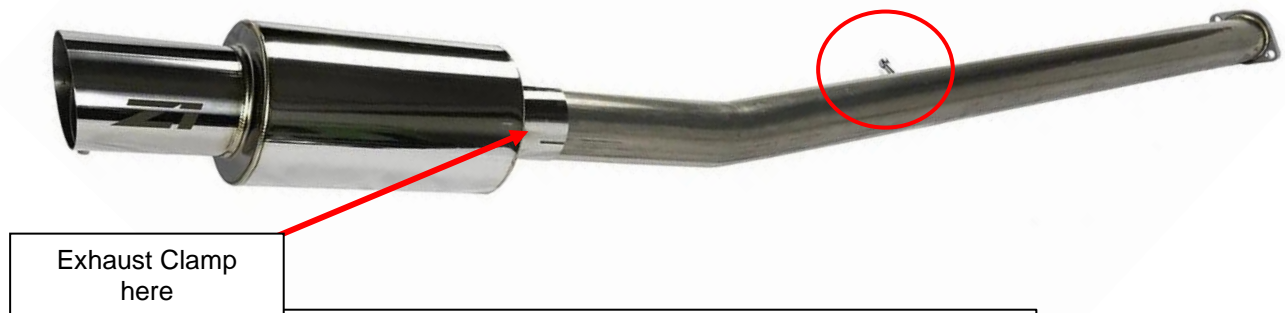

Figure 3

6. Locate the Mid-Pipe, Exhaust Clamp, Exhaust Gasket and M10 Hardware. Install the Mid-Pipe into the Driver Side Exhaust Hanger slip the open end of the Mid-Pipe into the Muffler. Secure with the Exhaust Clamp. *Figure 3.*



Exhaust Clamp
here

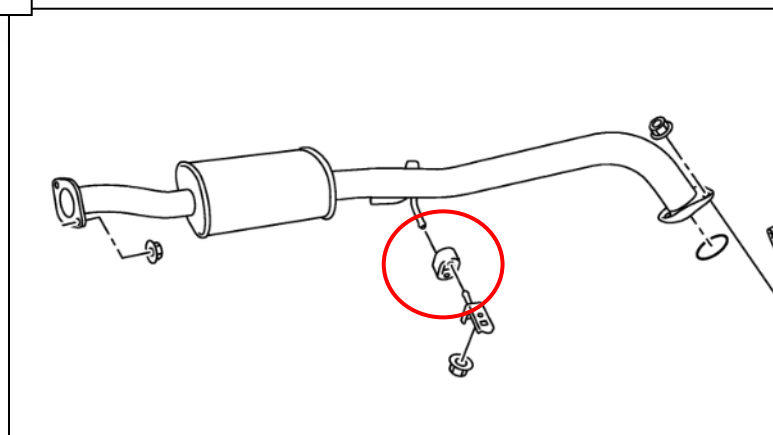

Figure 2

7. Join the Flanged end of the Mid-Pipe to the Y-Pipe with an Exhaust Gasket in between, and loosely secure with the M10 Hardware.
8. Adjust the Exhaust System to the desired fitment.
9. Starting towards the front of the vehicle, tighten all Exhaust Hardware. Torque the M10 Bolts to **43 ft-lbs.**
10. Clean the Exhaust system to remove any grease, debris or fingerprints.
11. Start the vehicle. Check for any exhaust leaks and tighten hardware as necessary.

DUAL EXIT:

1. Place the transmission in Park position (or in Reverse gear if equipped with a manual transmission). Apply the parking brake.
2. Locate the proper jacking points on the vehicle's chassis (refer to the Vehicle's Owner's Manual). Raise and support the vehicle using a jack and jack stands.
3. Remove the OE Y-Back Exhaust System but leave the Exhaust Hangers. If you are replacing the Y-Pipe, do this at this point as well. Use a Rust Penetrant on all exhaust hardware to help easily remove hardware.
Figure 4.

NOTE: Refer to the [Standard Y-Pipe](#) or [Premium Y-Pipe](#) Installation Guides for Y-Pipe removal and installation.

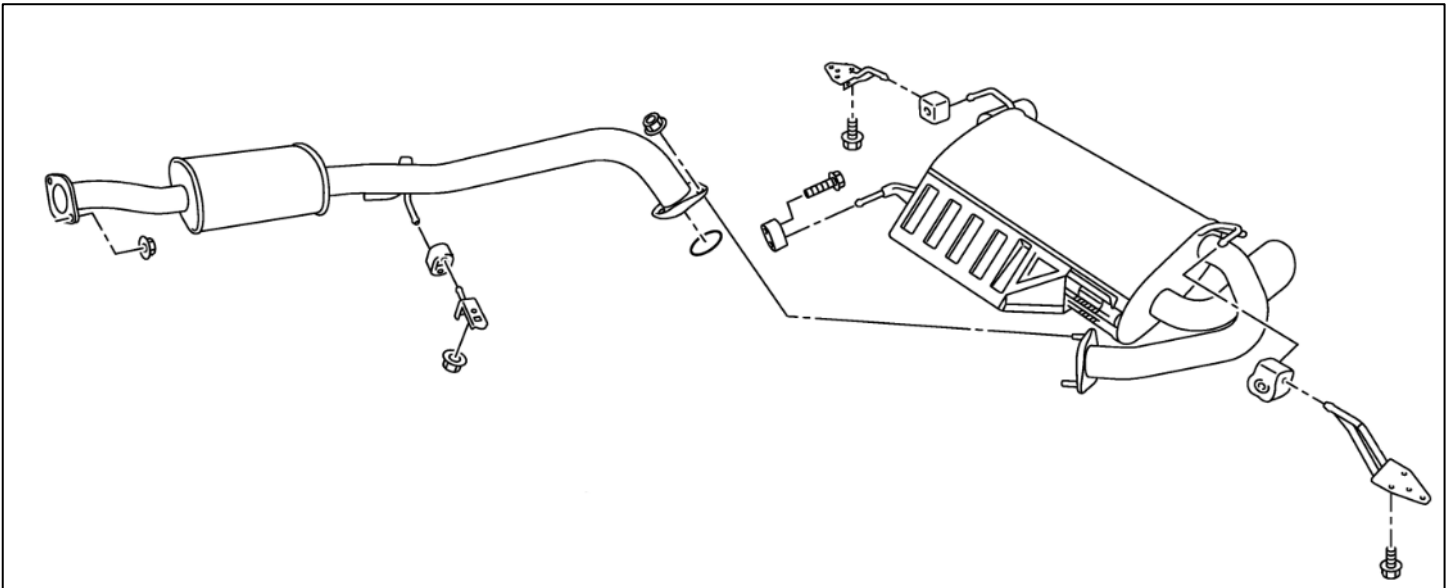

Figure 4

4. Locate the Mufflers and Exhaust Hangers. Place the Exhaust Hangers on each Muffler and loosely tighten the clamps to secure them.
5. Hang the Mufflers onto the rear Exhaust Hangers. *Figure 5.*

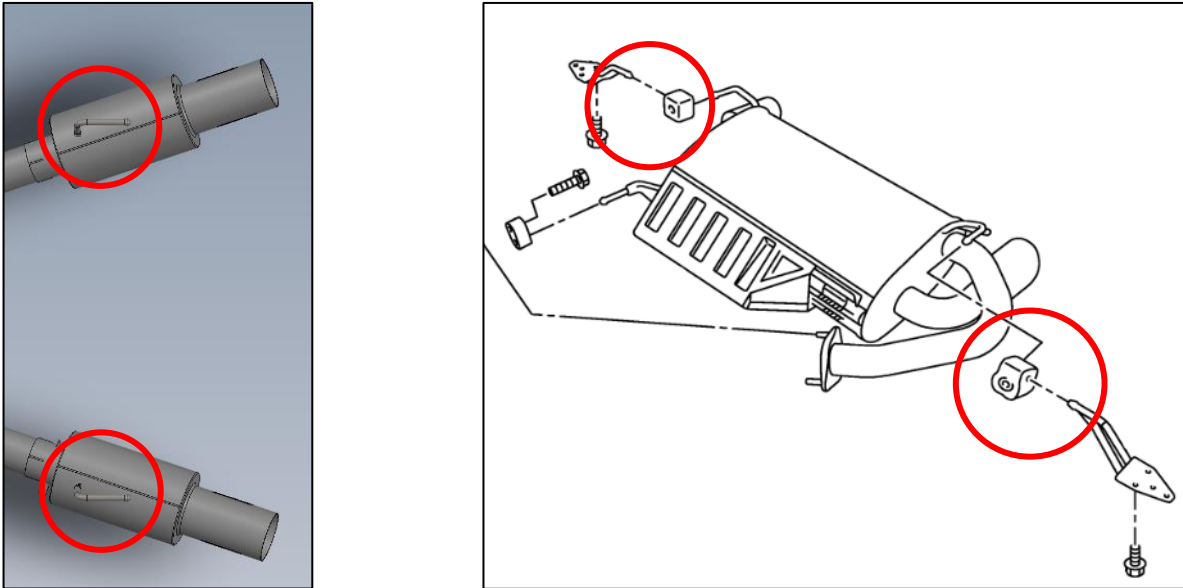

Figure 5

6. Locate the Rear Mid-Pipe and (2) two Exhaust Clamps. Install the Rear Mid-Pipe to the Mufflers and secure with the Exhaust Clamps. *Figure 6.*

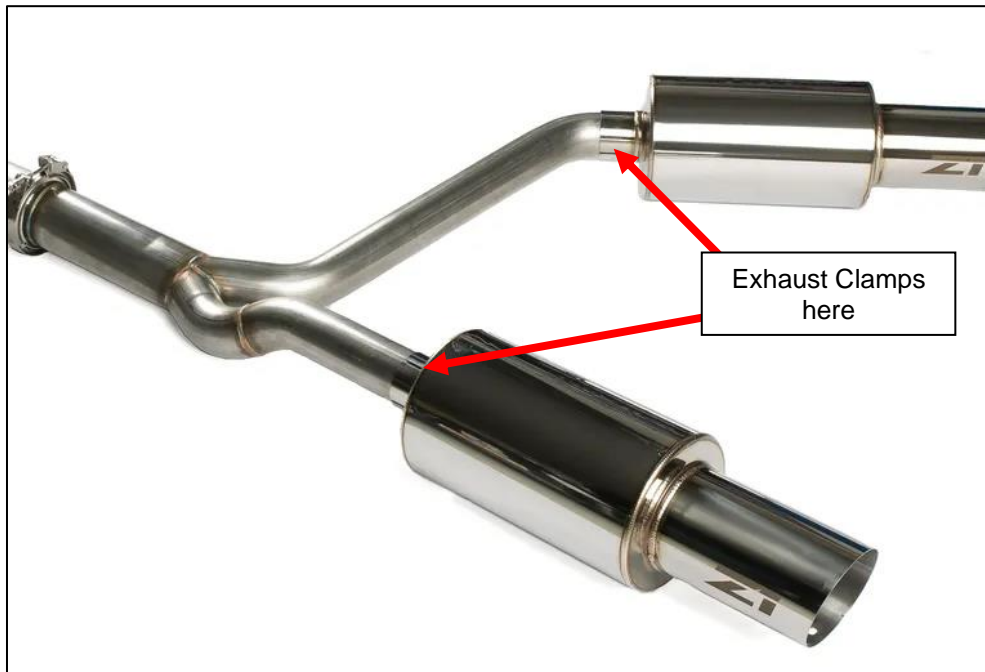

Figure 6

7. Locate the Front Mid-Pipe, V-Band Clamp, Exhaust Gasket and all M10 Hardware. Install the Front Mid-Pipe into the OE Exhaust Hanger. Join the flanged end of the Mid-Pipe to the Y-Pipe with an Exhaust Gasket in between and loosely secure them with the M10 Hardware.
8. Secure the other end of the Front Mid-Pipe to the Rear Mid-Pipe and secure with the V-Band Clamp. *Figure 7.*

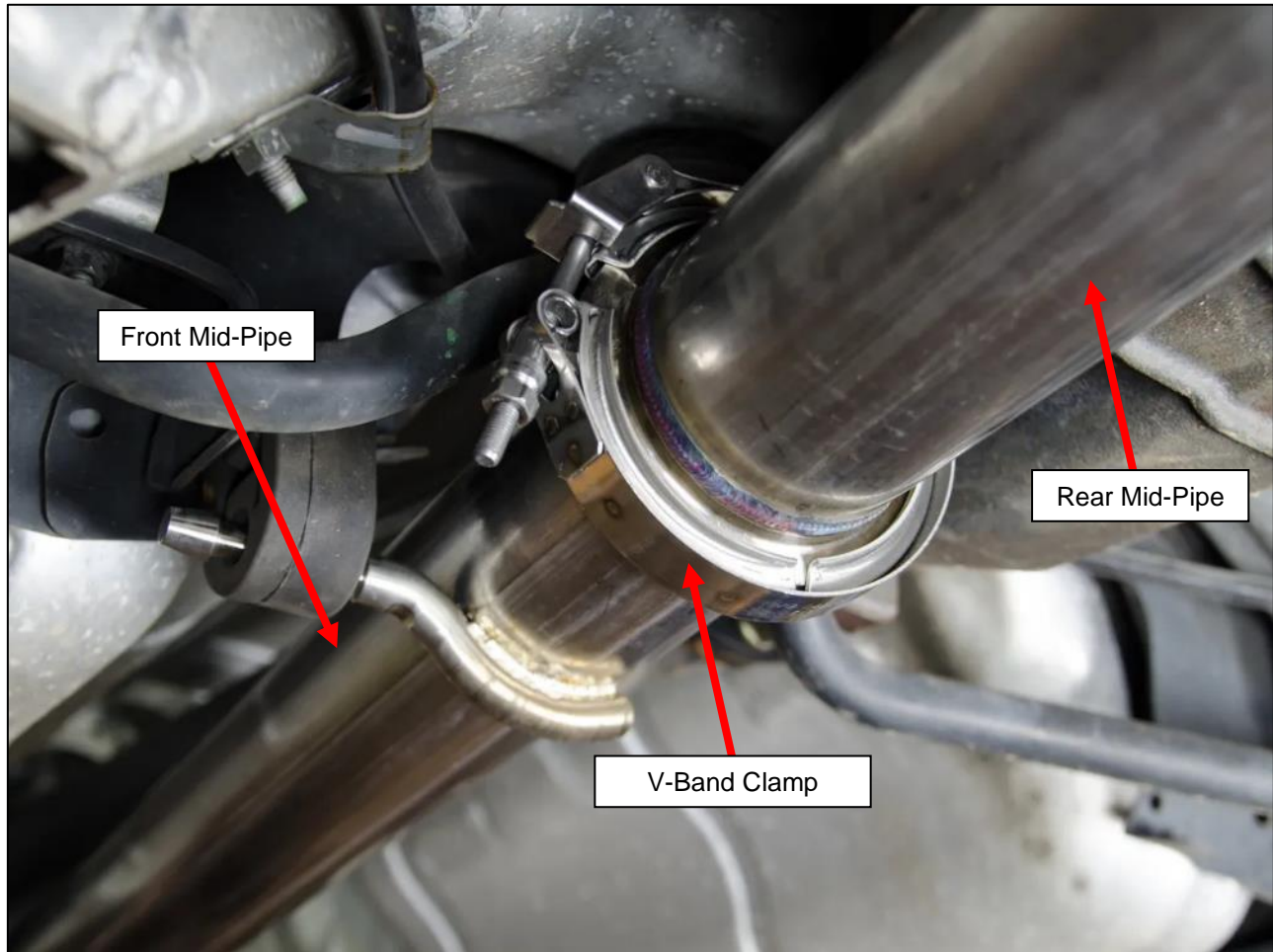

Figure 7

9. Adjust the Exhaust System to the desired fitment.
10. Starting towards the front of the vehicle, tighten all Exhaust Hardware. Torque the M10 Bolts to **43 ft-lbs.**
11. Clean the Exhaust System to remove any grease, debris or fingerprints.
12. Start the vehicle. Check for any exhaust leaks and tighten hardware as necessary.

END

Additional Technical Support:
Contact Z1 Motorsports at info@z1motorsports.com
Or call 770-838-7777 between 9am and 6pm ET