

Z1 350Z RACE EXHAUST INSTALLATION MANUAL



This Installation Manual is intended for the following models:

2003-2008

Nissan 350Z

PROLOGUE:

Study these instructions completely before proceeding to assembly. The installer must have a thorough knowledge of automotive systems operation. If unfamiliar with any of the concepts outlined in this instruction, we recommend the installation be completed by a qualified professional.

WARNING!

Extreme caution should be taken when performing maintenance or performance upgrades to your vehicle. Please observe and abide by any Warning or Caution labels placed on the various components and tools used when servicing your vehicle. If you have any questions regarding installation or the various components included with the Z1 Motorsports 350Z Race Exhaust, consult with a Professional Mechanic, or contact Z1 Motorsports for more information.

PARTS INCLUDED:

Item	Quantity	Description
1	1	Mid-Pipe
2	1	Resonator
3	1	Muffler
4	1	Pipe Clamp
5	1	Exhaust Clamp
6	1	Exhaust Gasket
7	2	M10 Bolt
8	2	M10 Nut
9	1	Exhaust Hanger
10	1	Exhaust Silencer

TOOLS REQUIRED:

- Hydraulic Jack
- (2) 2-Ton (or greater) Jack Stands
- Ratchet
- Ratchet Extension(s)
- Assorted Metric Wrenches
- Assorted Metric Sockets
- Torque Wrench
- Channel Lock Pliers
- Rust Penetrant

SAFETY REQUIREMENTS:

- Always wear safety glasses and any necessary protective garments. If using any fluids, chemicals, or solvents, a respirator is recommended.
- Always turn the ignition to the OFF position and disconnect the NEGATIVE battery terminal.
- Always use properly rated jack stands when working under your vehicle.
- Always keep limbs and parts away from moving drivetrain parts.
- Only operate drivetrain in safe space and well-ventilated areas.

BEFORE YOU BEGIN:

Remove contents from the Z1 Motorsports 350Z Race Exhaust and verify that ALL necessary hardware is present.

PROCEDURE:

1. Place the transmission in Park position (or in Reverse gear if equipped with a manual transmission). Apply the parking brake.
2. Locate the proper jacking points on the vehicle's chassis (refer to the Vehicle's Owner's Manual). Raise and support the vehicle using a jack and jack stands.
3. Remove the OE Y-Back Exhaust System but leave the Exhaust Hangers. If you are replacing the Y-Pipe, do this at this point as well. Use a Rust Penetrant on all exhaust hardware to help easily remove hardware.

Figure 1.

NOTE: Refer to the [Standard Y-Pipe](#) or [Premium Y-Pipe](#) Installation Guides for Y-Pipe removal and installation.

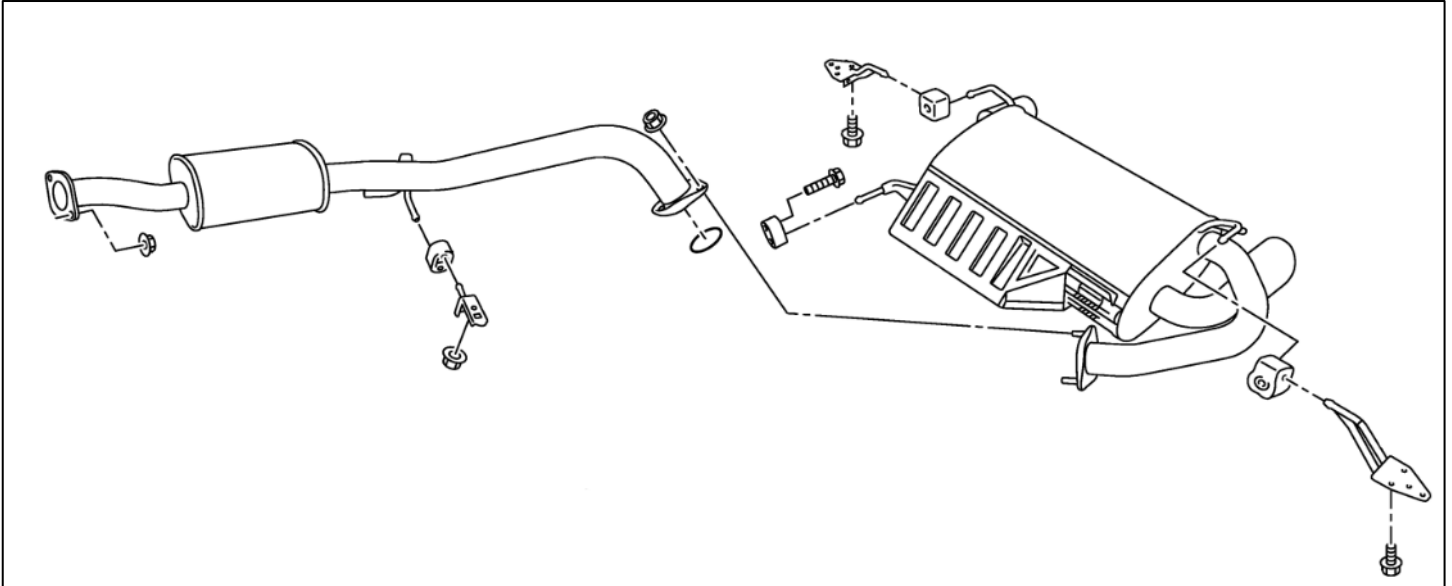

Figure 1

4. Locate the Muffler and Exhaust Hanger. Place the Exhaust Hanger on the Muffler and loosely tighten the clamp to secure it.
5. Hang the Muffler onto the rear Driver Side Exhaust Hanger. *Figure 2.*

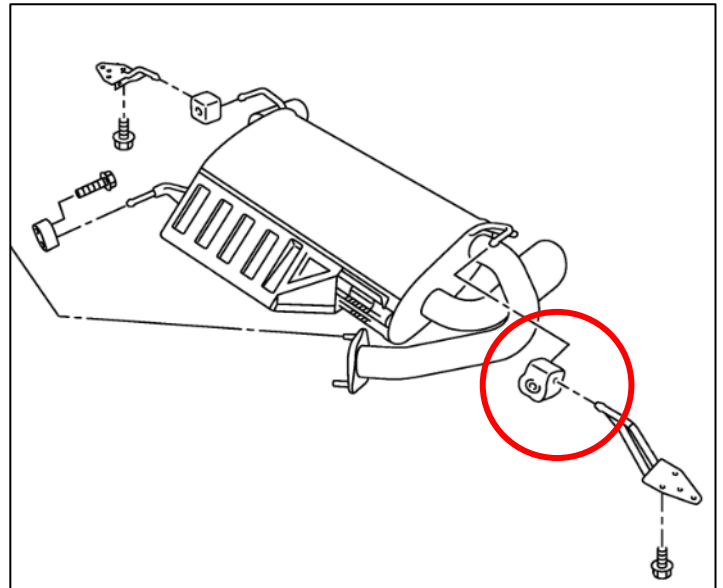
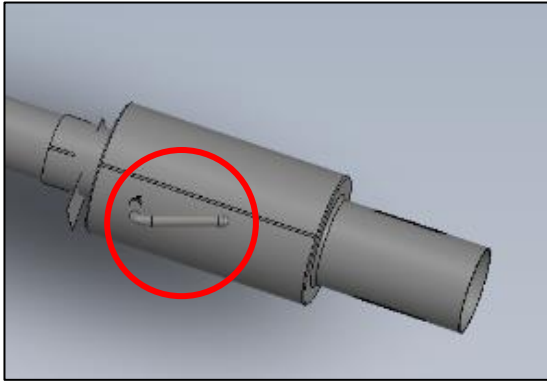

Figure 2

6. Locate the Mid-Pipe and Exhaust Clamp. Position the Mid-Pipe onto the Driver Side Exhaust Hanger and loosely secure it to the Muffler with the Exhaust Clamp. *Figure 3.*

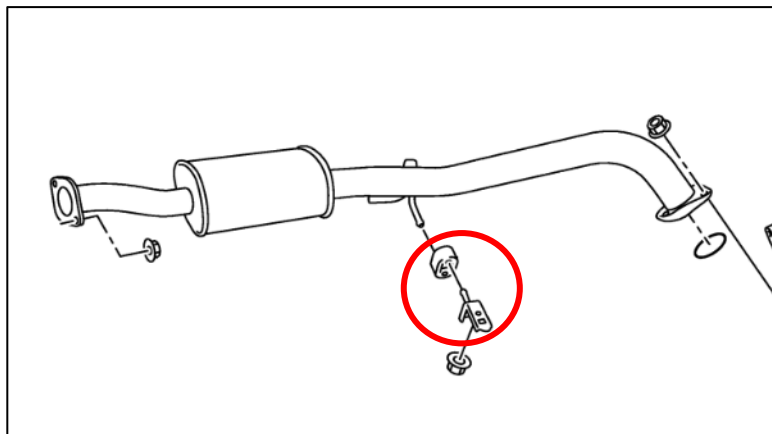
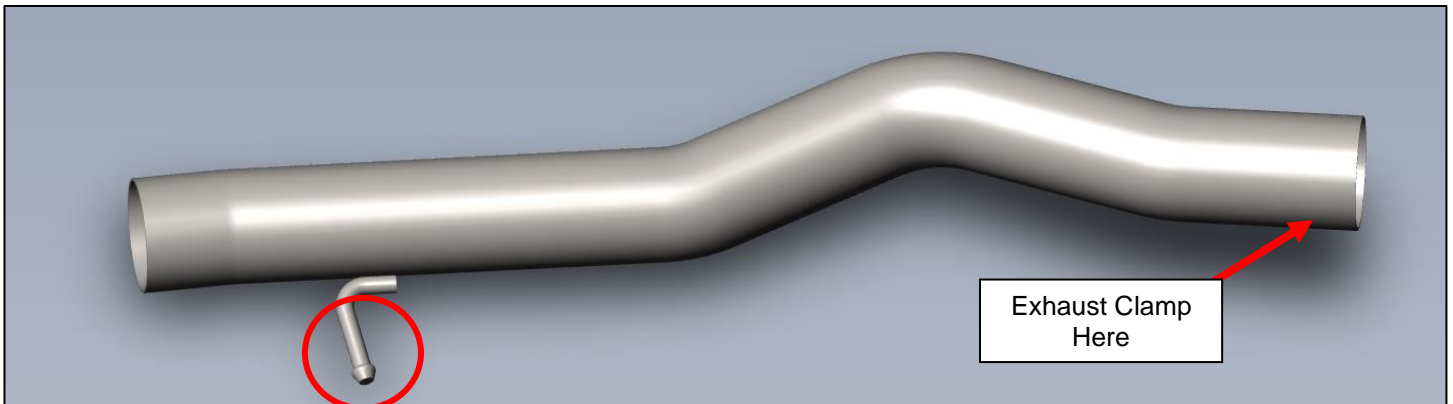

Figure 3

7. Locate the Resonator, Pipe Clamp, Exhaust Gasket and all M10 Hardware. Join the Resonator to the Y-Pipe with the M10 Hardware and an Exhaust Gasket in between. Secure the other end of the Resonator to the Mid-Pipe with the Pipe Clamp. *Figure 4.*

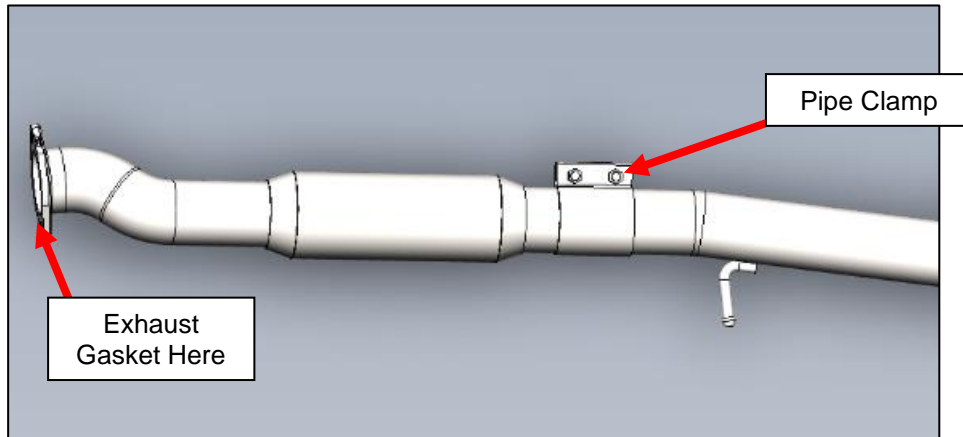

Figure 4

8. Adjust the Exhaust System to prevent binding, allow necessary clearance and have desired fitment.
9. Tighten all exhaust hardware starting at the front of the vehicle. Torque the M10 bolts and nuts to **43 ft-lbs.**
10. Wipe down the Exhaust System to remove grease, debris and fingerprints.
11. Start the vehicle. Check for Exhaust Leaks, tighten hardware as necessary.



END

Additional Technical Support:
Contact Z1 Motorsports at info@z1motorsports.com
Or call 770-838-7777 between 9am and 6pm ET