

Z1 Q50 / Q60 CARBON FIBER DRIVESHAFT INSTALLATION MANUAL



This Installation Manual is intended for the following models:

2016+	Infiniti Q50 VR30 RWD
2017+	Infiniti Q60 VR30 RWD

PROLOGUE:

Study these instructions completely before proceeding to assembly. The installer must have a thorough knowledge of automotive systems operation. If unfamiliar with any of the concepts outlined in this instruction, we recommend the installation be completed by a qualified professional.

WARNING!

Extreme caution should be taken when performing maintenance or performance upgrades to your vehicle. Please observe and abide by any Warning or Caution labels placed on the various components and tools used when servicing your vehicle. If you have any questions regarding installation or the various components included with the Z1 Motorsports Q50 / Q60 Carbon Fiber Driveshaft, consult with a Professional Mechanic or contact Z1 Motorsports for more information.

Item	Quantity	Description
1	1	Z1 1PC Carbon Fiber Driveshaft

TOOLS REQUIRED:

- Hydraulic Jack
- (2) 2-Ton (or greater) Jack Stands
- Ratchet
- Ratchet Extension(s)
- Assorted Metric Sockets/Wrenches
- Torque Wrench
- Channel Lock Pliers

SAFETY REQUIREMENTS:

- Always wear safety glasses and any necessary protective garments. If using any fluids, chemicals, or solvents, a respirator is recommended.
- Always turn the ignition to the OFF position and disconnect the NEGATIVE battery terminal.
- Always use properly rated jack stands when working under your vehicle.
- Always keep limbs and parts away from moving drivetrain parts.
- Only operate drivetrain in safe space and well-ventilated areas.

BEFORE YOU BEGIN:

Remove contents from the Z1 Motorsports Q50 / Q60 Carbon Fiber Driveshaft and verify that ALL necessary hardware is present.

PROCEDURE:

1. Place the transmission in Park position (or in Reverse gear if equipped with a manual transmission). Apply the parking brake.
2. Locate proper jacking points on vehicle's chassis (refer to vehicle's Owner Manual). Raise and support vehicle using jack & jack stands.
3. Remove the (4) bolts securing the transmission undertray to the vehicle (circled at right).
4. Remove the transmission undertray and set aside.

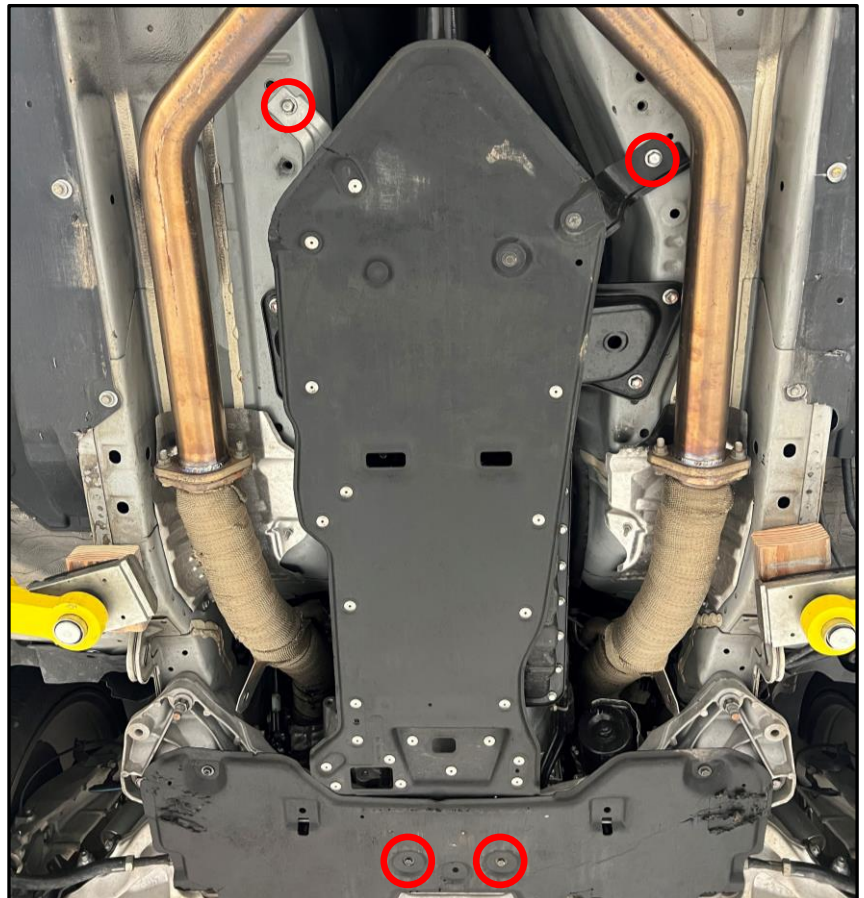

- Remove the (4) bolts securing the grey transmission tunnel crossmember to vehicle (shown with arrows below) and set crossmember aside. This crossmember is located behind the Y-pipe, DO NOT remove the black transmission crossmember that houses the transmission mount.

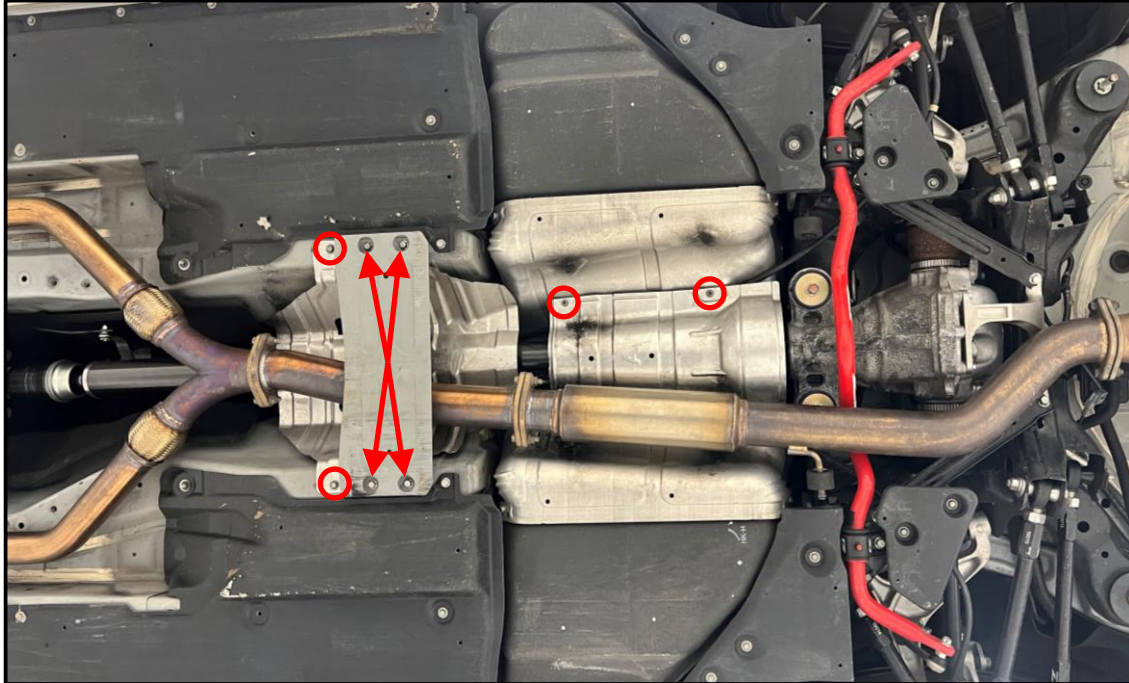

- Remove the Y-pipe and mid-pipe on vehicle. Remove the nuts (and bolts if applicable) securing the front of the Y-pipe to the catalytic converters/test pipes, and the nuts (and bolts if applicable) securing the resonated mid-pipe(s) to the muffler (nuts circled below).

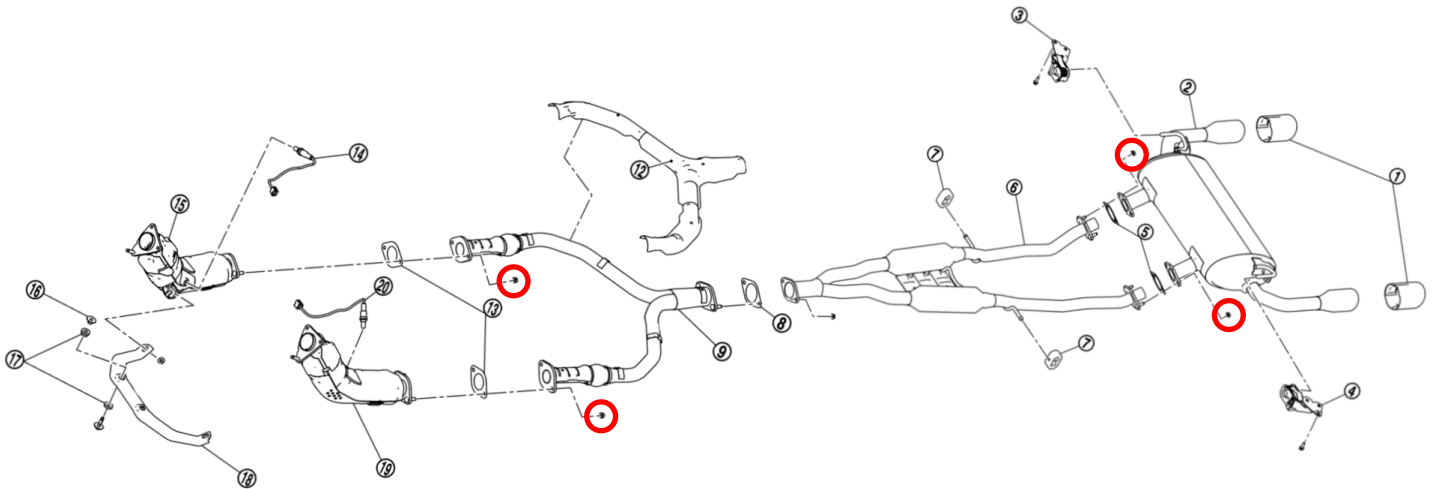

Note: After removing the mid-pipe, the muffler will likely rotate on its hangers causing the tips to contact the bumper which could cause damage if it is hot. It is recommended to put a jack/jackstand under the muffler to prevent it from rotating, or use a metal cable tie to hang the inlets of the muffler onto a spot on the subframe.

- Remove the hardware that secures the two thin metal heat shields above the exhaust, then remove the heat shields and set them aside. The hardware is circled in the first image at the top of this page, the rearward heat shield only has (2) nuts visible in the image, the other two are above the resonated section of the [Z1 Touring Exhaust](#).

8. Loosen the (2) nuts securing the center bearing bracket to the vehicle (shown below), but do not fully remove the nuts.

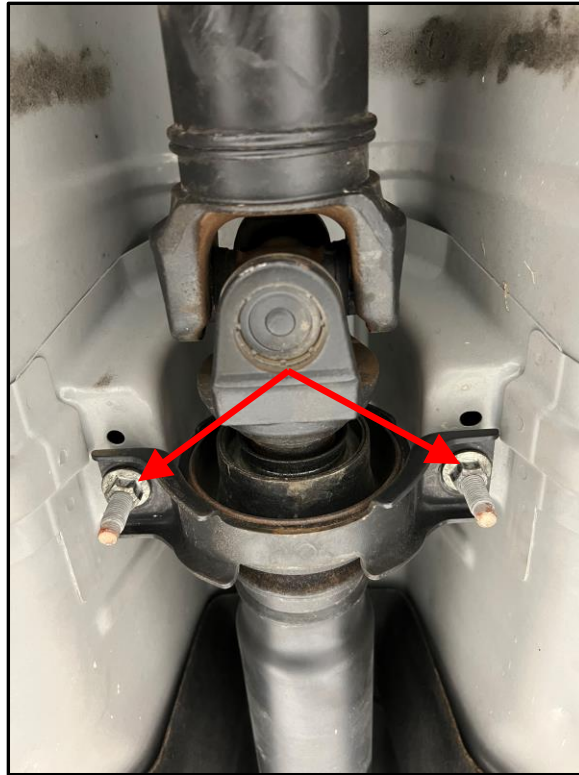

9. Loosen and remove the (3) nuts and bolts securing the OEM driveshaft to the rubber coupler at the rear of the driveshaft (shown below). Do not remove the nuts and bolts securing the differential input flange to the rubber coupler.



10. Separate the OEM driveshaft from the rubber coupler, you may need to use a flat head screwdriver or pry bar to pry them apart, be very careful not to damage the rubber coupler.

11. Once the driveshaft is separated from the coupler, fully remove the (2) nuts on the center bearing bracket, and then remove the OEM drive shaft from the vehicle.
12. Locate the Z1 Carbon Fiber Driveshaft and ?supplied hardware?.
13. Install the Z1 driveshaft onto the output shaft of the transmission (shown below).
14. Secure the rear of the driveshaft to the rubber coupler on the differential input flange (shown below). Torque the nuts and bolts evenly and in steps to 54ft-lbs.



15. Completed installation of the Z1 Carbon Fiber Driveshaft should look at shown below.



16. Repeat steps # 3-7 in reverse order to reinstall components previously removed.
17. Properly lower vehicle from jackstands.
18. Perform a final test drive of vehicle.

END

Additional Technical Support:
Contact Z1 Motorsports at info@z1motorsports.com
Or call 770-838-7777 between 9am and 6pm ET