

Z1 R35 GTR ALUMINUM UNDERSHROUD INSTALLATION MANUAL



This Installation Manual is intended for the following models:

2009+

Nissan GTR

PROLOGUE:

Study these instructions completely before proceeding to assembly. The installer must have a thorough knowledge of automotive systems operation. If unfamiliar with any of the concepts outlined in this instruction, we recommend the installation be completed by a qualified professional.

WARNING!

Extreme caution should be taken when performing maintenance or performance upgrades to your vehicle. Please observe and abide by any Warning or Caution labels placed on the various components and tools used when servicing your vehicle. If you have any questions regarding installation or the various components included with the Z1 Motorsports R35 GTR Aluminum Undershroud, consult with a Professional Mechanic or contact Z1 Motorsports for more information.

PARTS INCLUDED:

Item	Quantity	Description
1	1	Main Undershroud Panel
2	1	Service Panel
3	14	M6 x 20mm SEMS Screws

TOOLS REQUIRED:

- Hydraulic Jack
- (2) 2-Ton (or greater) Jack Stands
- Ratchet
- Ratchet Extension(s)
- 10mm Socket/Wrench

SAFETY REQUIREMENTS:

- Always wear safety glasses and any necessary protective garments. If using any fluids, chemicals, or solvents, a respirator is recommended.
- Always turn the ignition to the OFF position and disconnect the NEGATIVE battery terminal.
- Always use properly rated jack stands when working under your vehicle.
- Always keep limbs and parts away from moving drivetrain parts.
- Only operate drivetrain in safe space and well-ventilated areas.

BEFORE YOU BEGIN:

Remove contents from the Z1 Motorsports R35 GTR Aluminum Undershroud and verify that ALL necessary hardware is present.

PROCEDURE:

1. Place the transmission in Park position (or in Reverse gear if equipped with a manual transmission). Apply the parking brake.
2. Locate proper jacking points on vehicle's chassis (refer to vehicle's Owner Manual). Raise and support vehicle using jack & jack stands.

Refer to the diagram below for reference for the following steps:

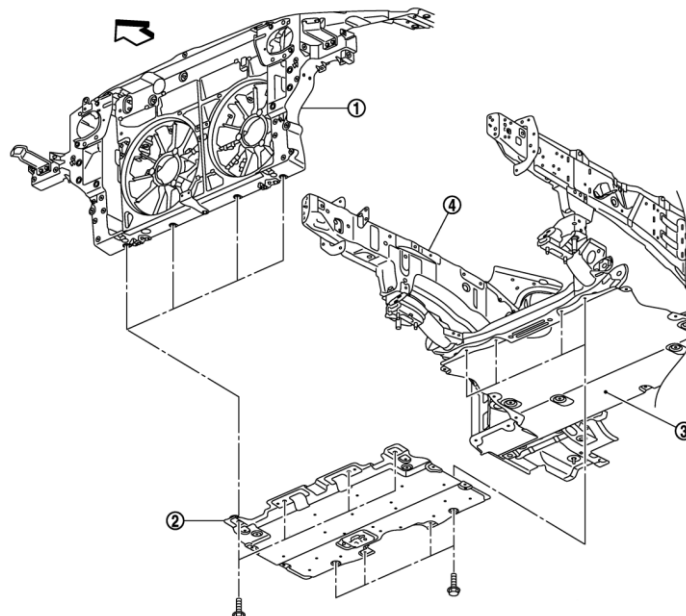

3. Remove the OEM engine undershroud by removing the (8) plastic pop-clips and (8) bolts securing it to the vehicle (circled below). Some of the bolts on the front edge of the undershroud may have plastic covers over them, remove them if they are present.

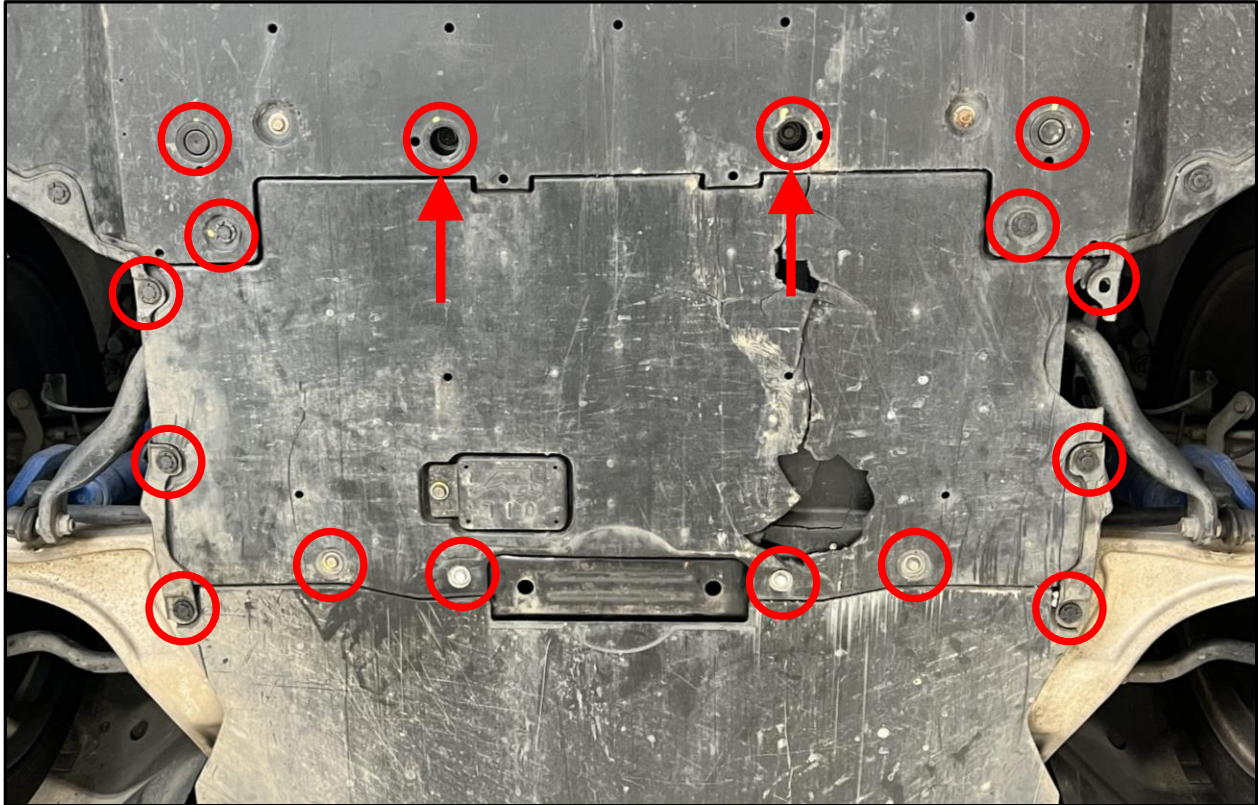

4. Install a supplied SEMS screw into the center 2 riv-nuts on the bottom of the radiator core support (as shown below). The riv-nut locations are shown in the image above with an arrow pointing to their them.



5. Locate the Z1 R35 GTR Undershroud main panel and (10) supplied SEMS screws.
6. The main panel has 2 slots on the front edge that will rest on the two screws installed in step # 4.

- Slide the panel onto the (2) screws installed in step # 4, then swing the panel up and secure the rear with (2) supplied SEMS screws. The image at the right shows the main panel slot and SEMS screw installed in step # 4 when looking through the access hole in the forward most underbody panel.
- Position the fender liners ends, that were removed with the plastic pop-clips in step # 3, under the undershroud and using (8) SEMS screw secure the rest of the main panel to the vehicle and tighten the first two bolts that were installed in step # 4.

Note: You can choose to position the fender liners above the undershroud panel if preferred. However, they will not be secured with the supplied screws, instead just resting above the undershroud.



- Locate the service panel and remaining (2) SEMS screws.
- Slot the service panel into the main panel with the lettering facing down. Then swing the panel up and secure with (2) SEMS screws.
- Completed installation of the Z1 R35 GTR Aluminum Undershroud should look as shown below:



- Inspect vehicle for loose tools/items.
- Properly lower vehicle from jack stands.
- Perform a final test drive of vehicle.

END

Additional Technical Support:
Contact Z1 Motorsports at info@z1motorsports.com
Or call 770-838-7777 between 9am and 6pm ET