

# Z1 2023+ NISSAN Z BAFFLED OIL CATCH CAN KIT INSTALLATION MANUAL



This Installation Manual is intended for the following models:

2023+	Nissan Z
-------	----------

## PROLOGUE:

Study these instructions completely before proceeding to assembly. The installer must have a thorough knowledge of automotive systems operation. If unfamiliar with any of the concepts outlined in this instruction, we recommend the installation be completed by a qualified professional.

## WARNING!

Extreme caution should be taken when performing maintenance or performance upgrades to your vehicle. Please observe and abide by any Warning or Caution labels placed on the various components and tools used when servicing your vehicle. If you have any questions regarding installation or the various components included with the Z1 Motorsports 2023+ Nissan Z Baffled Oil Catch Can Kit, consult with a Professional Mechanic or contact Z1 Motorsports for more information.

## **PARTS INCLUDED:**

Item	Quantity	Description
1	1	Z1 Assembled Catch Can
2	2	Banjo Fitting M18 Bolt to 3/8" Barb
3	2	Banjo Fitting M18 x 27mm Bolt
4	1	Catch Can Bracket
5	1	Catch Can Return Hose
6	1	Catch Can Feed Hose
7	4	Crush Washer
8	3	M4 Screw
9	4	Hose Clamp
10	1	M8 x 12mm Flange Bolt
11	1	2.5mm Ball-End Hex Screwdriver

## **TOOLS REQUIRED:**

- Hydraulic Jack
- (2) 2-Ton (or greater) Jack Stands
- Ratchet
- Ratchet Extension(s)
- Assorted Metric Sockets/Wrenches
- Torque Wrench
- Pliers
- 5mm Hex Key/Bit
- 8mm Hex Key/Bit

## **SAFETY REQUIREMENTS:**

- Always wear safety glasses and any necessary protective garments. If using any fluids, chemicals, or solvents, a respirator is recommended.
- Always turn the ignition to the OFF position and disconnect the NEGATIVE battery terminal.
- Always use properly rated jack stands when working under your vehicle.
- Always keep limbs and parts away from moving drivetrain parts.
- Only operate drivetrain in safe space and well-ventilated areas.

## **BEFORE YOU BEGIN:**

Remove contents from the Z1 Motorsports 2023+ Nissan Z Baffled Oil Catch Can Kit and verify that ALL necessary hardware is present.

## **PROCEDURE:**

1. Place the transmission in Park position (or in Reverse gear if equipped with a manual transmission). Apply the parking brake.
2. Unlatch hood of vehicle, apply hood prop.
3. Remove the (4) bolts securing driver side intercooler to vehicle.

4. Disconnect the two electrical connectors located on driver side intercooler (as shown below). Disconnect intercooler inlet pipe on bottom right corner of intercooler.
5. Loosen clamp at driver side throttle body. Rotate intercooler out of the way, towards the front of the vehicle (as shown below).

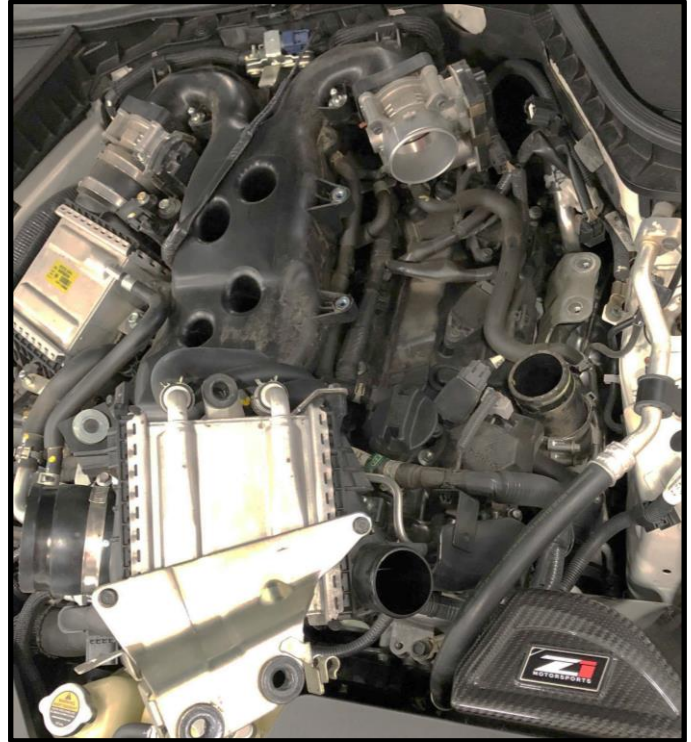
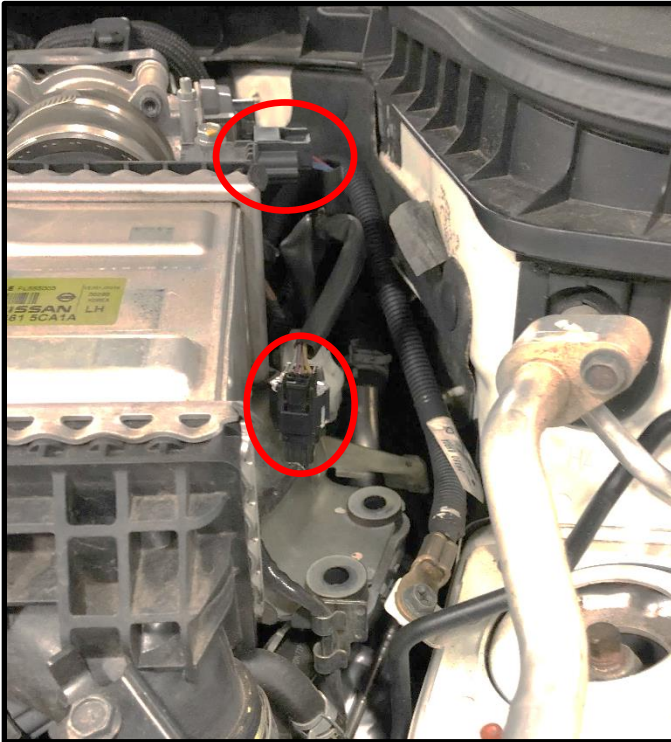

6. Disconnect factory PCV hose. It is attached at the front of the driver side valve cover (next to oil fill cap) and connects to the rear of the intake manifold (next to the driver side throttle body).

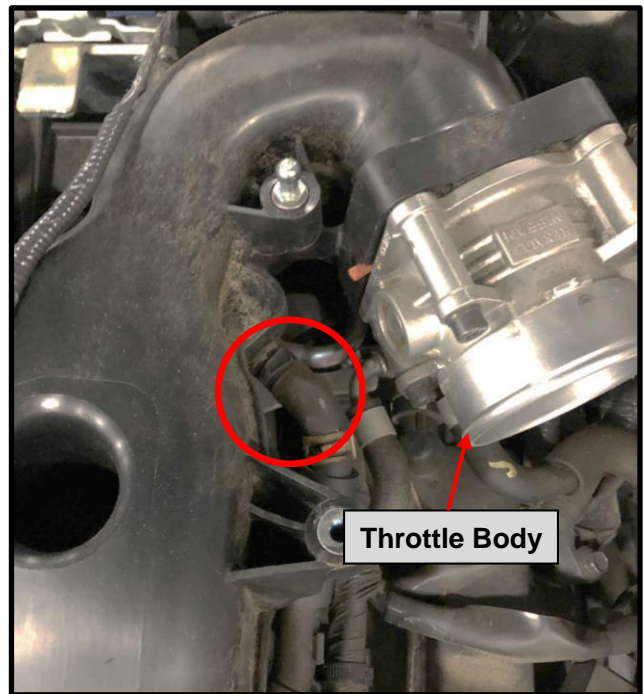
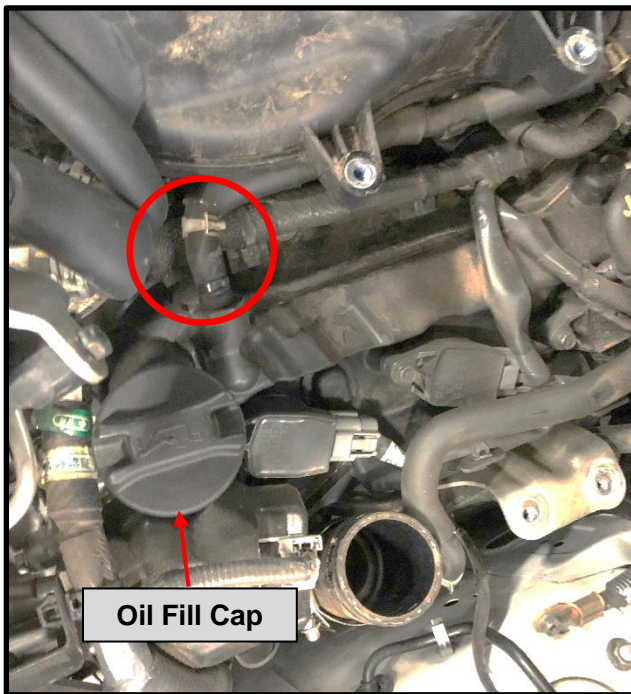



7. Locate new Z1 Catch Can Feed & Return hoses.

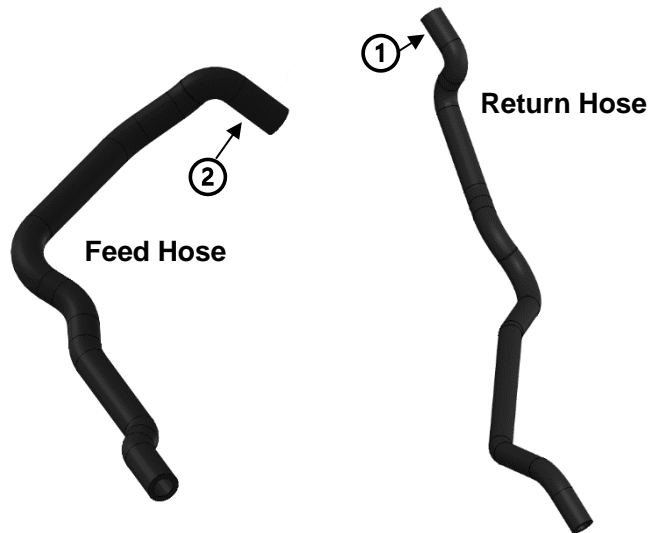

8. Attach the return hose end labeled ① to the port on the upper intake manifold next to the driver side throttle body where the OEM hose was removed in step # 6. Secure with hose clamp. Route the rest of the hose along the plastic intake plenum and under the other factory coolant hoses and towards the front of the car (shown below).
9. Attach the feed hose end labeled ② to the port on the driver side valve cover where the OEM hose was removed in step # 6. Secure with hose clamp. Route the rest of the hose under the other factory coolant hoses and towards the front of the car (shown below).

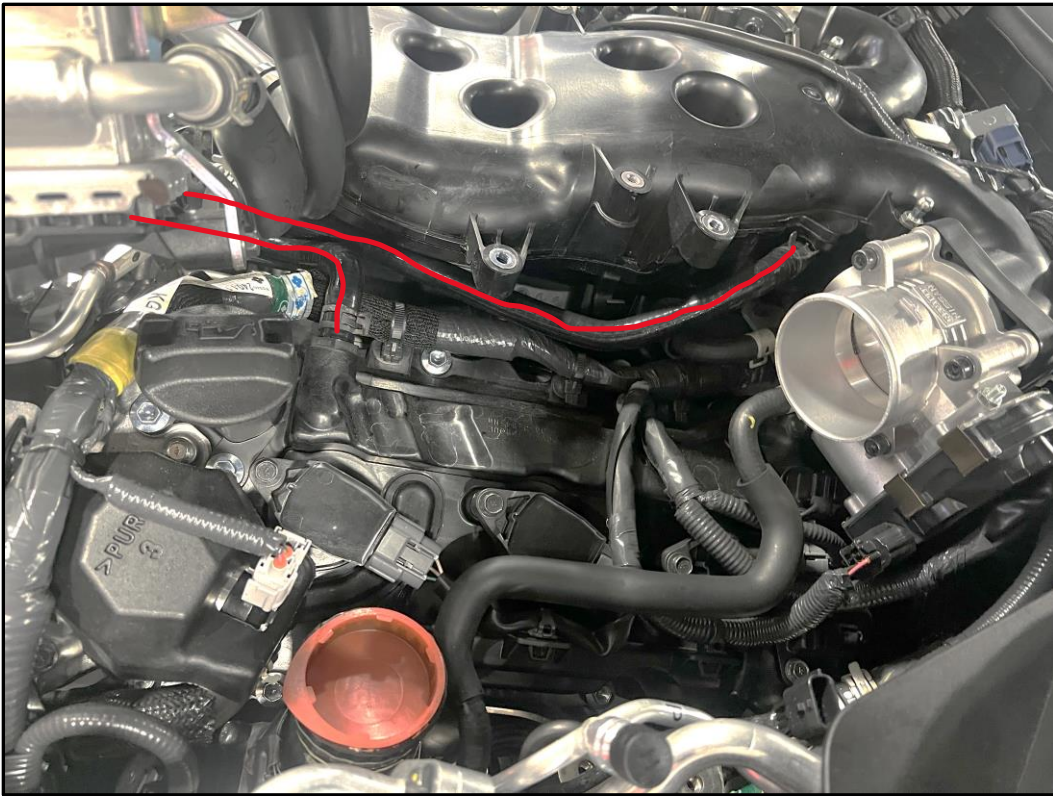

10. Locate Z1 Catch Can, catch can bracket, (3) M4 flat head socket cap screws, (2) banjo fitting barbs, (2) banjo fitting bolts, (4) crush washers, and the supplied 2.5mm hex screwdriver.

11. Using the supplied 2.5 hex screwdriver and (3) M4 flat head screws, attach the catch can bracket to the Z1 Catch Can in the same orientation as shown below.

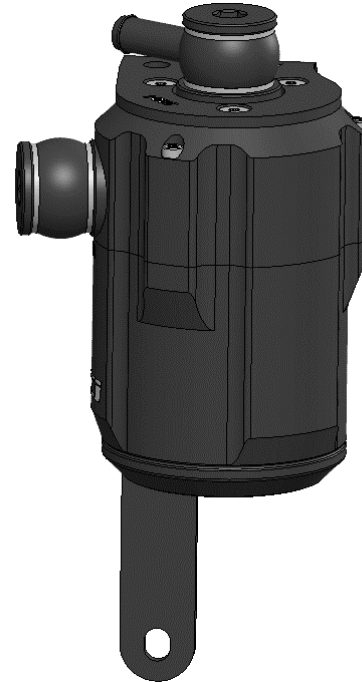
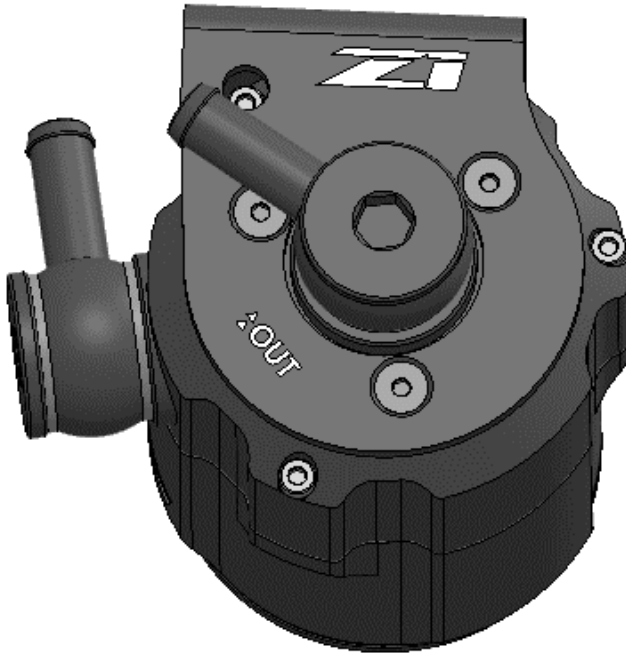

12. Once the bracket is attached, attach the banjo fittings to the catch can with a washer on both sides and the banjo fitting bolt.
13. Remove the bolt circled in the image at right that is on the front of the engine. The catch can bracket will use this mounting hole.
14. Attach catch can bracket to the front of the engine using the bolt and mounting hole from step # 13. Then using the (1) supplied flange bolt, secure the other mounting hole of the bracket to the threaded hole on the engine shown at right with an arrow.
15. Attach the return hose to the top banjo fitting barb (refer to picture at step #7). Secure with hose clamp.
16. Attach the feed hose to the front banjo fitting barb. Secure with hose clamp.
17. Using an 8mm hex wrench tighten both banjo fitting bolts.
18. Repeat steps #3 through #5 in reverse order to reattach driver side intercooler.
19. Assure all bolts and clamps are securely tightened. Inspect vehicle for loose components or issues.
20. Start vehicle, check for any leaks or faulty operation of Z1 Catch Can Kit.
21. Lower hood of vehicle.
22. Perform a final test drive of vehicle.

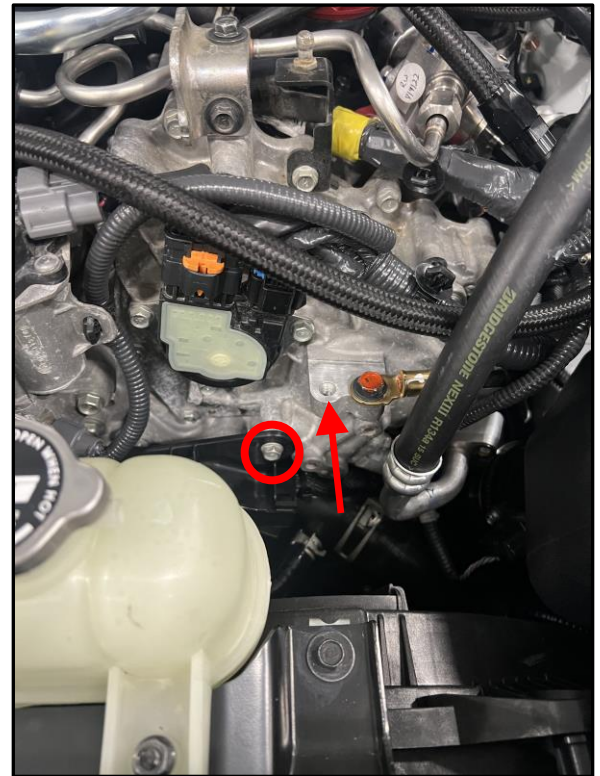



Completed Installation of the Z1 Nissan Z Catch Can Kit should look as shown below:

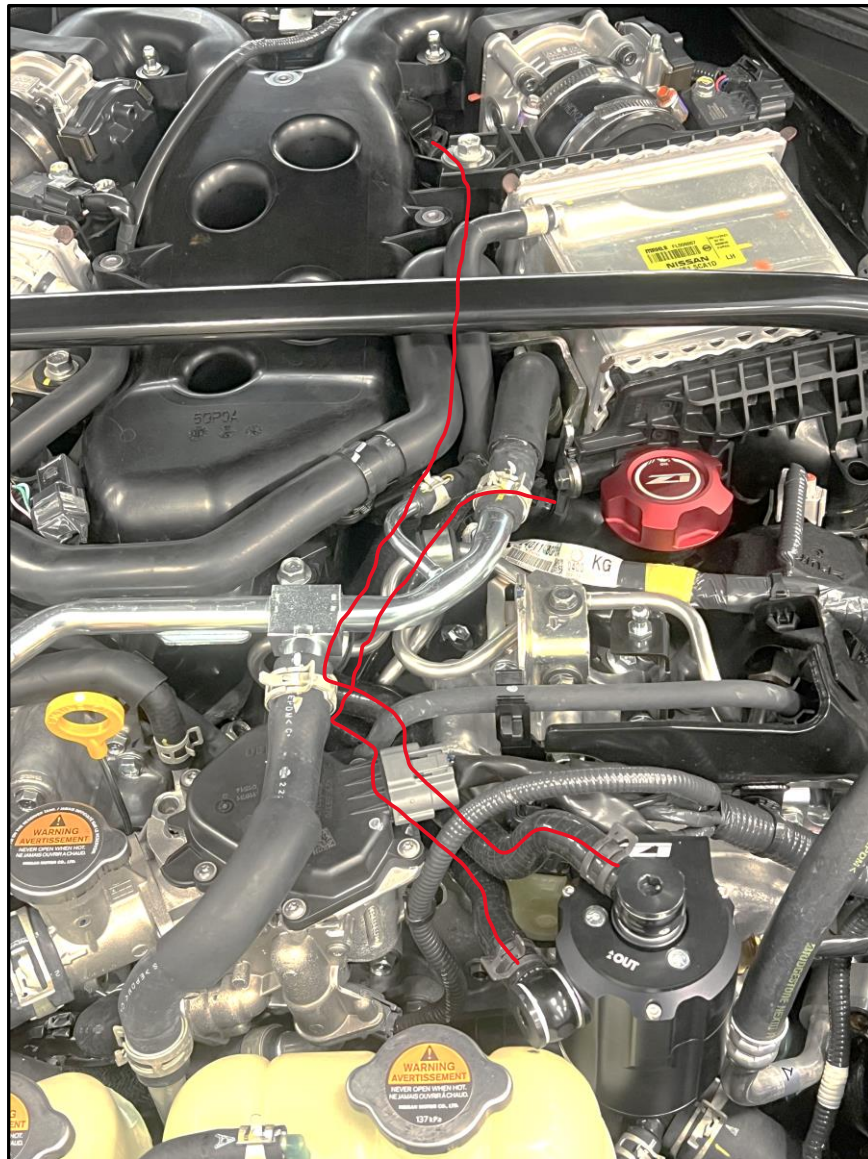

### **Drain Instructions**

1. While supporting the bottom of the catch can, use the supplied 2.5mm ball-end hex screwdriver to unscrew the 3 outer bolts on the top of the Z1 Oil Catch Can.
2. Remove the bottom of the Z1 Oil Catch Can. Properly dispose of oil.
3. Reattach bottom of catch can.

**END**

#### **Additional Technical Support:**

Contact Z1 Motorsports at [info@z1motorsports.com](mailto:info@z1motorsports.com)  
Or call 770-838-7777 between 9am and 6pm ET