



GENUINE PARTS

INSTALLATION INSTRUCTIONS

DESCRIPTION: Frontier Bedside Graphic

APPLICATION: Frontier

PART NUMBER: T99D1 9BU0A

KIT CONTENTS:

| Item | Qty. | Part Description | Service Part Number |
|------|------|--------------------------|---------------------|
| A | 1 | Frontier Bedside Graphic | T99D1 9BU0A |



A



B



C

TOOLS REQUIRED:

- 90% Isopropyl Alcohol
- Baby Shampoo
- 32 Ounce Spray Bottle
- Water
- Soft Lint Free Micro fiber Cloth
- Squeegee

PRE-INSTALLATION NOTES AND CAUTIONS:

- **Dealer Installation Recommended.** Installation requires an experienced graphics installer.
- This product should be install with the proper installation tools.
- After opening the kit, check all parts.
- Install this kit while observing all warnings and precautions stated in these instructions.
- **VERY IMPORTANT:** Begin with a thoroughly washed clean vehicle.
- Install in a non-dusty environment.
- Use tabs when handling film so no finger prints are left on adhesive.
- Vehicle body surface and graphics must be at a minimum of 70°F for proper installation, With clean lint-free cloth, wipe the paint surface with isopropyl alcohol (safe on paint) just prior to the application of the graphics. Wipe with a dry, lint-free cloth. Change cloths frequently to eliminate build up of contaminants.
- Position the graphic in the correct vehicle location. Do not smooth it down with your hands! Thoroughly squeegee the entire surface of the graphic with firm, overlapping squeegee strokes.
- **Application Solution:** Fill a 32 ounce spray bottle with water and add 1.5ml of baby shampoo. Do not use isopropyl alcohol to apply graphics.
- If the graphic tends to lift off of the vehicle while premask is being removed, the cause is:
 - 1) Too much detergent in the spray bottle. (Rinse it out and use less detergent.)
 - 2) Not enough pressure on the film surface from the squeegee. Increase the pressure and ensure overlapping squeegee strokes.
- Avoid washing vehicle for 3 days.

INSTALLATION PROCEDURE:

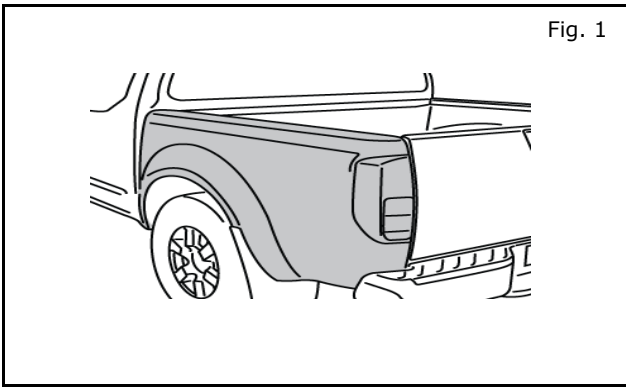

- 1) Using a clean lint free micro fiber cloth clean surface of LH bed side with 90% or greater isopropyl alcohol. Allow area to dry completely.

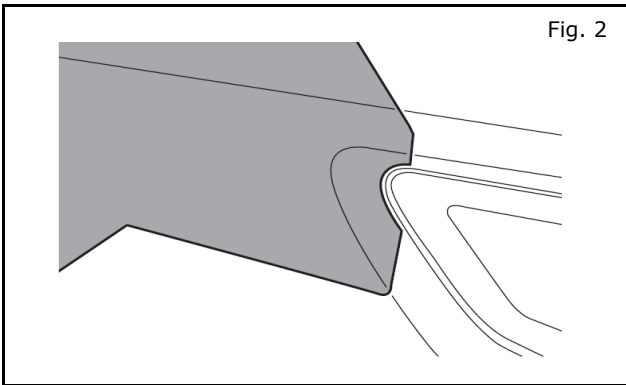

- 2) Align the dry graphic pre-mask to tail lamp opening (Fig 2), and then tangent of wheel opening feature. Make sure bottom edge of pre-mask aligns tangent along entire length of part (Fig 3).

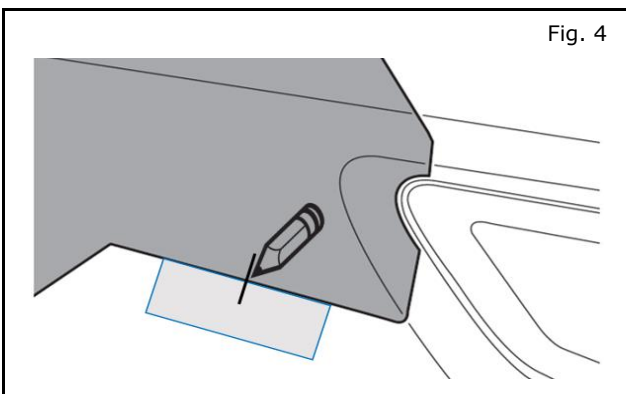
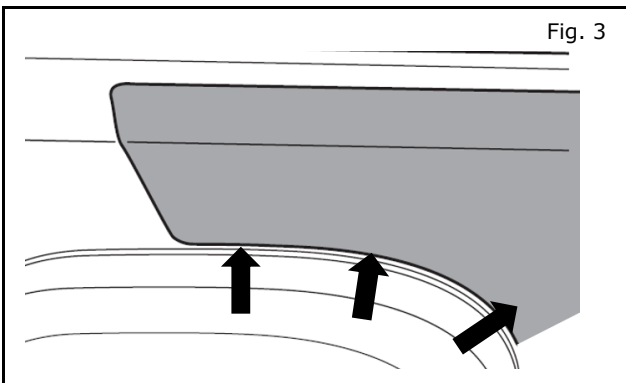

- 3) Add a piece of tape to the bedside to help re-locate the graphic in the up/down direction. Draw a line on the piece of tape bridging across to the graphic to help relocate the part in the fore/aft direction (Fig 4).

INSTALLATION PROCEDURE:

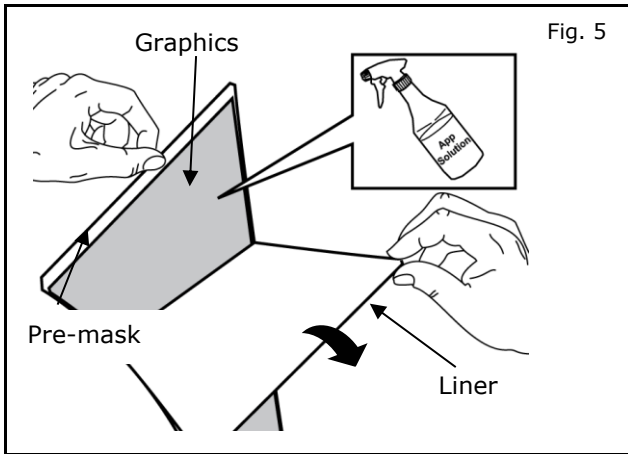

Fig. 5

- 4) Hold part by pre-mask and remove part liner.
- 5) Spray adhesive side with an even mist of application solution.

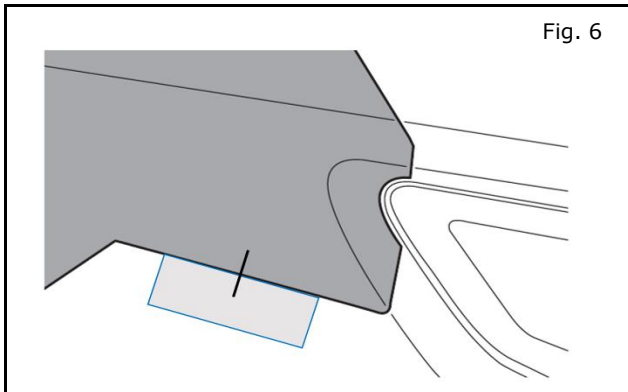

Fig. 6

- 6) Reposition the wet graphic pre-mask to the masking tape (Fig 6), and then tangent of wheel opening feature. Make sure bottom edge of pre-mask aligns tangent along entire length of part (Fig 7).

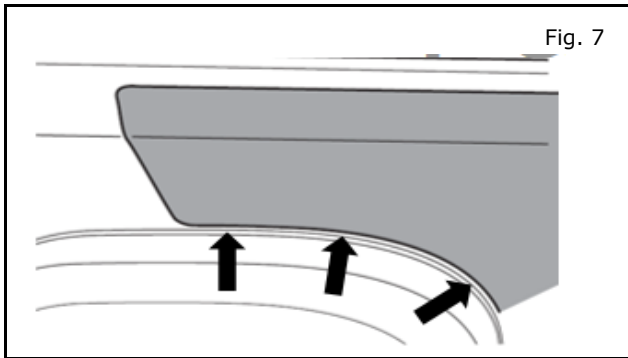

Fig. 7

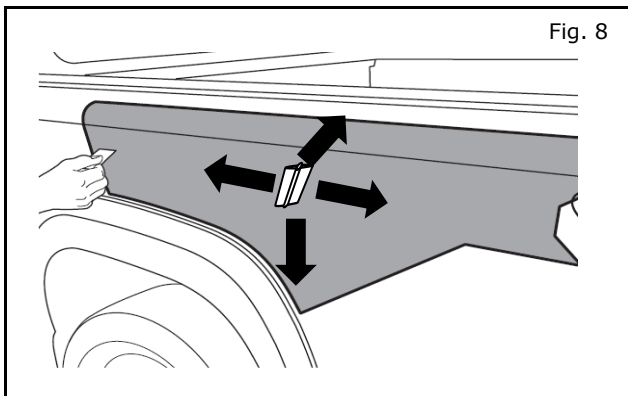
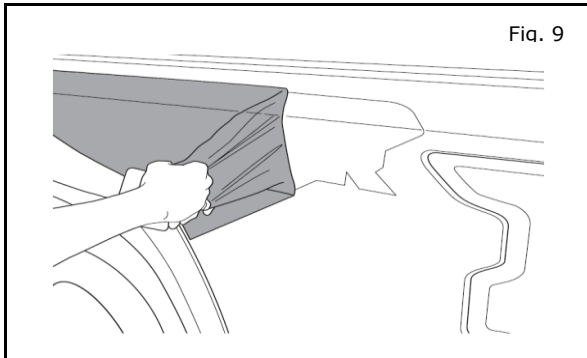

Fig. 8

- 7) Spray top of premask with installation fluid to aid in smooth squeegeeing. Beginning at the center of graphic, use squeegee to wet out graphic, working from the center out: first in a fore-aft direction, then in an up-down direction (Fig 5).
- 8) As you use squeegee, apply firm pressure and overlap strokes to help eliminate bubbles.

INSTALLATION PROCEDURE:



- 9) Carefully remove pre-mask from graphic (Fig 6).

NOTE:

Inspect for bubbles. If a bubble with application solution is located, re-squeegee using a firm, fast stroke. If the bubble persists, use a 3M air release tool to puncture the base of the bubble.

- 10) Repeat Steps 1 through 9 for RH side.