



GENUINE PARTS

INSTALLATION INSTRUCTIONS

DESCRIPTION: Door Edge Protector - Clear

APPLICATION: Frontier (Crew Cab & King Cab)

PART NUMBER: T99D7 9BU0A / T99D7 9BU1A

KIT CONTENTS:

Item	Qty.	Part Description	Service Part Number
A	5	Door Edge Protector - Front LH (Crew Cab & King Cab)	Available as Kit only/Kit PN# T99D7 9BU0A / T99D7 9BU1A
B	5	Door Edge Protector - Front RH (Crew Cab & King Cab)	
C	5	Door Edge Protector - Rear LH (Crew Cab)	
E	5	Door Edge Protector - Rear RH (Crew Cab)	
G	2	Felt Block	
H	1	Chizzler	999V2 AW000
I	1	Installation Instruction Website Address	

TOOLS REQUIRED:

- 90% or greater alcohol
- Scale (inches)
- Clean, lint-free wiping cloth

PRE-INSTALLATION WARNINGS, CAUTIONS, CRITICAL STEPS, and NOTES:

- An overview video is available online as additional aid to help with installation at following web address:
<https://www.youtube.com/watch?v=pdmj-zPFkVA&feature=youtu.be>
- Dealer installation recommended. Instructions may refer to Service Manual.
- Please read this instruction carefully before installing this product for correct installation.
- Please DO NOT use or install the part in ways other than what is described.
- Thoroughly wash vehicle with soap and water prior to installation.
- Take care not to scratch or damage any component during the removal or re-installation process.
- Do not install out doors, installation should be done indoors, and in clean environment with adequate lighting.
- Make sure your hands are clean and free from any contaminants that can transfer to adhesive.
- Use tabs when handling protective film so no fingerprints are left on adhesive.
- Vehicle body and protective film should be at 18°C to 32°C (65°F to 90°F) for optional installation.
- Avoid washing vehicle and exposure to moisture for 24 hours after protective film installation.
- If a problem occurs during installation, please contact Nissan dealer where you purchased the product.

INSTALLATION PROCEDURE:

NOTE:

It is highly recommended to watch install video online at following web address.

<https://www.youtube.com/watch?v=pdmj-zPFkvA&feature=youtu.be>

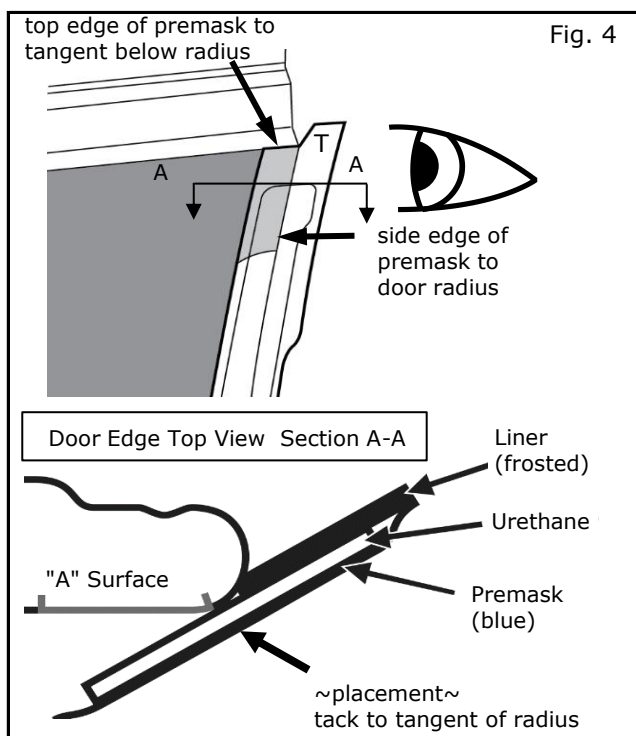
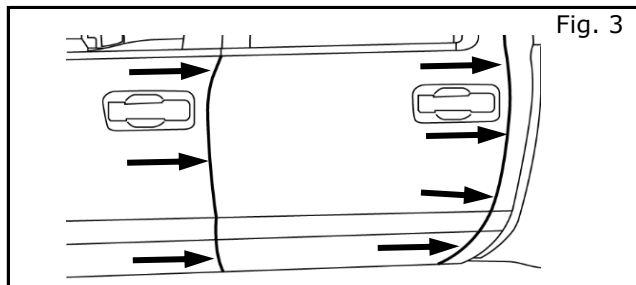
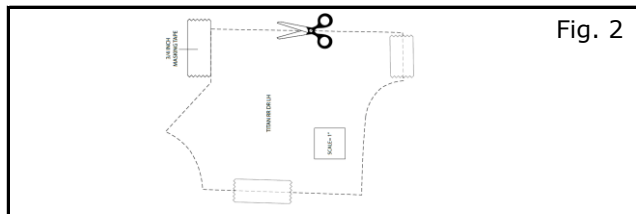
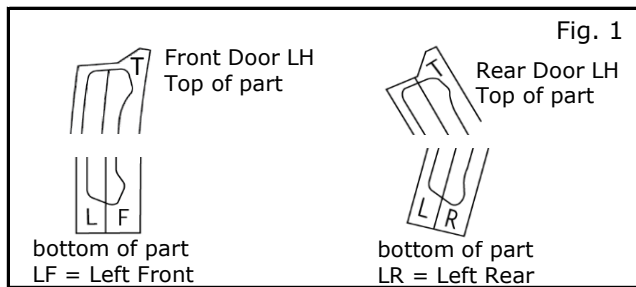

- 1) Review table shown in fig. 1 to identify where each part is to be installed on vehicle.

- 2) Cut out paper templates and use 1" scale to verify size is printed correct.

- 3) With alcohol and clean micro fiber cloth; clean inner and outer door edge surface where film is to be applied.

- 4) Roll down one half of back side of liner (frosted) that will adhere to door surface, exposing 6-8 inches of adhesive.

- 5) Align top edge of premask (blue) to tangent below radius on door and gently tack down exposed adhesive edge of remaining liner to edge of door radius as shown in section A-A.

NOTE:

Do not touch exposed adhesive.

- 6) Continue moving downward while gently tacking and aligning corner edge of film to radius of door while removing half of liner (frosted) in 6-8 inch increments.

NOTE: □

Do not apply firm pressure at this time.

INSTALLATION PROCEDURE:

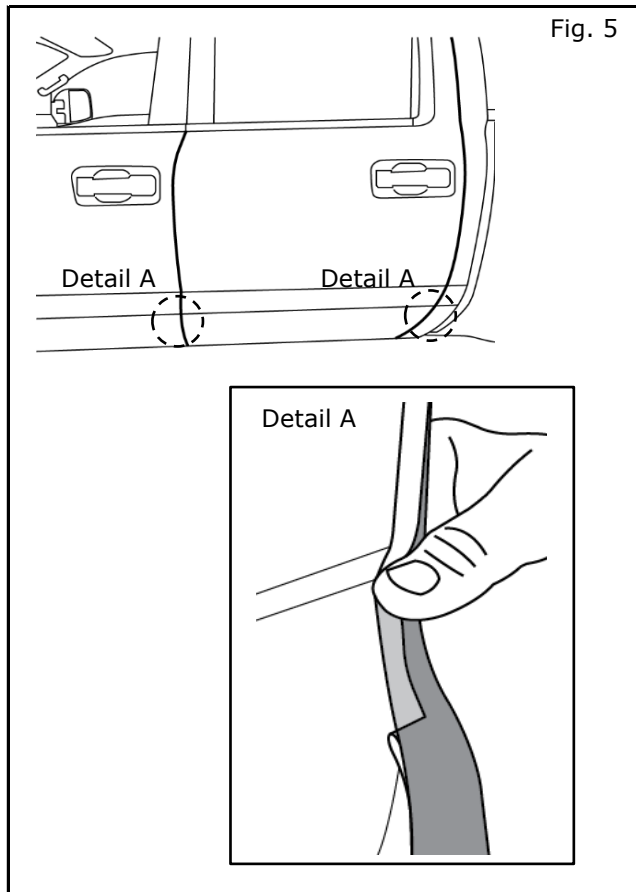

- 7) When you reach location near bottom of door where film is split be sure to push premask (blue) into curved surface so door edge guard is set in correct location.

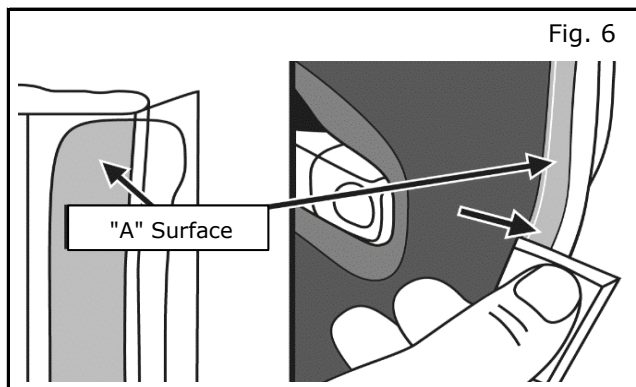

- 8) Starting from top use felt block (pointed beveled edge) at an angle and apply firm pressure on "A" surface to squeegee bubbles out.

NOTE: □

Do not use a shoveled motion.

NOTE: □

Do not move on if any air bubbles are present. Gently lift up film and reapply.

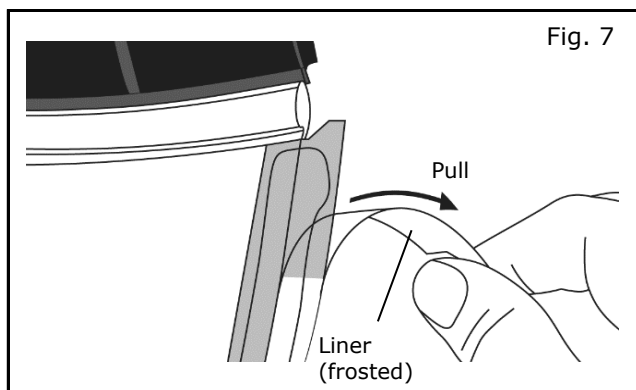

- 9) Starting from top and from back carefully remove other half of remaining liner strip (frosted) and discard.

INSTALLATION PROCEDURE:

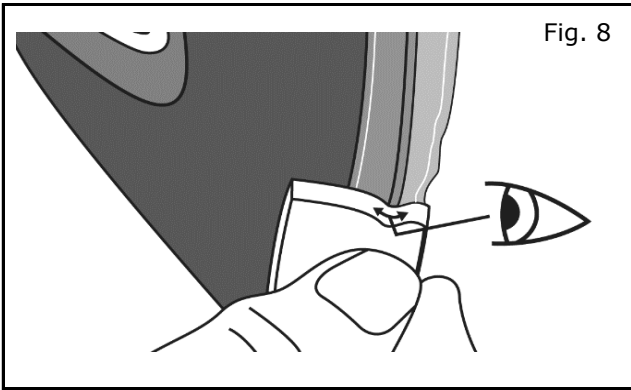

- 10) Use felt block to squeegee film with firm pressure approximately half way around door edge.

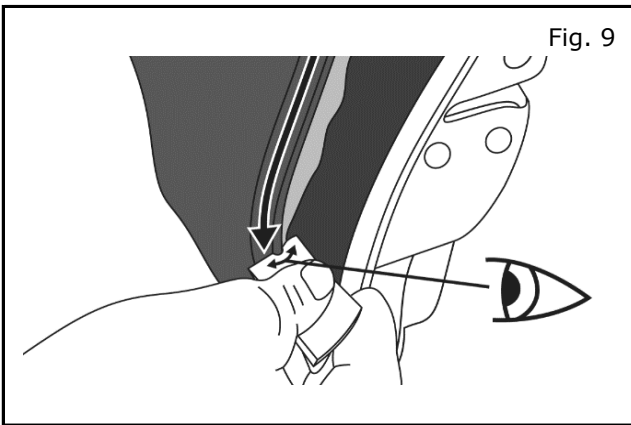

- 11) Use felt block to squeegee film with firm pressure around remaining radius of door edge.

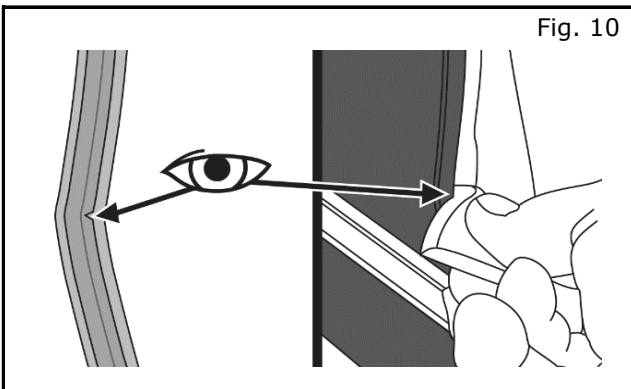

- 12) Using felt block complete wrap around "notched" corner features first.

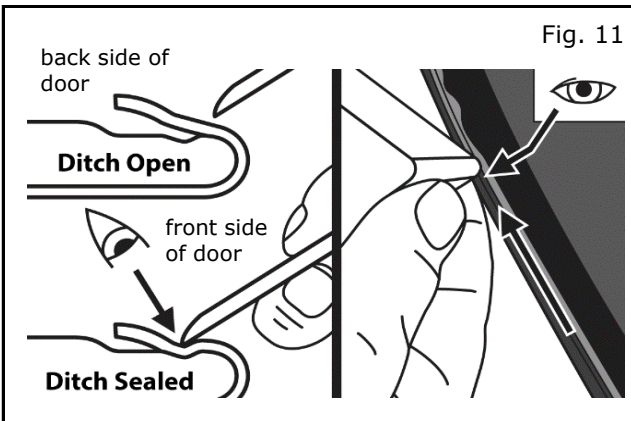

- 13) Use hard chisler tool and push film into back crease located at back side of door.

INSTALLATION PROCEDURE:

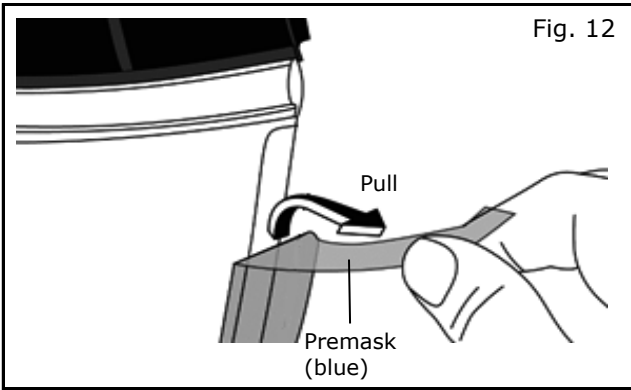

- 14) Carefully remove premask (blue) perpendicular to door edge and discard.

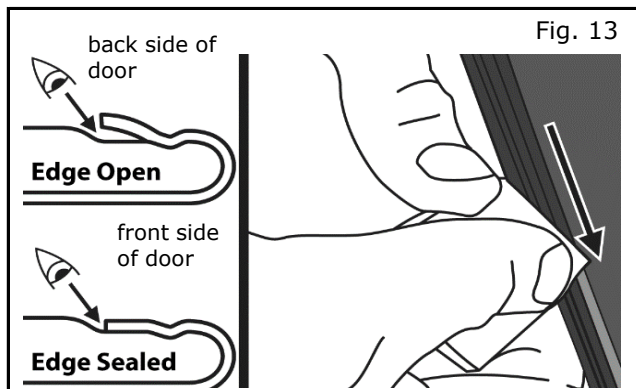

- 15) Repeat step 13 and use hard chisler tool to push film into back crease located at back side of door.
- 16) Use felt block and press smoothly to completely seal remaining film on backside of door edge.

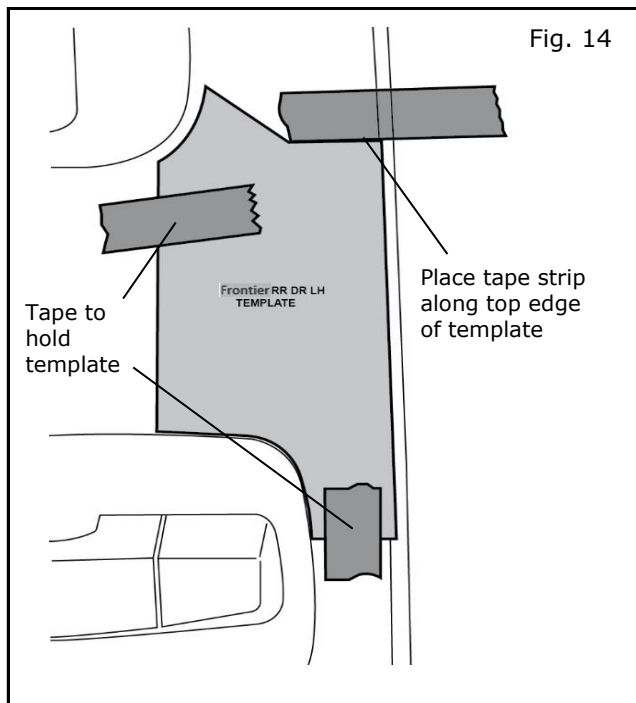

- 17) Proceed to step 18 if vehicle is crew cab. If vehicle is king cab then repeat steps 3-16 for RH side.
- 18) Align rear door template to vehicle edges and tape in marked locations (2) to hold in place. Ref. Fig. 14.
- 19) Place tape at top edge of template. This will mark top of door edge guard for alignment.
- 20) Remove template.

NOTE:

Do not discard. Template to be used for RH side.

INSTALLATION PROCEDURE:

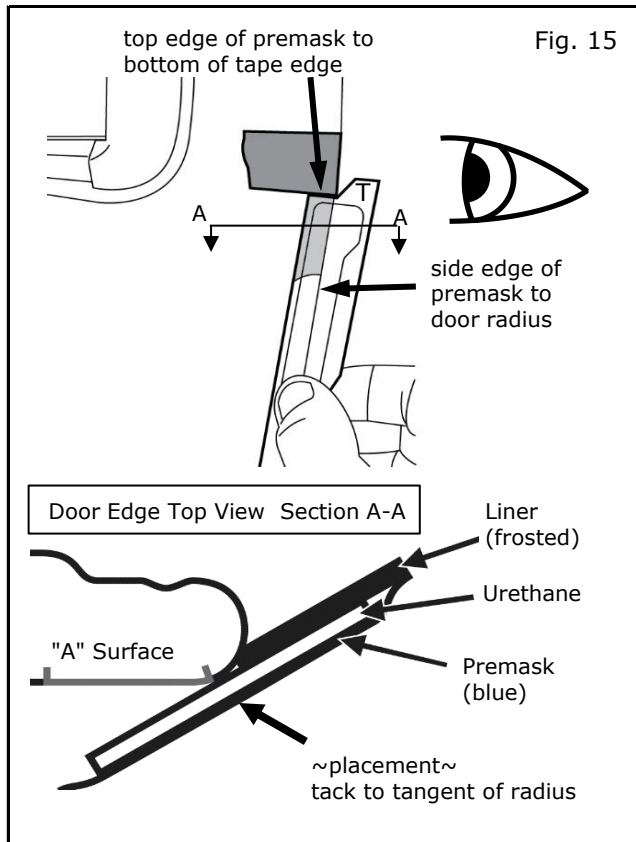

- 21) Roll down back side of liner exposing 6-8 inches of adhesive.
- 22) Align top edge of door edge guard below tape and side edge of remaining liner to edge of door as shown in section A-A.
- 23) Repeat steps 6 - 16.
- 24) Repeat for RH front door steps 3-16 and for RH rear door steps 18-23.

Appendix C - Location Template



CAUTION

Template **MUST** be printed to scale in both directions. Check printout by using scale below.

