



## Premium Short Throw Shifter



### Parts List

- ① Premium Short Throw Shifter
- ② Large Washer
- ③ Flat Washer
- ④ Spring Washer
- ⑤ Bolt/Nut Set (1 Bolt, 2 Nuts)
- ⑥ Nylock Nut

### Removal

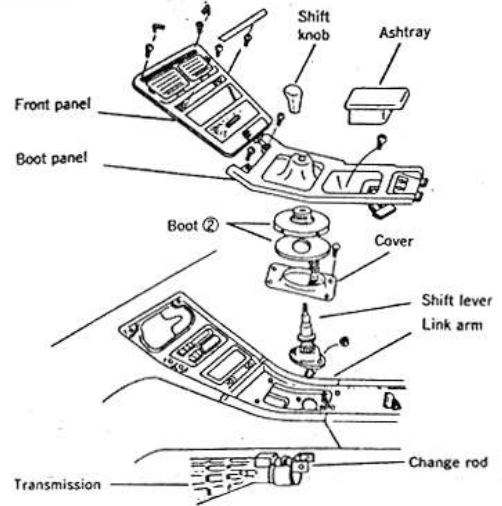

1. Remove the front panel, boot panel and shift knob.
  - Front panel : 4 screws and clock coupler
  - Boot panel : 3 screws and 2 couplers
2. Remove 2 boots and cover fitted to the shifter. (4 bolts and 1 nut)
3. Remove the change rod fitted under the shifter and remove the bolt and nut fitting the link arm and then remove the shifter.
4. Remove the cover, rubber boot and bushing from the shifter. When removing the collar, use a hammer.

### Installation

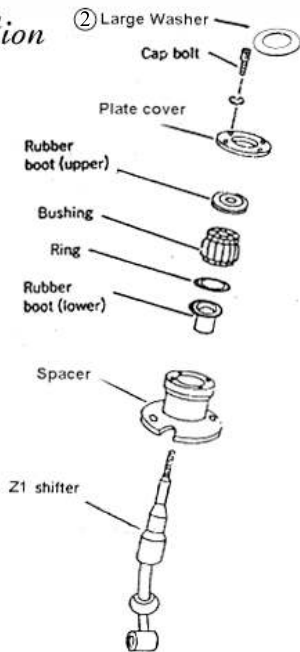

### Breakdown of Z1 Shifter

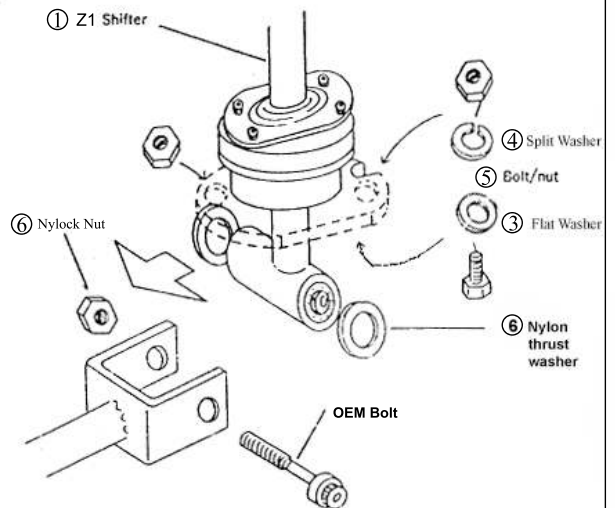

1. Install the Z1 shifter and shift link arm with OEM bolt and then install the change rod.
2. Apply silicone lube or other lube to the shifter boots and install the cover, boot and panel.

**Note:**  
Be sure not to over-tighten the shift knob when reinstalling.